

**Brunke, Ann EMPR:EX**

---

**From:** Bruhjell, Darren EMPR:EX  
**Sent:** 30-Apr-08 3:43 PM  
**To:** Seguin, Joe EMPR:EX  
**Subject:** FW: Placer mine, Churn Ck. Area

Don't know who you want to deal with this!

---

**From:** Grantham, Tom [mailto:Tom.Grantham@dfo-mpo.gc.ca]  
**Sent:** April 30, 2008 1:59 PM  
**To:** atgarbin@shaw.ca  
**Cc:** Lawrence, Don; Bruhjell, Darren EMPR:EX  
**Subject:** Placer mine, Churn Ck. Area

Just to let you know that I have received your two e-mails. I am forwarding over to the Habitat technician in Williams Lake and to Ministry of Mines.

I am including Mr. Lawrence's contact # (250-305-4017) should you wish to talk directly to him as your file will be dealt with from the Williams Lake DFO office.

Tom Grantham  
Detachment Supervisor  
Conservation and Protection  
Lillooet Detachment  
250-256-2665

**Brunke, Ann EMPR:EX**

**From:** Bruhjell, Darren EMPR:EX  
**Sent:** 30-Apr-08 3:43 PM  
**To:** Seguin, Joe EMPR:EX  
**Subject:** FW: Garbin-Mining-Plan email # 1 Thanks

---

**From:** Grantham, Tom [mailto:Tom.Grantham@dfo-mpo.gc.ca]  
**Sent:** April 30, 2008 2:00 PM  
**To:** Lawrence, Don  
**Cc:** atgarbin@shaw.ca; Bruhjell, Darren EMPR:EX  
**Subject:** FW: Garbin-Mining-Plan email # 1 Thanks

Don, more information on the placer mine proposal.

Tom Grantham  
Detachment Supervisor  
Conservation and Protection  
Lillooet Detachment  
250-256-2665

-----Original Message-----

**From:** teresa Garbin [mailto:atgarbin@shaw.ca]  
**Sent:** April 30, 2008 11:05 AM  
**To:** Grantham, Tom  
**Subject:** Garbin-Mining-Plan email # 1 Thanks

**Mining Plan Application for Alessandro Garbin.**

This work permit will apply to the following claims that have been converted to a LPM 399058,399059, 315276. It has been approved and advertised and as of April 20, 2008, we haven't received the final papers.

**History**

This area is located on a bench above the Fraser River south of the Churn Creek Bridge and on the east side. The main proposed work area is an area that was superficially worked by the Chinese in the late 1800's or early 1900's. There is significant amount of large rocks showing with little or no overburden or soil.

A work permit was given in the 80's, and a small area was worked to test viability of a larger operation.

**Development**

The Road access to the claim is existing.  
The camp area is flat and needs no development.  
The initial mining area will not have to have overburden stripped.

We will need to build a 3 meter trail to the river for the water pipe access.

The bluffs above the river are quite steep, but has significant rock composition

We feel that by using two excavators, we can build a trail from the top, moving the material up the hill and stockpiling it. This will prevent any rock or debris from falling into the river basin. We will use 6" steel pipe and bury it from the pump at river level, to the first bench. By burying the pipe, we can insure that it is stable to prevent any mishap with the water pumping. We will ditch the trail so that any runoff will not cause erosion of the trail.

01/05/2008



We will build three ponds, two for storage, and one as overflow protection.

The pond sizes will be 15m x 15m x 2m, roughly 400 cu meters. One will be built on the uppermost bench, allowing gravity feed to the trommel. The other two will be below the trommel as catch basins. The 6" pump will charge the holding pond and then be turned off. Gravity will charge the high pressure pump at the trommel, and the water will collect in the pond below the trommel. There will be a 3" pump to cycle the water back to the holding pond. In the tests previously, we found that there is significant fine clay which seals the ponds against leakage.

With the previous test, we will probably only have to fill the holding pond once a week depending on evaporation.

We would want to dig up to 15 test holes, 2m x 2m x 2m, taking a sample, and reclaiming right away. Some test holes will be in the work area, but some we want to dig on the south side of the Garbin Gulch.

We feel it will be prudent to install a cable gate leading into the work area which will also allow the proper signage for safety.

There is an area with a spring that we would like to develop into a holding area for drinking water only.

## **Plan**

This mining plan is fairly straight forward, the material to be worked will be piled with the excavator, and moved with the crawler to the trommel working area.

Once the initial material is worked, it will be stockpiled on the opposite side of the trommel. We plan to stockpile worked material for 5-10 working days, and then move the material back into the hole. This will be an ongoing reclamation project, except for the covering of soil and the seeding. As we work closer to the higher bench, we will have significant overburden to remove, and we feel that this material will work well to cover the worked area allowing seeding and complete reclamation. The working area will be 75m + from the banks edge protecting against any accident. We would hope to work 4-5 days per week, 20 days a month, and for six months, working 300-400 cu. meters/day.

The water will be recycled between the holding pond and the catch pond. We will only have to pump water to fill up the holding pond on a weekly basis.

## **Fuel Storage**

In the initial stage, we will have a flat deck truck with a fuel tank for fueling the machines. If this proves to be too slow, we will bring in a double lined fuel tank for the diesel.

## **Refuse**

All refuse and garbage will be hauled back to the landfill in 100-Mile.

## **Reclamation**

As stated earlier, we plan on refilling the working holes with washed material as we go. Once a significant area is backfilled and leveled, we will be able to transfer topsoil (from our overburden) over the washed gravel and will be able to seed with range grass.

## **Safety**

Satellite Phone will be on site along with the Spot Messenger to request help

There will be two people on site when processing.

We will have adequate fire tools, fire extinguishers, and spill kits.

**Brunke, Ann EMPR:EX**

**From:** Bruhjell, Darren EMPR:EX  
**Sent:** 30-Apr-08 3:44 PM  
**To:** Seguin, Joe EMPR:EX  
**Subject:** FW: GARBIN-OPERATONAL.pdf email #2  
**Attachments:** GARBIN-OPERATONAL.pdf

---

**From:** Grantham, Tom [mailto:Tom.Grantham@dfo-mpo.gc.ca]  
**Sent:** April 30, 2008 2:02 PM  
**To:** Lawrence, Don  
**Cc:** atgarbine@shaw.ca; Bruhjell, Darren EMPR:EX  
**Subject:** FW: GARBIN-OPERATONAL.pdf email #2

Don, This just in today, and believe it is in your area of expertise, and your area of coverage.

---

Tom Grantham  
Detachment Supervisor  
Conservation and Protection  
Lillooet Detachment  
250-256-2665

-----Original Message-----

**From:** teresa Garbin [mailto:atgarbin@shaw.ca]  
**Sent:** April 30, 2008 11:27 AM  
**To:** Grantham, Tom  
**Subject:** GARBIN-OPERATONAL.pdf email #2

Dear Mr. Grantham, look over and let me know.  
Thanks, Teresa



**Hupman, C Bruce EMPR:EX**

---

**From:** Warren Koster s.22  
**Sent:** July 21, 2008 10:52 AM  
**To:** Hupman, C Bruce EMPR:EX  
**Subject:** RE: Garbin Placer Access

Hello Bruce, In answer to your query about a letter of consent for access to the Garbin Placer claim. As you may or may not be aware we had trouble with the last mining activity on this claim. I have made arrangements to meet with our lawyer in Kamloops[ to make a contract that will hopefully address our concerns. This is scheduled to take place on the 1st of August so I don't see that I will have this done before the end of July. On our site visit with Mr Garbin and his professional their were some areas raised that I am concerned about. I hope that you will see fit to not give approval before an agreement is in place along with an appropriate performance bond. I did agree to have Mr Garbin inform us by telephone when he wished to travel to the claim(with out machinery). We have several very real concerns one being adequate insurance for the possibility of a forest fire escapement and the issue of the introduction of invasive plants.

Warren Koster

---

**Subject:** Garbin Placer Access  
**Date:** Fri, 18 Jul 2008 14:52:19 -0700  
**From:** Bruce.Hupman@gov.bc.ca  
**To:** s.22  
**CC:** atgarbin@shaw.ca

Hello Warren

As the contact for the BC Cattle Company, I am contacting you in regards to obtaining a letter of consent to access placer claims 8773 and 9097 held by Alessandro Garbin. My understanding is that you have recently met with the Garbins on site to review their plan. Did you come to agreement and was there any commitments regarding the works that I should be aware of? As the permitting process has begun, could you provide your consent (and commitment) letter before the end of July?

Bruce Hupman PAg  
Inspector of Mines  
Mining and Minerals Division  
South Central Region  
(250) 371-6067

---

Hupman, C Bruce EMPR:EX

**From:** teresa Garbin [atgarbin@shaw.ca]  
**Sent:** May 28, 2008 11:01 AM  
**To:** Hupman, C Bruce EMPR:EX  
**Subject:** Garbin-application give to Mr. Koster on May 25/08  
**Attachments:** header.htm; image004.wmz; oledata.mso



## Ministry of Energy, Mines and Petroleum Resources

L

### INFORMATION REGARDING THE COMPLETION OF THE NOTICE OF WORK AND RECLAMATION PROGRAM PLACER OPERATIONS

The information on this form and any supporting documents are subject to the *Freedom of Information and Protection of Privacy Act*. The information requested on this form is collected and used for the purpose of administering the *Mines Act* of British Columbia and the *Health, Safety and Reclamation Code for Mines in British Columbia*. The *Mines Act* authorises the collection of the requested information on this form. The completed form is routinely available to the public. Questions about how the *Freedom of Information and Protection of Privacy Act* applies to the information collected on this form can be directed to the Office of the Information and Privacy Commissioner—phone: (250) 387-5629; fax: (250) 387-1696; mailing address: PO Box 9038 Stn. Prov. Govt. Victoria, British Columbia, V8W 9A4

Please fill out this form in **black ink**, either **typed** or **printed**.

This form represents an application to the **Ministry of Energy, Mines and Petroleum Resources**. Applications may be referred to the Ministry of Environment for determination of licensing requirements under the *Water Act*. If fees are required under the *Water Act*, it will be necessary for you to submit to this office a cheque or money order payable to the Minister of Finance for the required amount.

This form is to be used by any company or individual planning to conduct exploration or other work on a placer property. Keep one copy. Forward six copies to the Inspector of Mines. Written approval must be obtained prior to commencement of mechanical work.

This form must be completed in full, signed, and submitted to the Inspector of Mines. Approvals may take up to 60 days, so the operator is encouraged to apply early.

Any work below the high water level, or diversion of a watercourse, requires an additional approval from the Ministry of Environment.

Waste Management Branch approvals are not required for operators who recycle their effluents or discharge to the ground. Operators who discharge to a watercourse, either directly or indirectly, require a Waste Management Branch approval or permit.

All tree cutting requires the issuance of cutting authority from the District Manager of the Ministry of Forests and Range.

Buildings will only be permitted if they are required for the mining operation and may be constructed only following written approval. At the completion of the mining operations, all buildings, including dwellings, are to be completely removed from the site. Contact the District Inspector for details.

An application for erection of a gate or any barrier on road access to the property must be submitted and approved by the Inspector prior to construction.

Notices of Work that are faxed to the appropriate Mining Regional Office will be accepted. Please forward six copies by mail.

2008-06-18

**Contact information for Regional Offices is located at the following web address:**  
[http://www.em.gov.bc.ca/Subwebs/mining/Regional\\_Offices/](http://www.em.gov.bc.ca/Subwebs/mining/Regional_Offices/)



The information on this form and any supporting documents are subject to the *Freedom of Information and Protection of Privacy Act*. The information requested on this form is collected and used for the purpose of administering the *Mines Act* of British Columbia and the *Health, Safety and Reclamation Code for Mines in British Columbia*. The *Mines Act* authorises the collection of the requested information on this form. The completed form is routinely available to the public. Questions about how the *Freedom of Information and Protection of Privacy Act* applies to the information collected on this form can be directed to the Office of the Information and Privacy Commissioner—phone: (250) 387-5629; fax: (250) 387-1696; mailing address: PO Box 9038 Stn. Prov. Govt. Victoria, British Columbia, V8W 9A4

Hand Operation: Yes No

If yes, complete items 1-6, 8-10, 12-15 only & applicable maps from 18

# 1. PLACER PROPERTY

LEASE #: LPM Applied for and approved(not received yet)

EXPIRY DATES:.....

CLAIM #: 399058,399059, 315276

EXPIRY DATES:399058-59 Dec 29,08

315276 Dec 16, 2008

Previous Annual Work Approval Number (e.g. PRG1999-0100500-123): P-3-118

Reclamation Permit Number, if previously issued (may be several years old):.....

DURATION OF WORK: From: Spring 2008 To: Oct 31, 2011

# 2. LOCATION

Are surface rights to any part of this property privately owned? (Operator responsible for contacting Owner) Yes No

Name and address of private land owner: BC Cattle Company Ltd, Warren Koster

Mining division: Clinton All NTS map sheets (e.g. 093G/02E):9208W, 9209W.....

Latitude 51.° 59' 38.7"

Longitude 122° 16' 37.5"

# 3. ACCESS

Describe access route to property from nearest town (give exact distances in kms, including secondary roads):

Proceed south of 100 Mile House approx 56 Kms to the junction of Hwy 97 and Meadow Lake Road. Turn Right and go approx 45 Km to the

Junction of Meadow Lake Rd and the Dog Creek Canoe Creek Rd. Continue on the Dog Creek Rd approx 30 Kms and turn left onto a 1 lane dirt track. Proceed toward river approx 800 meters to junction, and turn right. Work area is approx 300 meters farther.

Access is (please check): Existing To Be Constructed Both.

Indicate type of existing access: All season road Four wheel drive ATV. Is there an alternative access route to the property? (explain):

# 4. OPERATOR/AGENT (Person or Company controlling property on behalf of the owner):

Name: Alessandro Garbin

Telephone No: 250-791-5294 Fax No: 250-791-5290

Company contact person: Alessandro Garbin

Address: Box 433

City: 108 Mile Ranch

Province: B.C,

Postal Code: V0K 2Z0

E-mail Address: [atgargin@shaw.ca](mailto:atgargin@shaw.ca)

Signature of Operator/Agent:.....Date:.....

# 5. OWNER (Title Holder):

Name Alessandro Garbin

Telephone No: 250-791-5294

Fax No:250-791-5290

Address: PO Box 433

City: 108 Mile Ranch

Province B.C. Postal Code: V0K 2Z0 Signature of Owner: .....

(or submit a signed letter of authorization from owner)

Date:.....

# 6. MANAGER (Person responsible for management and operation of property)

Name: See Above

Telephone No: 250-791-5294 Fax No: 250-791-5290

To whom is correspondence sent regarding this notice?

Agent

Owner

Operator

**7. EXPLORATION WORK** (brief description, attach additional sheets if necessary):

Blasting:..... Geophysical (list type):..... Other:.....

Grid and Line development (distance, width, method):.....

**8. TIMBER:** Will merchantable timber be cut during this project? **YES** **NO**

Merchantable timber type: none Non-merchantable timber type: none

Area to be Cleared:.....m<sup>2</sup> Volume of Merch:..... m<sup>3</sup> Volume of Non-merch:..... m<sup>3</sup>

Will timber be used on site? Yes No If no, indicate method of disposal below:

Bucked and scattered Decked for other timber tenure holders As directed by cutting authorisation

**9. WATER SUPPLY** (subject to approval under the *Water Act*): Stream name: Fraser River

Describe the source of water supply: Fraser River Draining to Holding pond

Pump size in water course 6".inches Quantity of water to be used:.....c.f.s. or . 15,000 gal/day

Pump size in settling pond 3.inches Location of water intake (show on plan): High water on Fraser River

Are you proposing changes in or about a stream (bridges, culverts, pipelines, dams, stream diversions, etc.)? Yes No

If yes, explain in the space provided below and attach a map (1:20,000 scale) showing the location of all proposed changes.

.....

.....

**10. WASTE WATER TREATMENT** (subject to approval under the *Waste Management Act*):

Describe the waste water treatment facility (settling pond design, recycling, distance from creek, etc.) .....

This operation will use a 15m X 15m X 2m deep settling pond for the water coming from the Trommel. It will then be recycled by a pump into the holding pond. The settling pond will be approximately 75 m from the drop off edge into the Fraser River basin.

Is your operation planned for **zero discharge** (zero discharge means no water is released back into a stream either through a pipe, an overflow, by pumping, or by visible seepage through an impoundment): **YES** **NO** If no, please describe:

.....

.....

**11. EQUIPMENT LIST** (Note: all equipment to comply with the Health, Safety and Reclamation Code):

Number and Type	Size/Capacity
a) Link Belt 200	1 yard bucket.
b) J.D. 590 excavator	¾ yard bucket
c) TD15 International Crawler	.....
d) Dump Truck	.....
e) Processing plant trammel	.....
f) TD25 International Crawler	.....

**12. FIRST AID FACILITIES** (Must comply with W.C.B. regulations):

Describe methods of communication on site: Satellite phone, Spot Messenger

Location of nearest hospital 100 Mile House Travel time to hospital (surface): 2:30 hrs

Number of persons on site (including contractors): 2-3 people Type of transportation available: 4-wd Jeep

First aid equipment on site: Level 1 kit

First aid certificate level(s): Level 1 Expiry Date: To be renewed this year

Holder of Supervisor Certificate: ..... Expiry Date:.....

**13. SURFACE DISTURBANCE OFF PLACER LEASES OR CLAIMS:** Yes No (if no proceed to section 14)

Campsite:	Length:.....m	Width:.....m	Area:.....m <sup>2</sup>
Access construction:	Total length:.....m	Width:.....m	Area:.....m <sup>2</sup>



Other (specify): .....

14. EXISTING SURFACE DISTURBANCE ON PLACER LEASES OR CLAIMS:						
(includes spoil piles, travelled areas, side casts)						
						(Length × Width = Area)
(a)	Settling Ponds:	No. 2	Length: 10.m	Width: 10m	Area:	100.m <sup>2</sup>
(b)	Mining areas:	No. 1	Length: 20.m	Width: 20m	Area:	400m <sup>2</sup>
(c)	Coarse tailings piles-		Length: 20.m	Width: 20m	Area:.	400m <sup>2</sup>
(d)	Existing Access:		Length:.....m	Width:.....m	Area:.....	m <sup>2</sup>
						(# × Length × Width =Area)
(e)	Trenching:	# of trenches:.....	Depth:.....	Length:..... m	Width:.....m	Area:..... m <sup>2</sup>
(f)	Test pits:	# of pits:10	Depth: 3m	Length: 2 m	Width: 2m	Area 40.m <sup>2</sup>
(g)	Campsite:		Length:.....m	Width:.....m	Area:.	.....m <sup>2</sup>
(h)	Other: Describe .....				Area:.....	m <sup>2</sup>
<b>TOTAL EXISTING SURFACE DISTURBANCE ON CLAIM [add lines (a) through (h)]</b>						
						940m <sup>2</sup>

15. PROPOSED SURFACE DISTURBANCE ON PLACER LEASES OR CLAIMS:						
(includes spoil piles, travelled areas, side casts)						
						(Length × Width = Area)
(a)	Wash plants:	No. 1	Length: 10.m	Width: 10m	Area:.	100m <sup>2</sup>
(b)	Settling Ponds:	No. 3	Length 15m	Width: 15m	Area:	675.m <sup>2</sup>
(c)	Mining areas:		Length: 160.m	Width: 75m	Area:.	12000m <sup>2</sup>
(d)	Coarse tailings piles:		Length: 25 m	Width: 25 m	Area:.	625m <sup>2</sup>
(e)	Access construction:		Length: 100.m	Width; 3m	Area:.	300.m <sup>2</sup>
						(# × Length × Width = Area)
(f)	Trenching:	# of trenches:.....	Depth:.....	Length:.....m	Width:.....m	Area:.....m <sup>2</sup>
(g)	Test pits:	# of pits: 15	Depth: 3m	Length 2m	Width: 2m	Area: .60m <sup>2</sup>
(h)	Campsite:		Length 30.m	Width 30m	Area:	900m <sup>2</sup>
(i)	Other: Describe .....				Area:.....	m <sup>2</sup>
<b>TOTAL PROPOSED SURFACE DISTURBANCE ON PLACER LEASE/CLAIMS THIS YEAR</b>						
[add lines (a) through (i)] =						(A)
14660m <sup>2</sup>						
<b>TOTAL EXISTING SURFACE DISTURBANCE ON CLAIM (see section 14 for total) =</b>						(B)
15600m <sup>2</sup>						
<b>TOTAL AREA PLANNED FOR RECLAMATION THIS YEAR =</b>						(C)
14700m <sup>2</sup>						
<b>BALANCE OF UNRECLAIMED DISTURBANCE AT THE END OF THIS YEAR: (A) + (B) - (C) = 900m<sup>2</sup></b>						
Proposed production per day 300m <sup>3</sup> .....			Proposed production per year 36000m <sup>3</sup> .....			
.....yd <sup>3</sup>			.....yd <sup>3</sup>			





**16. PRESENT STATE OF LAND ON WHICH WORK IS PROPOSED:**

Present land use: grazing Type of vegetation sage brush  
 Is riparian buffer (10 metre reserve) intact? Yes No  
 Is access presently gated? Yes No, If yes has a key been supplied to the Inspector? Yes No  
 Old equipment(describe): none Buildings/Cabins (describe): none  
 Recreational Trails/use (describe):.....  
 Cultural/Heritage Resources (describe):.....

**17. RECLAMATION PROGRAM:**

- At the termination of the operations each year disturbed areas shall be left in a neat, clean, and safe condition. All mined or otherwise disturbed areas, including cut banks, fill slopes, and tailings piles, shall be stabilized annually by contouring and revegetating. All dead trees and slash shall be disposed of in an acceptable manner.
  - At the final completion of operations, all disturbed areas shall be contoured to conform with the natural terrain, covered with topsoil or growth medium and revegetated. All buildings and equipment shall be removed from the site.
- Reclamation will be conducted concurrently with mining, or Reclamation will be conducted at end of season

**Describe in detail the program of reclamation in accordance with the standards described above:**

We will, as the mining progress, use the washed tailings to fill in the pit area. Working only 300-400 cu m /day will take awhile to have the area to backfill far enough away from the paydirt, so it might be a week or two before we can start backfilling. We expect to backfill all operational holes by fall, and at that time we will be able to cover with topsoil (overburden) so that we can seed.

**18. Appropriate maps are required. Preferred maps are: (a) 1:20,000 topographic maps; (b) claim maps, or as required by the Inspector. Maps should show:**

- |   |   |
|---|---|
| <input checked="" type="checkbox"/> water courses       | <input checked="" type="checkbox"/> existing access                             |
| <input checked="" type="checkbox"/> topography          | <input checked="" type="checkbox"/> location of proposed surface disturbance    |
| <input checked="" type="checkbox"/> proposed new access | <input checked="" type="checkbox"/> known location of previous surface workings |

Note: If underground exploration or development is contemplated, an additional "Underground Exploration Work Application for Approval" must be completed.

Failure to complete all relevant sections may cause the application to be returned

**19. MINING PLAN - Detailed Plan of Disturbed Area:**

(This application will be returned if not accompanied by a legible map or sketch showing - if applicable)

- |  |   |
|--|---|
| <input checked="" type="checkbox"/> location of claim posts  | <input checked="" type="checkbox"/> mining cuts             |
| <input checked="" type="checkbox"/> property boundaries      | <input checked="" type="checkbox"/> overburden stockpiles   |
| <input checked="" type="checkbox"/> access to work areas     | <input checked="" type="checkbox"/> tailings disposal areas |
| <input checked="" type="checkbox"/> watercourses             | <input checked="" type="checkbox"/> settling ponds          |
| <input checked="" type="checkbox"/> proposed grid layouts    | <input checked="" type="checkbox"/> intake water            |
| <input checked="" type="checkbox"/> other surface facilities | <input checked="" type="checkbox"/> fuel storage            |
| <input checked="" type="checkbox"/> camp facilities          | <input checked="" type="checkbox"/> north arrow             |

**MINING PLAN**

See attached map.



Hupman, C Bruce EMPR:EX

PC-399058

**From:** teresa Garbin [atgarbin@shaw.ca]  
**Sent:** May 28, 2008 11:04 AM  
**To:** Hupman, C Bruce EMPR:EX  
**Subject:** Garbin\_app\_form\_water give to Mr.Koster May 25/08  
**Attachments:** header.htm; image007.png; oledata.mso



## Applying for a Water Licence

Updated February 2008

THIS PAGE MUST BE COMPLETED FOR ALL APPLICATIONS.

PLEASE READ THE **APPLICATION FORM GUIDE** WHEN COMPLETING THIS APPLICATION.

<b>PART 1. NAME(S) AND MAILING ADDRESS</b>		
Client Name <input checked="" type="checkbox"/> OR Company Name <input type="checkbox"/> OR Society Name <input type="checkbox"/> Alessandro Garbin		For applications made by more than one individual: <input type="checkbox"/> Joint Tenants; or, <input type="checkbox"/> Tenants in Common  Your File Number (if applicable):
Contact Name of Agent (if applicable):		
BC Incorp. No., BC Registered No. or Society No.:		GST Registration Number:
Mailing Address PO Box 433 108 Mile Ranch, BC		
		Postal Code: V0K 2Z0
E-mail Address atgarbin@shaw.ca		
Home Phone ( 250 )791-5294	Business Phone ( )	Fax Number ( 250 )791-5290

Applicant /Agent's Signature(s)	Date
Please Enclose Appropriate fees (see Fee Schedule 1 Water Application Fees)	
<b>NOTE:</b> Make cheque or money order payable to the <b>Minister of Finance</b> . The information you provide will be subject to the Freedom of Information and Protection of Privacy Act. If you have any questions regarding the treatment of your personal information, please contact the	

Manager, Privacy, Information Access and Records Management.

In addition, the submission of this form does not in any manner convey any rights to use or occupy Crown land.

**PLEASE RETAIN A COPY OF THIS APPLICATION FOR YOUR RECORDS**

FOR OFFICE USE ONLY	
Date Received	Water File Number:
	Client Number:
	Application Number:
	Map Number:
	Fees Received:
Receipt Number:	

## Applying for a Water Licence – Water Act





x

**NOTE:** Once you have completed this form, please refer to the **Application Completeness Checklist** for additional information that must be submitted with this application.

## PART 2. PLACE OF USE – LEGAL DESCRIPTION OF PROPERTY WHERE WATER IS TO BE USED

PID #	Land description: Lease of Placer Minerals Tenures 399058,399059,315276 Civic address of the property: Approx 86 km from Hwy 97 on the Dog Creek Canoe Creek Road
-------	---

An applicant must have tenure to the land where water will be used. (Provide copies of Certificate of Title, Recent Tax Notice or Crown Land Tenure.)	Are you the Registered Owner? Yes <input type="checkbox"/> No <input type="checkbox"/> Lessee <input checked="" type="checkbox"/> Other <input type="checkbox"/>
--	--

Do you hold another water licence(s)?  
Yes ☐ No ☒ If yes, state Licence Number: \_\_\_\_\_ File Number: \_\_\_\_\_ Client Number: \_\_\_\_\_

## PART 3. PURPOSE(S) AND QUANTITY(IES) – Please refer to Schedule 1 – *Water Purpose and Application Fees*

<b>Domestic:</b> Number of dwellings: _____ Quantity (m <sup>3</sup> per day or Gallons) _____	<b>Other:</b> _Placer Mining Quantity: 15000 gal/day Unit: _____ Quantity: _____ Unit: _____
<b>Irrigation:</b> Quantity: _____ Unit: _____ Number of acres to be irrigated: _____	<b>Stockwatering:</b> Quantity: _____ Unit: _____ Number of stock: _____ Type of stock: _____

**Note:** For Water Licence application with proposed diversion rate over 100 m<sup>3</sup> (25,000 gallons) a day, a Development Plan must be completed.

## PART 4. SOURCE OF WATER

Name of Source: Fraser River	Flows into:
If creek, brook or river, width and depth of source at diversion point:	

## PART 5. WORKS—Existing or proposed to divert and convey water to place of use (works must be shown on drawing)

List Works

a) Diversion Works	Pump <input checked="" type="checkbox"/> or Gravity Feed <input type="checkbox"/>	Pipe into a river or lake measured from the high water mark: 15m or _____ ft
	Are any of the Works on <b>Crown land</b> ? Yes <input type="checkbox"/> No <input checked="" type="checkbox"/>	On <b>Crown land</b> : _____ m or _____ ft
b) Storage Works	Do you require storage? Yes <input type="checkbox"/> No <input checked="" type="checkbox"/>	If yes, complete and attach <u>Schedule 2 - Dam &amp; Reservoir Information</u> Land flooded: _____ ha (hectares), or _____ ac (acres) On <b>Crown land</b> ? Yes <input type="checkbox"/> No <input type="checkbox"/>
	Joint with another's Works? Yes <input type="checkbox"/> No <input checked="" type="checkbox"/>	If yes, with whom?
c) Additional Information	Works constructed? Yes <input type="checkbox"/> No <input checked="" type="checkbox"/> Partially <input type="checkbox"/>	<b>Use of a Joint Works Agreement is recommended if part or all of your proposed works will be shared with other water licence holder(s).</b> Enclosed: Yes <input type="checkbox"/> No <input type="checkbox"/>

## PART 6. OTHER LANDS PHYSICALLY AFFECTED BY WORKS

<p>Do or will the Works occupy or flood another person's private land?          Yes <input checked="" type="checkbox"/> No <input type="checkbox"/>          Landowner's Consent Form for private land affected          Enclosed: Yes <input type="checkbox"/> N/A <input type="checkbox"/>, or Could not obtain <input type="checkbox"/></p>	<p>Will the Works occupy or flood <b>Crown</b> land?          Yes <input type="checkbox"/> No <input checked="" type="checkbox"/>          If Yes, a PCL fee is required with the application which is based on the total area of <b>Crown</b> land used  <b>Total area</b> used: _____ ha (hectares), or _____ ac (acres)          Refer to Part 6 of the <u>Application Requirements</u> for area calculation</p>
<p>If yes to either question, provide the legal description of land affected           East 1/2 section 28 Township 8, NW 1/4 Section 27 Township 8           SW 1/4 Section 27 Township 8</p>	<p>Name of Owner(s) including Crown land tenure holders          BC Cattle Company Ltd Warren Koster</p>

**APPLICANT'S DRAWING** – Prepare a drawing to submit with your application. Refer to the required drawing standards for required elements.



Scale: .....

Applicant's Signature: .....

Legend:

Point of Diversion ●

Pipe -----

Pipe Over Crown land \_\_\_\_\_

The boundaries of the land to which this licence is appurtenant are shown thus

Land District:

Map:

POD:

Water District:

Precinct:

**For Office use Only**





## Economic Impacts For Water Licence Applications

**Applications for domestic water or small irrigation purposes  
(less than 6000m<sup>3</sup> (5 AF)/year)  
do not need to complete this information.**

In an effort to more fully appreciate the positive impacts of economic development for a wide variety of uses please provide the following information for your water licence application request:

<b>Capital Investment</b>	\$
---------------------------	----

**Capital Investment** – Reflects the **expenditures** anticipated to be spent in the near future (next 3 years) including:

- Off-site and on-site services that are directly attributable to development related to the water licence (engineering, design, etc.)
- Construction costs directly related to the water licence (pumps, pipes, earthworks, labour, etc.)

<b>Permanent Jobs</b>	
-----------------------	--

**Permanent Jobs** – Measure of the number of ongoing jobs created in the operating and maintenance of the ongoing water use. Use decimals where appropriate.

**This information is required before your water licence application can be processed.**



**Hupman, C Bruce EMPR:EX**

---

**From:** teresa Garbin [atgarbin@shaw.ca]  
**Sent:** May 28, 2008 11:09 AM  
**To:** Hupman, C Bruce EMPR:EX  
**Subject:** Koster-letter May 25/08

Mr. Warren Koster  
B.C. Cattle Co. Ltd.  
Clinton, B.C. V0K 1K0

May 25, 2008

Dear Mr Koster

I am writing on behalf of Alessandro Garbin to express his interest in pursuing a placer mining operation on his mining lease located above the Fraser River. We would like you to review our preliminary planned operation (see attached documents), and allow you the opportunity to raise any issues or concerns that you may have. We recognize that this is on your private land and we want to be sensitive to your concerns.

We would also like you to review our water application and if you agree please sign on the consent form.

I would like to arrange a site visit, at your convenience, to discuss any other concerns and issues that you may have regarding this mining project.

Thank you for your time and consideration in this issue, please submit a response no later than June 30, 2008.

Please feel free to call me; I will be available at home in the evenings.

Sincerely,

Mike Moroni  
Tracker GPS Survey and Mapping Ltd  
2926 Belcarra Rd.  
Quesnel, BC V2J 5A9  
250-747-8302  
250-991-9675 cell  
mmoroni@telus.net

**Hupman, C Bruce EMPR:EX**

---

**From:** teresa Garbin [atgarbin@shaw.ca]  
**Sent:** May 28, 2008 11:11 AM  
**To:** Hupman, C Bruce EMPR:EX  
**Subject:** NOTICE give to Mr. Koster May 25/08

**NOTICE**  
**SECTION 19 (1) OF THE MINERAL TENURE ACT**

**To:** B.C. Cattle Company Ltd, and Warren Koster  
Clinton, B.C. V0K 1K0

registered holder of the following surface rights:

East ½ Section 28 Township 8, NW ¼ Section 27 Township 8  
SW ¼ Section 27 Township 8.

I, Alessandro Garbin, of Box 433, 108 Mile House, BC V0K 2Z0 am

providing Notice that I intend to enter my mining lease on the above properties  
to carry out mining activity between the dates of June 2008 and thru Oct 2008.

There will be approximately 2 people on site and the work will consist of placer  
mining after the required permits are in place. We will also be onsite  
occasionally during this time for exploration activities.

The person who will be onsite and in charge of the mining activity is

Alessandro Garbin of the above address and can be contacted at

250-791-5294, Fax 250-791-5290, or [atgarbin@shaw.ca](mailto:atgarbin@shaw.ca),

---

Signature

---

Date

**NOTE: THIS IS NOT A REQUEST FOR CONSENT TO ENTER PROPERTY**

A free miner or mineral title holder has the right to enter upon and use the surface of private land for exploration and development or production of minerals or placer minerals, and the business of mining subject to the provisions of the MINERAL TENURE ACT, and/or MINING RIGHT OF WAY ACT. A free miner or mineral title holder is required to provide notice in accordance with The MINERAL TENURE ACT and is liable to compensate the owner of surface area for loss or



damage caused by the entry, occupation or use of that area.

For further information on the legislation and other materials pertaining to the NOTICE, please go to:  
[http://www.em.gov.bc.ca/mining/titles/land\\_owner\\_Notice.htm](http://www.em.gov.bc.ca/mining/titles/land_owner_Notice.htm)  
or contact the Mineral Titles Branch at [mineral.titles@gov.bc.ca](mailto:mineral.titles@gov.bc.ca) or 1-866-616-4999

The information on this form and any supporting documents are subject to the *Freedom of Information and Protection of Privacy Act*. The information requested on this form is collected and used for the purpose of administering the *Mines Act* of British Columbia and the *Health, Safety and Reclamation Code for Mines in British Columbia*. The *Mines Act* authorises the collection of the requested information on this form. The completed form is routinely available to the public. Questions about how the *Freedom of Information and Protection of Privacy Act* applies to the information collected on this form can be directed to the Office of the Information and Privacy Commissioner—phone: (250) 387-5629; fax: (250) 387-1696; mailing address: PO Box 9038 Stn. Prov. Govt. Victoria, British Columbia, V8W 9A4

Hand Operation: ☐ Yes ☒ No

If yes, complete items 1-6, 8-10, 12-15 only & applicable maps from 18

# 1. PLACER PROPERTY

LEASE #s: LPM Applied for and approved(not received yet)

EXPIRY DATES:.....

CLAIM #s: 399058,399059, 315276

EXPIRY DATES:.....

Previous Annual Work Approval Number (e.g. PRG1999-0100500-123):.....

Reclamation Permit Number, if previously issued (may be several years old):.....

DURATION OF WORK: From: Spring 2008 To: Fall of 2012

# 2. LOCATION

Are surface rights to any part of this property privately owned? (Operator responsible for contacting Owner)

☐ Yes ☒ No

Name and address of private land owner:.....

Mining division: Clinton All NTS map sheets (e.g. 093G/02E):92O8W, 92O9W.....

Latitude 51.° 59' 38.7"

Longitude 122° 16' 37.5"

# 3. ACCESS

Describe access route to property from nearest town (give exact distances in kms, including secondary roads):

Proceed south of 100 Mile House approx 56 Kms to the junction of Hwy 97 and Meadow Lake Road. Turn Right and go approx 45 Km to the

Junction of Meadow Lake Rd and the Dog Creek Canoe Creek Rd. Continue on the Dog Creek Rd approx 30 Kms and turn left onto a

1 lane dirt track. Proceed toward river approx 800 meters to junction, and turn right. Work area is approx 300 meters farther.

Access is (please check): ☒ Existing ☐ To Be Constructed ☐ Both.

Indicate type of existing access: ☐ All season road ☒ Four wheel drive ☐ ATV. Is there an alternative access route to the property?

(explain): .....

# 4. OPERATOR/AGENT (Person or Company controlling property on behalf of the owner):

Name:..... Telephone No:..... Fax No:.....

Company contact person:..... Address:.....

City:..... Province:..... Postal Code:.....

E-mail Address: ..... Signature of Operator/Agent:..... Date:.....

# 5. OWNER (Title Holder):

Name Alessandro Garbin

Telephone No: 250-791-5294

Fax No:250-791-5290

Address: PO Box 433

City: 108 Mile Ranch

Province B.C. Postal Code: V0K 2Z0 Signature of Owner: .....

(or submit a signed letter of authorization from owner)

Date:.....

# 6. MANAGER (Person responsible for management and operation of property)

Name: See Above

Telephone No:..... Fax No: .....

To whom is correspondence sent regarding this notice?

☐ Agent

☐ Owner

☐ Operator

**7. EXPLORATION WORK** (brief description, attach additional sheets if necessary):

Blasting:..... Geophysical (list type):..... Other:.....  
 Grid and Line development (distance, width, method):.....

**8. TIMBER:** Will merchantable timber be cut during this project? YES ☐ NO ☒

Merchantable timber type:..... Non-merchantable timber type:.....  
 Area to be Cleared:.....m<sup>2</sup> Volume of Merch.:..... m<sup>3</sup> Volume of Non-merch:..... m<sup>3</sup>  
 Will timber be used on site? ☐Yes ☐No If no, indicate method of disposal below:  
☐Bucked and scattered ☐Decked for other timber tenure holders ☐As directed by cutting authorisation

**9. WATER SUPPLY** (subject to approval under the *Water Act*):

Stream name: Fraser River

Describe the source of water supply: Fraser River

Draining to Holding pond

Pump size in water course 6".inches

Quantity of water to be used:.....c.f.s. or . 300 .g.p.m.

Pump size in settling pond 3.inches

Location of water intake (show on plan): High water on Fraser River

Are you proposing changes in or about a stream (bridges, culverts, pipelines, dams, stream diversions, etc.)? ☐Yes ☒No  
 If yes, explain in the space provided below and attach a map (1:20,000 scale) showing the location of all proposed changes.

.....

.....

**10. WASTE WATER TREATMENT** (subject to approval under the *Waste Management Act*):

Describe the waste water treatment facility (settling pond design, recycling, distance from creek, etc.) .....

This operation will use a 15m X 15m X 2m deep settling pond for the water coming from the Trommel. It will then be recycled by a pump into the holding pond. The settling pond will be approximately 75 m from the drop off edge into the Fraser River basin.

Is your operation planned for **zero discharge** (zero discharge means no water is released back into a stream either through a pipe, an overflow, by pumping, or by visible seepage through an impoundment): ☒YES ☐NO If no, please describe:

.....

.....

**11. EQUIPMENT LIST** (Note: all equipment to comply with the Health, Safety and Reclamation Code):

Number and Type	Size/Capacity
a) Link Belt 200	1 yard bucket.
b) J.D. 590 excavator	¾ yard bucket
c) TD15 International Crawler	.....
d) Dump Truck	.....
e) Processing plant trammel	.....
f) TD25 International Crawler	.....

**12. FIRST AID FACILITIES** (Must comply with W.C.B. regulations):

Describe methods of communication on site: Satellite phone, Spot

Location of nearest hospital 100 Mile House

Travel time to hospital (surface): 2:30 hrs

Number of persons on site (including contractors): 2-3 people

Type of transportation available: 4-wd Jeep

First aid equipment on site: Level 1 kit

First aid certificate level(s): Level 1

Expiry Date: To be renewed this year

Holder of Supervisor Certificate: .....

Expiry Date:.....



**13. SURFACE DISTURBANCE OFF PLACER LEASES OR CLAIMS:** ☐ Yes ☒ No (if no proceed to section 14)

Campsite: Length:.....m Width:.....m Area:.....m<sup>2</sup>  
 Access construction: Total length:.....m Width:.....m Area:.....m<sup>2</sup>  
 Other (specify): .....

**14. EXISTING SURFACE DISTURBANCE ON PLACER LEASES OR CLAIMS:**

(includes spoil piles, travelled areas, side casts)

(Length × Width = Area)

(a)	Settling Ponds:	No. 2	Length: 10.m	Width: 10m	Area: 100.m <sup>2</sup>
(b)	Mining areas:	No. 1	Length: 20.m	Width: 20m	Area: 400m <sup>2</sup>
(c)	Coarse tailings piles-		Length: 20.m	Width: 20m	Area: 400m <sup>2</sup>
(d)	Existing Access:		Length:.....m	Width:.....m	Area:.....m <sup>2</sup>
(# × Length × Width = Area)					
(e)	Trenching:	# of trenches:.....	Depth:.....	Length:.....m	Width:.....m Area:.....m <sup>2</sup>
(f)	Test pits:	# of pits:10	Depth: 3m	Length: 2 m	Width: 2m Area 40.m <sup>2</sup>
(g)	Campsite:		Length:.....m	Width:.....m	Area:.....m <sup>2</sup>
(h)	Other: Describe .....				Area:.....m <sup>2</sup>

**TOTAL EXISTING SURFACE DISTURBANCE ON CLAIM [add lines (a) through (h)]****940m<sup>2</sup>****15. PROPOSED SURFACE DISTURBANCE ON PLACER LEASES OR CLAIMS:**

(includes spoil piles, travelled areas, side casts)

(Length × Width = Area)

(a)	Wash plants:	No. 1	Length: 10.m	Width: 10m	Area: 100m <sup>2</sup>
(b)	Settling Ponds:	No. 3	Length: 15m	Width: 15m	Area: 675.m <sup>2</sup>
(c)	Mining areas:		Length: 160.m	Width: 75m	Area: 12000m <sup>2</sup>
(d)	Coarse tailings piles:		Length: 25 m	Width: 25 m	Area: 625m <sup>2</sup>
(e)	Access construction:		Length: 100.m	Width: 3m	Area: 300.m <sup>2</sup>
(# × Length × Width = Area)					
(f)	Trenching:	# of trenches:.....	Depth:.....	Length:.....m	Width:.....m Area:.....m <sup>2</sup>
(g)	Test pits:	# of pits: 15	Depth: 3m	Length: 2m	Width: 2m Area: .60m <sup>2</sup>
(h)	Campsite:		Length: 30.m	Width: 30m	Area: 900m <sup>2</sup>
(i)	Other: Describe .....				Area:.....m <sup>2</sup>

**TOTAL PROPOSED SURFACE DISTURBANCE ON PLACER LEASE/CLAIMS THIS YEAR**

[add lines (a) through (i)] =

**(A) 14660m<sup>2</sup>****TOTAL EXISTING SURFACE DISTURBANCE ON CLAIM (see section 14 for total) =****(B) 15600m<sup>2</sup>****TOTAL AREA PLANNED FOR RECLAMATION THIS YEAR =****(C) 14700m<sup>2</sup>****BALANCE OF UNRECLAIMED DISTURBANCE AT THE END OF THIS YEAR: (A) + (B) - (C) = 900m<sup>2</sup>****Proposed production per day 300m<sup>3</sup> .....yd<sup>3</sup>****Proposed production per year 36000m<sup>3</sup> .....yd<sup>3</sup>**



**16. PRESENT STATE OF LAND ON WHICH WORK IS PROPOSED:**

Present land use: grazing lease

Type of vegetation sage brush

Is riparian buffer (10 metre reserve) intact?

☒ Yes☐ NoIs access presently gated? ☐ Yes ☒ No,

If yes has a key been supplied to the Inspector?

☐ Yes☐ No

Old equipment(describe): none

Buildings/Cabins (describe): none

Recreational Trails/use (describe):.....

Cultural/Heritage Resources (describe):.....

**17. RECLAMATION PROGRAM:**

- At the termination of the operations each year disturbed areas shall be left in a neat, clean, and safe condition. All mined or otherwise disturbed areas, including cut banks, fill slopes, and tailings piles, shall be stabilized annually by contouring and revegetating. All dead trees and slash shall be disposed of in an acceptable manner.
- At the final completion of operations, all disturbed areas shall be contoured to conform with the natural terrain, covered with topsoil or growth medium and revegetated. All buildings and equipment shall be removed from the site.

☒ Reclamation will be conducted concurrently with mining, or☐ Reclamation will be conducted at end of season**Describe in detail the program of reclamation in accordance with the standards described above:**

We will, as the mining progress, use the washed tailings to fill in the pit area. Working only 300-400 cu m /day will take awhile to have the area to backfill far enough away from the paydirt, so it might be a week or two before we can start backfilling. We expect to backfill all operational holes by fall, and at that time we will be able to cover with topsoil (overburden) so that we can seed.

**18. Appropriate maps are required. Preferred maps are: (a) 1:20,000 topographic maps; (b) claim maps, or as required by the Inspector. Maps should show:**

water courses



existing access



topography



location of proposed surface disturbance



proposed new access



known location of previous surface workings

Note: If underground exploration or development is contemplated, an additional "Underground Exploration Work Application for Approval" must be completed.

Failure to complete all relevant sections may cause the application to be returned

**19. MINING PLAN - Detailed Plan of Disturbed Area:**

(This application will be returned if not accompanied by a legible map or sketch showing - if applicable)

- |  |   |
|--|---|
| <input checked="" type="checkbox"/> location of claim posts  | <input checked="" type="checkbox"/> mining cuts             |
| <input checked="" type="checkbox"/> property boundaries      | <input checked="" type="checkbox"/> overburden stockpiles   |
| <input checked="" type="checkbox"/> access to work areas     | <input checked="" type="checkbox"/> tailings disposal areas |
| <input checked="" type="checkbox"/> watercourses             | <input checked="" type="checkbox"/> settling ponds          |
| <input checked="" type="checkbox"/> proposed grid layouts    | <input checked="" type="checkbox"/> intake water            |
| <input checked="" type="checkbox"/> other surface facilities | <input checked="" type="checkbox"/> fuel storage            |
| <input checked="" type="checkbox"/> camp facilities          | <input checked="" type="checkbox"/> north arrow             |

**MINING PLAN**

See attached map.



Print and Close

Cancel

## Mineral Titles Online Viewer

## Tenure Detail

**Tenure Number ID**    **399058**    [View Tenure](#)

Tenure Type            Placer (P)  
Tenure Sub Type        Claim (C)  
Title Type              Placer Claim (PC)  
Mining Division        CLINTON  
Good To Date           2012/dec/29  
Issue Date              2002/dec/29  
Demised To              936953  
Termination Type       DEMI  
Termination Comments  
Termination Date       2011/dec/09  
Tag Number              P75568  
Claim Name              ALESSANDRO GARBIN #1  
Old Tenure Code        399058  
Area In Hectares       50.00

## Map Numbers:

[0920](#)

## Owners:

[109211](#) GARBIN, ALESSANDRO PIETRO 100.0%

Tenure Events:		Submitter	Event	Effective Date
<a href="#">109211</a>		GARBIN, ALESSANDRO PIETRO	L_CAPP MIDA Claim Applic. (3188960)	2002/DEC/29
<a href="#">109211</a>		GARBIN, ALESSANDRO PIETRO	L_INCL MIDA Inclusion (3188962)	2002/DEC/30
<a href="#">109211</a>		GARBIN, ALESSANDRO PIETRO	L_SOW MIDA Work Statement (3203683)	2003/DEC/15
<a href="#">109211</a>		GARBIN, ALESSANDRO PIETRO	L_SOW MIDA Work Statement (3221920)	2004/DEC/15
<a href="#">109211</a>		GARBIN, ALESSANDRO PIETRO	SOW Exploration and Development Work / Expiry Date Change( <a href="#">4059530</a> )	2005/DEC/16
<a href="#">109211</a>		GARBIN, ALESSANDRO PIETRO	CIL Payment Instead of Exploration and Development Work( <a href="#">4116043</a> )	2006/DEC/13

Mineral Titles  
Online

## FOI Allasandro

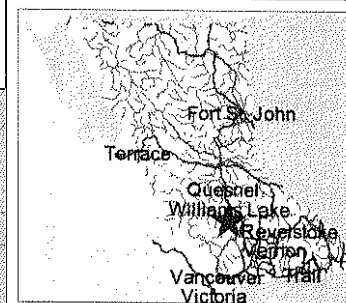
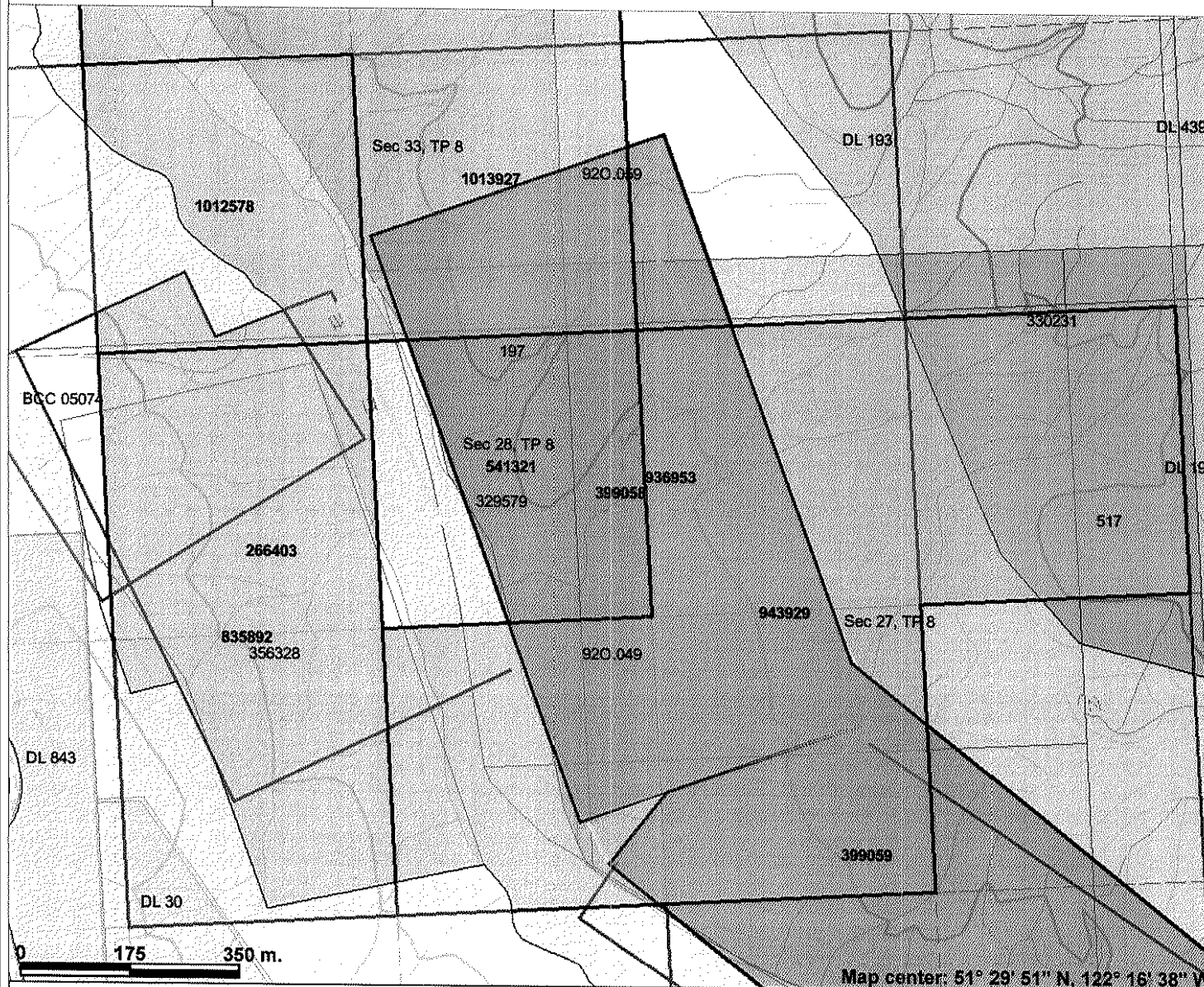

## Legend

- ☐ Indian Reserves
- ☐ National Parks
- ☐ Conservancy Areas
- ☐ Parks
- ☐ Federal Transfer Lands
- ☐ Placer Tenure (current)
- ☒ Placer Claim
- ☒ Placer Lease
- ☐ Placer Tenure (history)
- ☐ Placer Reserves (current)
- ☒ Placer Claim Designation
- ☐ Placer Lease Designation
- ☐ No Staking Reserve
- ☐ Conditional Reserve
- ☐ Release Required Reserve
- ☐ Surface Restriction
- ☐ Recreation Area
- ☐ Others
- ☐ MTO Grid (MTO)
- ☐ First Nations Treaty Related Lands
- ☐ First Nations Treaty Lands
- ☐ Integrated Cadastral Fabric
- ☐ Survey Parcels
- ☐ BCGS Grid
- ☐ Contours (TRIM)
- ☒ Contour - Index
- ☐ Contour - Index, Indefinite
- ☐ Contour - Index, Depression
- ☐ Contour - Index, Depression Indefinite
- ☐ Contour - Intermediate



Scale: 1:9,730

This map is a user generated static output from an Internet mapping site and is for general reference only. Data layers that appear on this map may or may not be accurate, current, or otherwise reliable. THIS MAP IS NOT TO BE USED FOR NAVIGATION.