

4542

PROVINCE OF BRITISH COLUMBIA
DEPARTMENT OF PUBLIC WORKS

FROM Divisional Engineer VICTORIA	TO N.M. McCallum, Esq., Asst. Chief Engineer, BUILDINGS.	DATE Nov. 16, 1949. ELECTORAL DISTRICT Esquimalt OUR FILE 12-20-132 YOUR FILE \$132
SUBJECT Rocky Point Road		REFERENCE YOUR LETTER

RECEIVED
PROV. PUBLIC WORKS DEPT.
VICTORIA, B. C.

NOV 18 1949

ANSWERED *[Signature]*
NOTED *[Signature]*
DATE

FOR DEPARTMENTAL AND INTERDEPARTMENTAL CORRESPONDENCE ONLY

With reference to your letter of November 14th, I would like very much to see the Rocky Point Road surfaced, but before surfacing could be undertaken it would be necessary to build up the road. In connection with this I refer you to my letter of March 16th, file 500, with which I enclosed a copy of Mr. Bourne's report of March 12th.

Mr. Bourne figures that approximately \$18,000.00 would be required to be spent on the 2.2 mile section of the Rocky Point Road, from the end of the present pavement to the start of the East Sooke Road, and I agree with him that this would be very necessary.

On a inspection of the Rocky Point, East Sooke and the Gillespie Roads this afternoon I did not meet any vehicle other than the Public Works grader, so you will see that the traffic on this road is not very heavy.

At the present time all three roads are in good condition.

[Signature]
O.G. GALLAHER,
Divisional Engineer.

OGG:mb

817154

A.C.E.
Page 1
TRA-2011-00297

November 15th, 1949.

Divisional Engineer,
Victoria, B.C.

Esquimalt
4542
A-21-55

Survey of East Sooke and Rocky Point Road,
Section 42, Netchosin District.

Oct. 24th, 1949.

With reference to your letter of October 24th, re the above, no funds are available at this time to undertake this work as set out in Mr. Aldous' letter, but will you please take this matter up with Mr. Steve, Location Engineer, and if this is a desirable survey to make at the present time, perhaps Mr. Steven can provide funds out of the Survey Vote for this purpose.

H. C. Anderson,
Chief Engineer.

by:

N. M. McCallum,
Asst. Chief Engineer.

NMM/CE

November 14th, 1949.

Divisional Engineer,
Victoria, B.C.

Esquimalt
~~5122~~

Rocky Point Road.

s.22 called at the office this morning
with reference to paving Rocky Point Road.

In December of last year, a petition was received from the residents of that area requesting paving on this road, but I presume that considerable preparation would be necessary even if it was desirable to pave this road at this time.

Please let me have a report and recommendation regarding the condition and desirability of paving this road.

H. C. Anderson,
Chief Engineer.

by:

N. M. McCallum,
Asst. Chief Engineer.

NMM/CB

14547

PROVINCE OF BRITISH COLUMBIA
DEPARTMENT OF PUBLIC WORKS

FROM Divisional Engineer VICTORIA	TO Mr. McCallum, Asst. Chief Engineer, BUILDINGS.	DATE Oct. 24, 1949. ELECTORAL DISTRICT Esquimalt OUR FILE A-21-55 YOUR FILE 4542
SUBJECT Survey of East Sooke and Rocky Point Roads, Section 42, Metchosin District.		REFERENCE YOUR LETTER Oct. 7th, 1949.

RECEIVED
 PROV. PUBLIC WORKS DEPT.
 VICTORIA, B. C.

OCT 27 1949

ANSWER.....

NOTED.....

DATE 15/11/49 With reference to your letter of October 7th, 1949, and Mr. Smith's letter to Mr. E.L. Tait of May 13th, 1947, file 5132.

I attach herewith a copy of Mr. Aldous' letter of October 13th, from which you will see that he estimates the cost of carrying out the surveys agreed upon will be \$600.00.

If the Department wishes to go ahead with this survey, it will be necessary that a Work Order for \$600.00 be furnished. Will you please advise me.

 O.G. GALLACHER,
 Divisional Engineer.

OGG:mb
 Encl.-1

814784

A. C. E.

COPY

October 13, 1949.

612 View Street,
Victoria, B.C.

Divisional Engineer,
Dept. of Public Works,
Victoria, B.C.

Re: Your File A-21-55 .
Survey of Rocky Point & East Sooke Roads
through Section 42, Metchosin District.

Dear Sir:-

I beg to thank you for your letter of the 7th inst. regarding the above matter and in reply would estimate the cost of survey as follows, taking into consideration the amount of preliminary work done in connection with a recent survey of Sec. 44 which can be applied to the work under consideration.

Estimate #1.	Survey of the Rocky Point and East Sooke Roads through Section 42, except the road boundaries on the north and west of the S.E. Parcel.	\$280.00
Estimate #2.	Survey of both sides of the Rocky Point and East Sooke Roads through Section 42 together with a right-of-way plan of same	\$350.00

Note: I have not included a plan with estimate #1 as the subdivision plan of the S.E. parcel will cover the majority of this.

For your further information and in view of my considerable knowledge of the original (1858) surveys in this district, I estimate the total cost of the survey of both sides of the Rocky Point and East Sooke Roads through Sections 29, 30, 41 and 42 Metchosin (not Sooke as quoted in your letter) District together with a right-of-way plan, to be \$600.00.

Yours very truly,

"F.G. Aldous"

October 7th, 1949.

Divisional Engineer,
Victoria, B. C.

Esquimalt
4542
A-21-55

Survey of Roads

Oct. 4th, 1949.

With reference to your letter of October 4th, re the above, please obtain from Mr. Aldous an estimate of the cost of undertaking the survey which was agreed to in May 1947.

H. C. Anderson,
Chief Engineer.

by:

N. M. McCallum,
Asst. Chief Engineer.

NMM/CB

4547

PROVINCE OF BRITISH COLUMBIA
DEPARTMENT OF PUBLIC WORKS

FROM Divisional Engineer VICTORIA	To Chief Engineer, BUILDINGS.	DATE Oct. 4, 1949. ELECTORAL DISTRICT Esquimalt OUR FILE A-21-55 YOUR FILE 4542/811835
SUBJECT RECEIVED PROV. PUBLIC WORKS DEPT. VICTORIA, B. C. Survey of Roads		REFERENCE YOUR LETTER

ANSWERED. *2/10/49*NOTED. *2/10/49*DATE. *2/10/49*

Relative to the attached letter, #811835, from Mr. Aldous, I beg to state that on 13th May 1947, file 5132, Mr. E.L. Tait, Solicitor, was advised that we would pay for the survey of the west side of East Sooke Road and Rocky Point Road and the north side of Rocky Point Road all in Section 42, if s.22 paid for the survey of the south east parcel of Section 42, Metchosin District, as shown on the attached sketch. This was never done.

According to Mr. Aldous' letter s.22 owns considerable land and, no doubt, pays taxes on the area included in these two roads. Mr. Aldous considers the Government should pay for the surveying of all the roads in this and other areas, which would be very expensive.

s.22 having the road as one boundary which has to be surveyed. If the Department has funds available, our offer could be extended to include these roads in Sections 29, 30, 40 and 41 as well. Under the circumstances, we might refer Mr. Aldous to our offer of 13th May 1947 and advise him that we are unable to enlarge upon same at present.

O.G. Gallaher

O.G. GALLAHER,
Divisional Engineer.

TFB:mb
Encl.-2

A.C.E.

812166



11-25-49 @ 10:00
F. G. ALDOUS

BRITISH COLUMBIA LAND SURVEYOR

REGD. PROFESSIONAL ENGINEER (CIVIL)
BRITISH COLUMBIA

TELEPHONE E 6233

Chief Engineer
Dept. of Public Works
Victoria B.C.

Dear Sir:

A client of mine.

s.22

12.20.02
SUBDIVISIONS - TOPOGRAPHICAL MAPPING
ROAD LOCATION AND CONSTRUCTION
WATER SUPPLY - DRAINAGE
MINERAL CLAIMS

RECEIVED
PROV. PUBLIC WORKS DEPT.
VICTORIA, B. C.

October 1st.
1949

OCT 3 - 1949

612 VIEW STREET

VICTORIA, B.C.

ANSWERED.....

NOTED.....

DATE.....

Survey of Rocky Point Road

4542

The Land Registry Office refuses to accept any transfer until these roads have been established by a right-of-way plan based on a proper survey.

These roads have been in public use for probably 70 or 80 years and have never yet been established by gazette or any other medium.

In my own humble opinion it does not seem quite right or fair for the Government to expect to have public roads established at the expense of the adjoining property owners and, in this specific case, I would suggest that your Department agrees to contribute toward the cost of this survey and preparation of the right-of-way plan.

I have just completed a survey of Section 44 in which I had to traverse the East Sooke and Rocky Point roads through Section 42 and the Milne Road through the Indian Reserve from Section 49 to its junction with the East Sooke Road. This work will be of great value in the present case but, in order to make use of same while my traverse points are still in good standing, I should appreciate hearing from you at your earliest convenience.

Yours very truly,

F. G. Aldous.

811885

M.C.D.

4/24/49

PROVINCE OF BRITISH COLUMBIA
DEPARTMENT OF PUBLIC WORKS

FROM District Engineer VICTORIA	TO Mr. Anderson, Chief Engineer, BUILDINGS.	DATE March 16th 1949. ELECTORAL DISTRICT Esquimalt OUR FILE 12-20-132 YOUR FILE 588
SUBJECT Paving of gravelled road from Metchosin to junction of the East Sooke and Rocky Point Roads.		REFERENCE YOUR LETTER Feb. 28/49

RECEIVED
PROV. PUBLIC WORKS DEPT.
VICTORIA, B. C.

ANSWERED
NOTE
DATE
MAR 17 1949

FOR DEPARTMENTAL AND INTERDEPARTMENTAL CORRESPONDENCE ONLY

With reference to s.22 letter to you of February 15th regarding the Rocky Point Road, I attach herewith a copy of Mr. Bourne's estimate covering the cost of the work requested by s.22

I agree with Mr. Bourne that this amount of money would not be justified at the present time to be spent on the Rocky Point Road because, despite complaints from s.22 and others who use that road constantly, the Rocky Point Road has been kept in remarkably good condition in the past few years and they are not suffering any great hardship to have to make use of it as a gravelled road.

This section of road, despite s.22 remarks, has been constantly graded and frequently inspected and it has never been a mass of pot-holes during the past two years.

O.G. GALLAHER,
District Engineer.

OGG:MB
Encl.-1

787384

M.E.
C.E.

Assistant District
Engineer,
280 Burnside Road West
Victoria, B.C.

District Engineer,
Victoria, B.C.

March 12, 1949

Esquimalt

12-30-132

Paving of gravelled road from Metchosin
to junction of the East Sooke and
Rocky Point Roads

I wish to report that the portion of the road requested
to be paved is about 2.2 miles long, and an average width
of 20 feet from shoulder to shoulder. At the present
time this is more or less a dirt road, and before
paving it would be necessary to heavily re-inforce it
with gravel and do considerable ditching, the estimated
cost of which is as follows:

Scarify & reshape:	\$ 1,000.00
Foundation Gravel (8"x20"x2.2 miles)	
5735 Cubic Yards @ \$1.50 in place	8,602.50
Surfacing gravel (4"x20"x2.2 miles)	
2869 Cubic Yards @ \$2.50 in place	7,172.50
Ditching	1,000.00

\$ 17,775.00

Surfacing: Double Spray

18' wide, 2.2 miles @ \$1,200.00
per mile

\$ 2,640.00

\$20,415.00

Taking into consideration the condition of
our main roads throughout the district, I
cannot see how I could justify recommending
that this work be done before our main roads.

HFB:RS

H.F. BOURNE,
Asst. Dist. Engr.

File: 4542

7th March, 1949.

s.22

Dear Sir:

I have your letter of the 27th ultimo with further reference to the condition of Rocky Point Road from Metchosin to the East Sooke, Rocky Point Road junction.

As previously advised our Engineer has the matter in hand and is doing all he can to repair the damage which has been done to our highways generally as the result of an extraordinary breakup this Spring, and I am sure everything is being done to bring the respective roads back to normal as quickly as it is possible.

Very truly yours,

H.C. Anderson,
Chief Engineer.

AL/HC

B1224

s.22

RECEIVED
PROV. PUBLIC WORKS DEPT.
VICTORIA, B. C.

February 27, 1949.

MAR 1 - 1949

Chief Engineer,
Dept. of Public Works,
Victoria, B. C.

ANSWERED

NOTED

DATE

Dear Sir:

Further to my letter of February 15, I would appreciate it if you will give the matter of paving the Rocky Point Road from Metchosin to the East Sooke - Rocky Point Road junction further consideration.

Since my letter there have been new developments. The road has degenerated into nothing more nor less than a continuous quagmire. There are now no less than four stretches of about one hundred feet or more of road which is to all intents impassable. Cars and trucks have been stuck in each of them, in some of them by the dozen. This road has become quite hopeless for traffic which maroons us until it be fixed, which may be quite some time.

Needless to say we are distressed, especially so since there has been a great deal of dissatisfaction with this road, expressed both to the authorities and otherwise.

I understand that the road to Metchosin was paved a good many years ago. Surely there has been time to have this road paved. If it be not paved now when will it be paved?

Yours truly,

s.22

s.22

s.22

785581

O. E.

28th February, 1949.

s.22

Dear Sir:

This will acknowledge receipt of your letter of the 15th instant wherein you request that the gravelled road from Metchesin to the Junction of the East Sooke and Rocky Point Roads be paved, and in reply wish to tell you that your representations will receive consideration by the Department.

In this connection we are forwarding a copy of your letter to our District Engineer with the request that the matter be kept in mind when reviewing the appropriations for the coming season's paving programme.

Very truly yours,

H.C. Anderson,
Chief Engineer.

AM/HG

February 28th, 1949.

s.22

Dear Sir:

I am directed to acknowledge receipt of a Petition signed by yourself and a number of Metchosin and District residents, requesting the Department to give immediate attention to the paving of some three miles of road-way between Metchosin and the East Sooke-Rocky Point Road junction, and in reply wish to advise that your representatives are receiving the attention of the Department.

Yours very truly,

H.C. Anderson,
Chief Engineer.

December 19, 1948.

FEB 24 1949

The Minister,
Dept. of Public Works,
Victoria, B. C.
ANSWERED
NOTED
DATE

Attention Chief Engineer

The purpose of this petition is to request that immediate attention and priority be given to the paving of the Rocky Point Road between Metchosin and the East Sooke-Rocky Point Road junction.

With the considerable increase in population of both East Sooke and Rocky Point, in addition to the school bus, milk freight, and vastly increased number of commercial vehicles, both large and small, this road has proved unable to withstand the ravages of such intense traffic, and is continually a mass of pot holes. Even after grading it very quickly reverts to its usual state.

As an added factor, the increased demand for the large grader evidently has made it impossible to scrape the road more often than every three or four months, whereas the small grader has been able to keep the East Sooke Road in a fair condition.

The undersigned request that immediate attention and priority be given to the paving of this stretch of three miles of road.

J. R. Davidson
P. Davidson

Laura Reid
Jergon Reid

METCHOSIN GENERAL STORE & P. O.

Alex. Ellwood
Violet Ellwood

Mrs. W. A. C. Holland

D. Standing
G. Schofield

R. H. Hemmingson 785073

Laura Ed. Priddle
L. Priddle
Louise Tuge

Ray Helm
K. D. Wood
K. M. Wood

Margaret Reigshelm
G. H. Creaser
Keith Nelson
Mrs. R. Purdy
R. Purdy

George Lamb
Jasper J. Charles
Mrs. Pauline Charles

mail carrier
Lester A. Nelson
W. R. Thompson
E. Lock

As an added factor, the increased demand for the large grader evidently has made it impossible to scrape the road more often than every three or four months, whereas the small grader has been able to keep the East Sooke Road in a fair condition.

The undersigned request that immediate attention and priority be given to the paving of this stretch of three miles of road.

G.R. Davidson

R. Davidson

Lana Reid

Langensland

METCHOSIN GENERAL STORE & P.O.

~~Albert Ellwood~~

Violet Hemmick

Mrs W.A. C. Hellebrand

D. Standen
G. Schurfield

R.A. Hemmick 785073

George Hemmick Mail Contractor

James J. Parks

Mrs. Caroline Charles

Mrs. Nellie Parks

A.E. Parks

Luna Reid - Fiddich
Lana Reid

Laura Tuge

Ray John

R.D. Wood

G.M. Wood

Magist Bergstrom

G.H. Treasner

Keith Nelson

Mrs. R. Purdy

R. Purdy

W. Rothman

J. Thorne

George

O.E.

RECEIVED
PROV. PUBLIC WORKS DEP
VICTORIA, B. C.

s.22

FEB 21 1949

Feb. 15, 1949.

ANSWERED.....
NOTED.....
DATE.....

Chief Engineer,
Dept. of Public Works,
Victoria, B. C.

Dear Sir:

The purpose of this letter is to request that consideration be given to paving the gravelled road from Metchosin to the junction of the East Sooke and Rocky Point Roads, because:

1. This road bears all of the greatly augmented traffic from East Sooke to Victoria besides all of the Rocky Point traffic. Both of these have vastly increased in the last two years.
2. The road requires a large grader to maintain it and this comes over several miles of pavement from Langford. It is very seldom this grader can be spared evidently and the road is only graded down about two or three times a year.
3. The small grader based at East Sooke manages to maintain the East Sooke and Rocky Point Roads in fair shape but the aforementioned section of road is evidently beyond its responsibility.
4. The road from Metchosin to the junction of the East Sooke and Rocky Point Roads is always a mass of potholes and bumps, and requires a low speed to keep from breaking springs, which is not always desirable since there is a large hill in the middle of it.

s.22

A petition to have this stretch of road paved is at present being circulated.

Yours truly,

s.22

s.22

784719

O. E.

Copy sent O. G. Gallaher, Burnside.

File 4542

Victoria, B.C.,
Oct. 2nd, 1947.

Re: Condition of Milne Road

Sir:

Your letter of September 24th to the Deputy Minister was referred to me in his absence. I am taking the matter up with the Asst. Dist. Engineer and you will be advised as to what can be done.

All our men and equipment in the Esquimalt District are exceedingly busy, but I hope the provision may be made to carry out the necessary work on the Milne Road.

Yours very truly,

E. SMITH,
District Engineer

s.22

ES:CE

24 Sep 47.

H/SY

Deputy Minister.
 Dept of Public Works
 Victoria, B.C.

RECEIVED
 PROV. PUBLIC WORKS DEPT.
 VICTORIA, B.C.

SEP 26 1947

ANSWERED.....
 NOTED.....
 DATE.....

Dear sir,

I am enclosing a clipping from today's Colist
 which is of considerable interest to us, since we
 use the crossing in question several times a week
 and have had some exceedingly narrow escapes
 from death. Would you care to have this
 looked into?

on Crossing File

The purpose of this letter is to request
 that you have the question of ^{Milne} Milne Road
 investigated. This is a small, short provincial
 road leading across the Buckle Bay Indian
 Reserve and in its original condition was
 suitable for one family living at the end.

728840

New Lower there are four families, and ten men living at the end, and the road is used by six to eight trucks a day and at least as many passenger cars. It is winding and hilly and there is no suitable passing point along its entire length of half a mile. May steps be taken to have the road widened so that vehicles may pass? a bulldozer could do it in three hours, easily.

I have contacted you Mr. Gallaher three times by letter and he states he is much too busy elsewhere, and also cannot pay to hire a private bulldozer to do the work. I would deeply appreciate it if you could at least have the matter investigated, ^{and} a date set when the work could be done. It is urgently required now.

Yours truly

Deputy Minister
C.P.W. Victoria.

RECEIVED
PUBLIC WORKS DEPT.
VICTORIA B.C.

AUG 1 - 1947

FILED
DATE July 4542

28 July.

14542

Dear Mr. Corriton,

Thank you for your letter
of 14 July.

The road in question has
since had the grade run over it, and it is
in much better shape. All I am asking is that
it be given ordinary maintenance during the
season, instead of being left for months.

Is not what you say
about it not being in too bad shape like.

s.22

s.22

had the misfortune to
break the ^{leaves} ~~spring~~ and a head lamp on it just
about that time, travelling less than 20 mph.

I hope you will soon see your
way clear to paving this stretch of road.

Yours truly,

722831

ABL

DEPUTY
Page 22
TRA-2011-00297

s.22

July 14th, 1947.

s.22

Dear Sir:

With reference to yours of June 12th, an inspection has been made of the Rocky Point and East Sooke Roads by our Engineer and I find that they are not in as bad a condition as your letter would indicate. It would appear that the Rocky Point Road is in quite good condition for that class of road. There are some sections of the East Sooke Road which are rather rough but the Foreman has been instructed to make the necessary repairs.

Your reference to the grader being idle at the Langford Yard is not quite correct; it is being used there for preparing asphalt mix for patching purposes. You will understand that we have a big mileage in the Esquimalt District which we are doing our best to improve and I think you will agree that we have made considerable progress in the last two years.

Yours truly,

Deputy Minister

AIC/MB

4542

PROVINCE OF BRITISH COLUMBIA
DEPARTMENT OF PUBLIC WORKS

FROM Asst. Dist. Engineer, 280 Burnside Rd. W., Victoria, B. C.	TO Mr. E. Smith, District Engineer, Victoria, B. C. <small>PROV. PUBLIC WORKS DEPT.</small>	DATE June 27/47 ELECTORAL DISTRICT Esquimalt OUR FILE 12-20-79 YOUR FILE 4542
SUBJECT Rocky Point Road <div style="text-align: right;">JUN 28 1947</div>		REFERENCE YOUR LETTER June 23

With reference to s.22 letter of June 12th.

I examined Rocky Point Road yesterday; and the East Sooke Road, and I was very agreeably surprised to find that both of these roads are in much better condition at the present time than I have ever found them to be at this time of the year. The Rocky Point Road particularly was in good condition. The East Sooke Road has some rough sections, and the foreman will have these attended to as soon as possible.

I do not know where s.22 gets his idea that the grader plays around the Yard at Langford. We do use the grader there to mix blacktop; but this is definitely not playing. In any event, the use of the grader on the Rocky Point Road at the present time would be a waste of money as it is not needed, and would do no appreciable good.

During the past two years we have carried out a definite program of gravelling on the Rocky Point Road. Early in the past spring we hauled enough gravel onto this road to put it in fairly good condition, and the road now is showing a very definite improvement due to this gravel. In my opinion the only thing to do on the Rocky Point Road, as pointed out in previous reports, is to continue to gravel until we get a good base on the road, and it has been my intention to do so as the opportunity offered.

If we are to play around with this road as s.22 suggests, we will never be able to make any definite improvement in it, and I think that my system of using what money is available to place a gravel surface on the road, will give both s.22 and the users of the road more for their money than they would get any other way.

 O. G. CALLAHAN
 Asst. Dist. Engr.

OGG:JW

719233

Deputy Minister

RECEIVED
PROV. PUBLIC WORKS DEPT.
VICTORIA, B.C.

12 June.

Dept of Public Works. JUN 14 1947

Victoria, B.C.

RECEIVED
NOTES
DATE

attn Deputy Minister

Dear sir,

The purpose of this letter is to complain bitterly about the condition of the Rocky Point East Lake Roads.

If taxes are to be doubled, then at least we should be able to ride along the road at the reasonable speed of ten miles an hour and not be shaken to bits. This particular piece of road has had absolutely no maintenance of any kind ~~to some~~ early last winter and is a positive disgrace.

If the grade can spend time playing about the yard where the vehicles are kept at Langford it can surely run over this bit of road

17542

D.E.

once a month. I have contacted your
office in town and the Resident Engineer
and nothing has been done. I trust you will
be able to have something done to have
some maintenance done on the pipe of road.

Yours truly

s.22

File 4542

Victoria, B.C.,
May 22nd, 1947.

Re: Rocky Point Road

Madam:

Your letter of May 13th to Mr. A. L. Carruthers has been referred to this office for attention, and I have to advise you that on May 13th I wrote to Mr. E. L. Tait, Barrister and Solicitor, stating that a surveyor's plan is required and this Department is prepared to pay for the surveyor's extra work in locating the westerly boundary of the East Sooke Road and the opposite boundary of Rocky Point Road, and both sides of the Rocky Point Road north of the junction.

In other words, the surveyor will include both the roads within the red outline of his plan as well as the south-east part of Section 42.

Yours very truly,

E. SMITH,
District Engineer

s.22

TFB:CE

RECEIVED
 PROV. PUBLIC WORKS DEPT.
 1947

MAY 13 1947

May 13/47

A. L. Carruthers Esq.

Dear Sir,

Confirming my telephone call to you re gazetting of the main road through Section 42 Metchosisin. I am forwarding you the correct description of the parcel of land in question. It is as follows:- "That portion of Sec. 42 Metchosisin lying to the Southwest of Rocky Point road and to the South east of the East Sooke road."

This property is already fenced and its boundaries are surveyed, with the exception of the road. At present I am

(2)

unable to register the Title because
the records of the gazetting of the
Rocky Point and East Cooke roads have
never gone into the Land Registry Office

It would be a favor to have your
assistance in this matter.

yours very truly,

s.22

DEPARTMENT OF PUBLIC WORKS

FROM W. W. Bell, Temp Asst Engineer Langford, B. C.	TO H. D. Swan, Esq., District Engineer Victoria, B. C.	DATE Nov 12th, 1931. ELECTORAL DISTRICT Esquimalt OUR FILE YOUR FILE 4542
SUBJECT Rocky Point Road		REFERENCE YOUR LETTER

FOR DEPARTMENTAL AND INTERDEPARTMENTAL CORRESPONDENCE ONLY



This matter is of necessity held in abeyance, pending further instructions as to carrying on Relief work.

Noted

W. W. Bell

Temp Asst Engineer

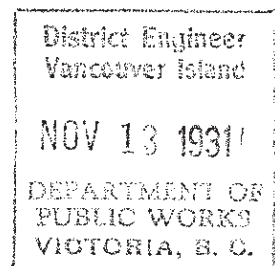

331507

Dist. E

Nov. 5th, 1931.

District
Engineer

W. W. Bell, Esq.,
Temp. Asst. Engineer,
Langford, B. C.

Esquimalt

4542

Rocky Point Road.

The Honorable H. H. Pooley has asked Hon. H. W. Bruhn to carry out some relief work on the Rocky Point Road.

The Minister has replied that the matter is being taken up with me. Please report what could be done here in removing bad corners, and keep the matter in mind for further consideration when relief work starts up.

DISTRICT ENGINEER.

HLB:CE

October 31st,
1931.

4562

Honourable R.H. Pooley,
Attorney General,
Buildings.

My dear Colleague:

I have to acknowledge receipt of your letter of the 28th instant, and in reply thereto would advise that this matter is being taken up with the District Engineer with the view of seeing what work we will be able to do along the lines suggested.

Yours faithfully,

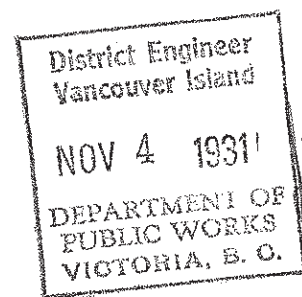

MR. SWAN

KINDLY ADVISE ME.



VICTORIA

Oct. 23th, 1931.

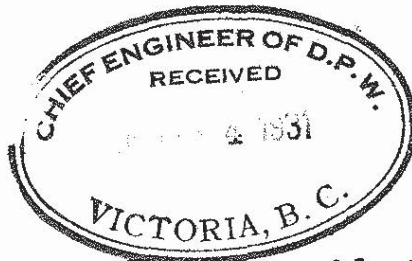

The Honourable R. W. Bruhn,
Minister of Public Works,
Buildings.

ASSISTANT CHIEF ENGINEER

OCT 30 1931

PUBLIC WORKS DEPT.
VICTORIA, B.C.

My dear Colleague:

I enclose copy of a letter which has
come to hand from the East Sooke Farmers' Institute,
asking that some of the relief money be spent in
widening some of the badcorners along the Rocky Point
road.

If anything can be done along these lines,
I should be much obliged.

Yours faithfully,

encl.

ASSISTANT CHIEF ENGINEER

OCT 30 1931

PUBLIC WORKS DEPT.
VICTORIA, B.C.

330470

BRITISH COLUMBIA FARMERS' INSTITUTES

EAST SOOKE INSTITUTE

R.M.D. 1, Victoria, B.C.

Oct. 24th, 1931.

Attorney General Pooley,
Parliament Bldgs.,
Victoria, B. C.

Dear Sir:-

At our meeting held on the 21st inst. I was instructed to write you asking if a portion of the relief money could not be spent in widening some of the bad corners along the Rocky Point road and generally improving same. Please see that this letter gets to the proper authorities.

Thanking you,

I remain,

Yours very truly,

"F. Reid"

Secretary.

April 18th,
1931

MEMORANDUM TO HONOURABLE L. H. POOLEY, K.C.,
Attorney-General, Buildings.

Relief Work at Rocky Point

Length of ditch -- 960 feet;
Size of ditch -- 2-1/2 ft. by 2-1/2 ft.

An old ditch, of approximately the same size, was filled in and a new ditch dug, giving an increased road width of 5 feet. The road is now 18 feet wide; it was formerly 13 feet.

Ditch walled up with rock, approximately 420 cubic yards being used for this purpose, at a cost of about \$1.10 per cubic yard in place.

The nearest rock on the road was on the East Brooke road, about four and one-half miles distant. To save expense, rock was taken from land adjacent to the ditch, owned by

s.22

s.22

s.22 On account of the fact that the land from which the rock was obtained was soft, it was necessary to use teams: four teams were hired locally, owned by
s.22 each of these teams was employed for about 10 days, at \$7.00 per day.

(forward)

- 2 -

The total expenditure on this piece of work was \$943.00, made up as follows:-

Excavation of ditch.....	\$223.00
Hauling rock and building in place....	\$460.00
Calvert.....	\$ 70.00
Blasting rock-corner and small ditch..	\$ 40.00
Gravelling.....	\$150.00
	<hr/>
	\$943.00
	<hr/>

One rock-man was employed from East Sooke district, as the Foreman claims it was impossible to get a rock-man in Rocky Point district who could do the work.

DISTRICT ENGINEER.

HLB:PB

13-20-132.

Lept. 56 4542



THE GOVERNMENT OF
THE PROVINCE OF BRITISH COLUMBIA

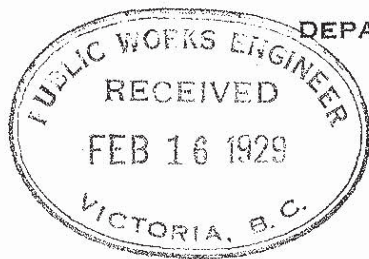

DEPARTMENT OF PUBLIC WORKS

DISTRICT ENGINEER'S OFFICE

Esquimalt District.
Rocky Point Road.
Smart's Hill.

4542

NOTED	1/16/29
ANSWERED	
ATTENDED TO	
FEB 16 1929	
OFFICE ENGINEER, PUBLIC WORKS DEPT. VICTORIA, B. C.	

Langford,
14th. February, 1929.

P. Philip Esq.,
Deputy Minister and Public Works Engineer,
Victoria, B.C.

Sir,

With reference to your letter of January 20th., folio 4542 re the above, I beg to report as follows. The ground, snow covered for the past 16 days, has held up this report.

The improvement at this particular hill would cost \$750.00 as under :

Removal of solid rock. Approx. 90 cub. yds @ \$2.	\$180.00
" " earth to widen, and make fill.	
Approx. 300 cub. yds. @ \$1.	300.00
Clearing, grubbing and grading	240.00
Altering existing fence.	30.00
	<u>\$750.00</u>

I would point out here that this section comes within the $2\frac{1}{2}$ mile stretch, from present end of tarvia surface to junction of Rocky Point and East Sooke Roads. Residents of that locality have asked the Department to improve, widen, & tarvia surface this section this spring.

I have shown the approximate cost of tarvia surface in my estimates for this year. (Please see Esquimalt District Bituminous surface Programme 1929-1930. New Work. Detail #3, our file 13-21-29).

254674 Copy to Mr. P. Philip

O. E.

2.

In my opinion, this section is too narrow and crooked at present to put tarvia on, and make a good job of it.

To widen and improve the $2\frac{1}{2}$ miles would cost approximately \$5,000.00, and if this improvement is to be carried out it would be better to put off the tarvia surfacing for next year as, even if widening job could be completed in time for May tarviating, it would be next to impossible to get a good job on account of green fills etc.

Kindly instruct.

Yours obediently,

G. A. Helgesen

G. General Foreman.

CAH/P.

4542

January 29th, 1929.

Esquimalt District
Road at Rocky Point.

Sir:

Herewith for immediate attention is copy of
letter from Honourable R.H. Pooley, Attorney General,
dated the 19th instant.

Yours obediently,

Deputy Minister and
Public Works Engineer.

C.A. Helgesen, Esq.,
General Foreman,
Langford P.O., V.I.

FLM:AL
encl.

4542

JAN. 25th
1929

Esquimalt District

Sir:

I enclose herewith copy of letter from Hon. R. H. Pooley dated the 19th instant in regard to the Rocky Point Road.

Kindly let me have a report on the conditions, with an estimate of the cost of making the necessary improvements.

Yours very truly,

Deputy Minister and
Public Works Engineer.

C. A. Helgesen, Esq.,
General Foreman,
Langford P. O.

PP:AW
encl.

JAN. 25th
1929

Hon. E. H. Pooley, E. C.,
Attorney-General,
Buildings.

My dear Colleague:

Many thanks for your letter of
the 19th instant with reference to accident on
the Rocky Point Road, also the East Sooke Road.

Both of these highways need con-
siderable work and this is a point I wish to
make with you, that before launching on any
new schemes our present highway system is en-
tirely inadequate.

I am having both the matters
you refer to investigated at once.

I am,
Yours faithfully,



VICTORIA, B. C.

JAN 24 1929

ANSWERED
JAN 19th, 1929

DEPUTY MINISTER AND
PUBLIC WORKS ENGINEER

ANSWERED

JAN 24 1929

The Honourable

The Minister of Public Works, VICTORIA, B. C.

Victoria, B. C.

My dear Colleague:-

My attention has been drawn to a motor accident which happened on the Rocky Point Road a short time ago on what is known as Smart's Hill, back of the old s.22 at Metchosin.

This is a steep grade, very narrow, and with two or three bad corners. The accident was caused by a motor car being shoved off the road, over the bank, by a truck. There was not room for both vehicles on the road. s.22

s.22

I know this place very well, and there is no question that it is dangerous; and I would suggest it be referred to Mr. Helgeson for report.

There is also another dangerous spot on the road along the side of Beechy Bay, after the road leaves the East Sooke turnoff. There again the road is very narrow, with a ditch on one side and the sea on the other.

I appreciate, of course, that these matters cannot be remedied at once, but I have the honour to draw them to your attention.

Yours faithfully,

Attorney General.

253575

PP

PROVINCE OF BRITISH COLUMBIA
DEPARTMENT OF PUBLIC WORKS

FROM District Engineer Victoria 368	TO O. G. Gallaher, Esq., Asst. Dist. Engineer, Burnside Road.	DATE May 16th, 1947 ELECTORAL DISTRICT Esquimalt OUR FILE 350 YOUR FILE 12-20-0
SUBJECT Beecher Bay Road		REFERENCE YOUR LETTER

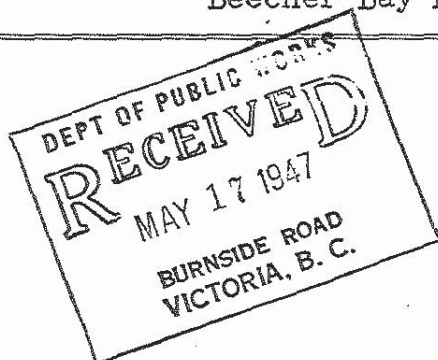

s.22 Recently I was advised by a s.22 that the road in from the East Sooke Road was Beecher Bay Road, and that Brown's Road was a short spur to the old house. There is a large sign at the junction of the East Sooke Road reading Beecher Bay Road, though this name does not appear on the Road Register.

The wall map shows Beecher Bay Road. Should we not make this change on our Road Register?

T. F. BAXTER,
Clerk for Dist. Engineer.

TFB:CE

March 10/47

Asst. Distl Engineer,
280 Burnside Rd. W.,
Victoria, B. C.

Mr. E. Smith,
District Engineer,
Victoria, B. C.

Esquimalt

12-20-0

350

Beecher Bay Road

March 4

Reference to the Honorable the Minister's report regarding the condition of Beecher Bay Road.

Two weeks ago the road crew inspected Beecher Bay Road and made minor maintenance repairs. At that time the foreman reported that this culvert was in difficulties, that is, was plugged up and the water was flowing over the road. However, no serious damage was being done.

When I inspected it on Friday, March 7th, I found that the road crew were then installing a new culvert.

O. G. CALLAHER
Asst. Dist. Engr.

OGG:JW

PROVINCE OF BRITISH COLUMBIA
DEPARTMENT OF PUBLIC WORKS

FROM District Engineer Victoria	TO O. G. Gallaher, Esq., Asst. Dist. Engineer, Burnside Road.	DATE March 4th, 1947. ELECTORAL DISTRICT Esquimalt OUR FILE 350 YOUR FILE
SUBJECT Beecher Bay Road		REFERENCE YOUR LETTER

FOR DEPARTMENTAL AND INTERDEPARTMENTAL CORRESPONDENCE ONLY

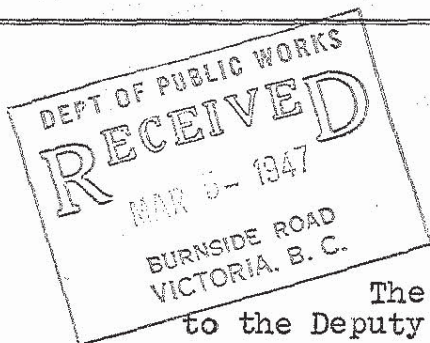

368

The Minister of Public Works has written
to the Deputy Minister as follows:-

"I was approached by one of the owners of property at Beecher Bay with regard to maintenance on the Beecher Bay Road leading from the east school roadway.

"Apparently there is a culvert near the top of the hill on this road which they say has been blocked for some time and this leads to a lot of trouble on the hill during the period of run off.

"Will you please have this matter checked?"

Please give this matter your attention and do what you consider necessary.

 E. SMITH,
 District Engineer.

TFB:CE

s.22

reports a

protection current on
Blicker Bay Road.

Says road is impassable
and that no work
has been done in the
road for the past
two years.

Asst. Dist. Engineer,
280 Burnside Rd. W.,
Victoria, B. C.

s.22

March 1/47

Esquimalt
12-20-0

368
Beecher Bay Road

It is reported that the Beecher Bay Road is in bad condition. In fact, it is reported to be impassable. This seems an exaggeration but I would ask you please to check it over, and if any work is necessary, attend to it.

O. G. GALLAHER

Asst. Dist. Engr.

HGG:JW

PROVINCE OF BRITISH COLUMBIA
DEPARTMENT OF PUBLIC WORKS

FROM District Engineer Victoria	TO O.G. Gallaher, Asst. Dist. Engr., 280 Burnside Rd.W., Victoria, B.C.	DATE January 5, 1948 ELECTORAL DISTRICT Esq. OUR FILE 350 YOUR FILE
SUBJECT Milne Road.		REFERENCE 12-20-0 YOUR LETTER

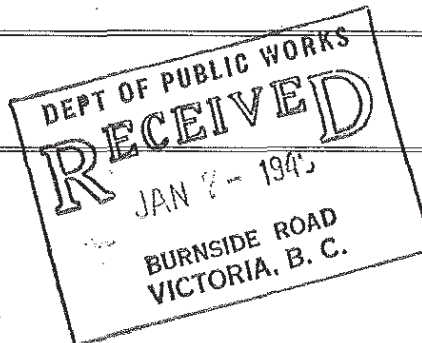

s.22 who lives at the end
of the above named road informed me
yesterday that a large wooden culvert
is in poor condition, apparently
half the topping has collapsed and the
other half appears to be in danger of
collapsing at an early date.

Please give this matter your attention.

E. SMITH,
District Engineer.

ES:MB



November 26th, 1947

Asst. Dist. Engineer,
280 Burnside Rd. W.,
Victoria, B. C.

Mr. E. Smith,
District Engineer,
Parliament Buildings,
Victoria, B. C.

Esquimalt

12-20-0

350

105
Milne Road

Nov. 22/47

I do not know how many permanent residents there are on this road but I do know that the road is built through the Indian Reserve and has no residents along its entire length and that the only property on which persons can live is at the end of the road belonging to

s.22

s.22

s.22 called me up two days ago and thanked me for the repairs to his road.

O. G. GALLNER,
Asst. Dist. Engr.

OCG:FH

PROVINCE OF BRITISH COLUMBIA
DEPARTMENT OF PUBLIC WORKS

FROM District Engineer Victoria	TO O. G. Gallaher, Esq., Asst. Dist. Engineer, Burnside Road.	DATE Nov. 22nd, 1947 ELECTORAL DISTRICT Esquimalt OUR FILE 350 YOUR FILE 12-20-0
SUBJECT Milne Road		REFERENCE Nov. 18th YOUR LETTER

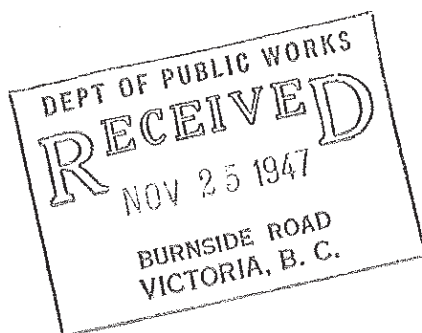

In connection with your report on the petition it is noted that you state that Milne Road is essentially a one-man road: at the same time, s.22 letter states that five families are represented in the petition, apparently all living on this comparatively short road.

Will you be good enough to inform me precisely how many permanent residents there are on this road.

E. SMITH,
District Engineer

ES:CE

Asst. Dist. Engineer,
280 Burnside Rd. W.,
Victoria, B. C.

Mr. E. Smith,
District Engineer,
Parliament Buildings,
Victoria, B. C.

November 18th, 1947

Esquimalt

12-20-0

350

Milne Road 105

Nov. 12/47

With reference to the petition, of 15 residents for widening and repairs to Milne Road. I have examined this road and, at the present time, the Local Foreman is gravelling those sections that need it.

Milne Road is essentially a one man road and I do not think that there is any urgent necessity that it be widened. although apparently, at the present time, s.22 in operation at the end of this road and thus it is practically impossible for the Department to maintain bush roads during the winter when subjected to heavy logging traffic. I recommend that nothing further than maintenance be done on this road until we have reason to believe that there is a permanent settlement at the end of it.

O. G. GALLAHER
Asst. Dist. Engr.

OGG:PH

PROVINCE OF BRITISH COLUMBIA
DEPARTMENT OF PUBLIC WORKS

FROM District Engineer Victoria	TO O. G. Gallaher, Esq., Asst. Dist. Engineer, Burnside Road.	DATE Nov. 12th, 1947 ELECTORAL DISTRICT Esquimalt OUR FILE 350 YOUR FILE
SUBJECT Milne Road		REFERENCE YOUR LETTER

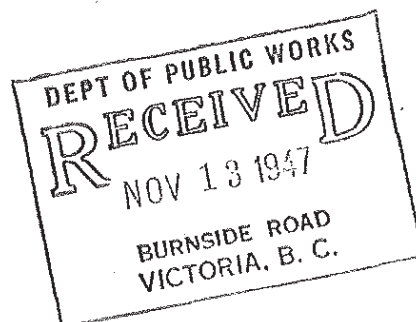

A petition has been received by the Deputy Minister signed by 15 residents of Speyside on Milne Road at Becher Bay, requesting that immediate steps be taken to repair and widen Milne Road.

Please let me have your report.

E. SMITH,
District Engineer

ES:CE

Copy for information of O. G. Gallaher, Esq.,
Asst. Dist. Engineer,
Burnside Road.

File 4542

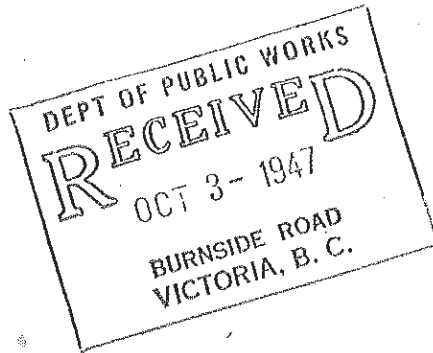

Victoria, B.C.,
Oct. 2nd, 1947.

Re: Condition of Milne Road

Sir:

Your letter of September 24th to the Deputy Minister was referred to me in his absence. I am taking the matter up with the Asst. Dist. Engineer and you will be advised as to what can be done.

All our men and equipment in the Esquimalt District are exceedingly busy, but I hope the provision may be made to carry out the necessary work on the Milne Road.

Yours very truly,

E. SMITH,
District Engineer

s.22

ES:CE

C
O
P
Y

s.22

24 Sept. 47

Deputy Minister,
Dept. of Public Works,
Victoria, B.C.

Dear Sir:

I am enclosing a clipping from today's Colonist which is of considerable interest to us, since we use the crossing in question several times a week, and have had some exceedingly narrow escapes from death. Would you care to have this looked into?

The purpose of this letter is to request that you have the question of Milne Road investigated. This is a small, short provincial road leading across the Becher Bay Indian Reserve, and in its original condition was suitable for one family living at the end.

Now, however, there are four families and ten men living at the end, and the road is used by six to eight trucks a day, and at least as many passenger cars. It is winding and hilly, and there is no suitable passing point along its entire length of half a mile. May steps be taken to have the road widened so that vehicles may pass? A bulldozer could do it in three hours easily.

I have contacted your Mr. Gallaher three times by letter and he states he is much too busy elsewhere, and also cannot pay to have a private bulldozer do the work. I would deeply appreciate it if you could at least have the matter investigated and a date set when the work could be done. It is urgently required now.

Yours truly,

s.22

Copy for information of O. G. Gallahue, Esq.,
Asst. Dist. Engineer,
Burnside Road.

105
File 350

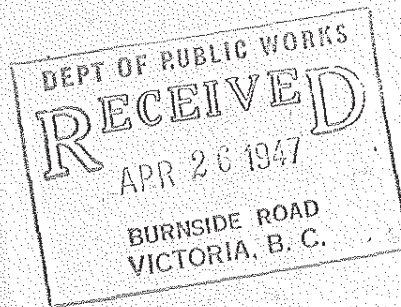

Victoria, B.C.,
April 25th, 1947.

Re: Milne Road, Beecher Bay Indian Reserve
No. 1

Sir:

In reply to your letter of April 23rd, I beg to advise you that a cheque for s.17, s.22 in payment for land acquired from the Indians for this road, was sent to Mr. W. P. Robertson, Indian Agent at Duncan, November, 1917, for 2,205 feet by 33 ft. wide, plus one-half of 175 ft. by 33 ft. wide, or a total of 1.74 acres, as shown on plan mailed to Mr. Robertson.

Yours very truly,

E. SMITH,
District Engineer

Mr. R. B. Moore,
Indian Agent,
Duncan, B. C.

TFB:CE

[Handwritten signature]

Asst. Dist. Engineer,
280 Burnside Rd. W.,
Victoria, B. C.

Thornett
~~Mr. E. Smith,~~
~~District Engineer,~~
~~Victoria, B. C.~~

March 28/47

Esquimalt
12-20-0

Milne Road) 05

Please make the necessary repairs
to the Milne Road at your earliest conven-
ience.

O. G. GALLAHER

Asst. Dist. Engr.

OGG:JW

PROVINCE OF BRITISH COLUMBIA
DEPARTMENT OF PUBLIC WORKS

<p style="text-align: center;">FROM</p> <p>District Engineer Victoria</p>	<p style="text-align: center;">TO</p> <p>O. G. Gallaher, Esq., Asst. Dist. Engineer, Burnside Road.</p>	<p>DATE March 21, 1947</p> <p>ELECTORAL DISTRICT Esquimalt</p> <p>OUR FILE 350</p> <p>YOUR FILE</p>
<p style="text-align: center;">SUBJECT</p> <p>Culvert - Milne Road 105</p>		<p>REFERENCE</p> <p>YOUR LETTER</p>

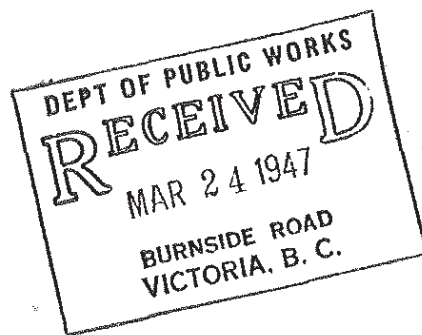

FOR DEPARTMENTAL AND INTERDEPARTMENTAL CORRESPONDENCE ONLY

s.22

s.22

s.22 called at this office today and complained that a culvert on this road is partially washed out.

Kindly look into this matter and carry out such repairs as are necessary.

s.22

s.22 requested that you call on him when in this vicinity.

E. Smith
E. SMITH,
District Engineer.

CE

25/3/47

Burnside, Victoria, B. C.,
January 20th, 1940.

s.22

Dear Sir:

I have received a complaint regarding the condition of Milne Road, a branch from East Sooke Road to Beecher Bay.

It is stated that your logging operation has destroyed the road for other users.

Will you kindly advise me as to when you will have finished your operation, and of your intentions towards repairing it.

Yours truly,

Asst. District Engineer.

HMB/DW

s.22

Charles (Indians)

s.22

s.22

just working
for them.

s.22

~~are~~ all going to

fix road.

OK

PLAN
of Proposed Road from
the
Sooke Road
to
Beecher Bay
Through Sections 46, 45 & 50
Merchosisin Dist.

V. I.
Scale 100 ft = 1 inch.

FILE 350

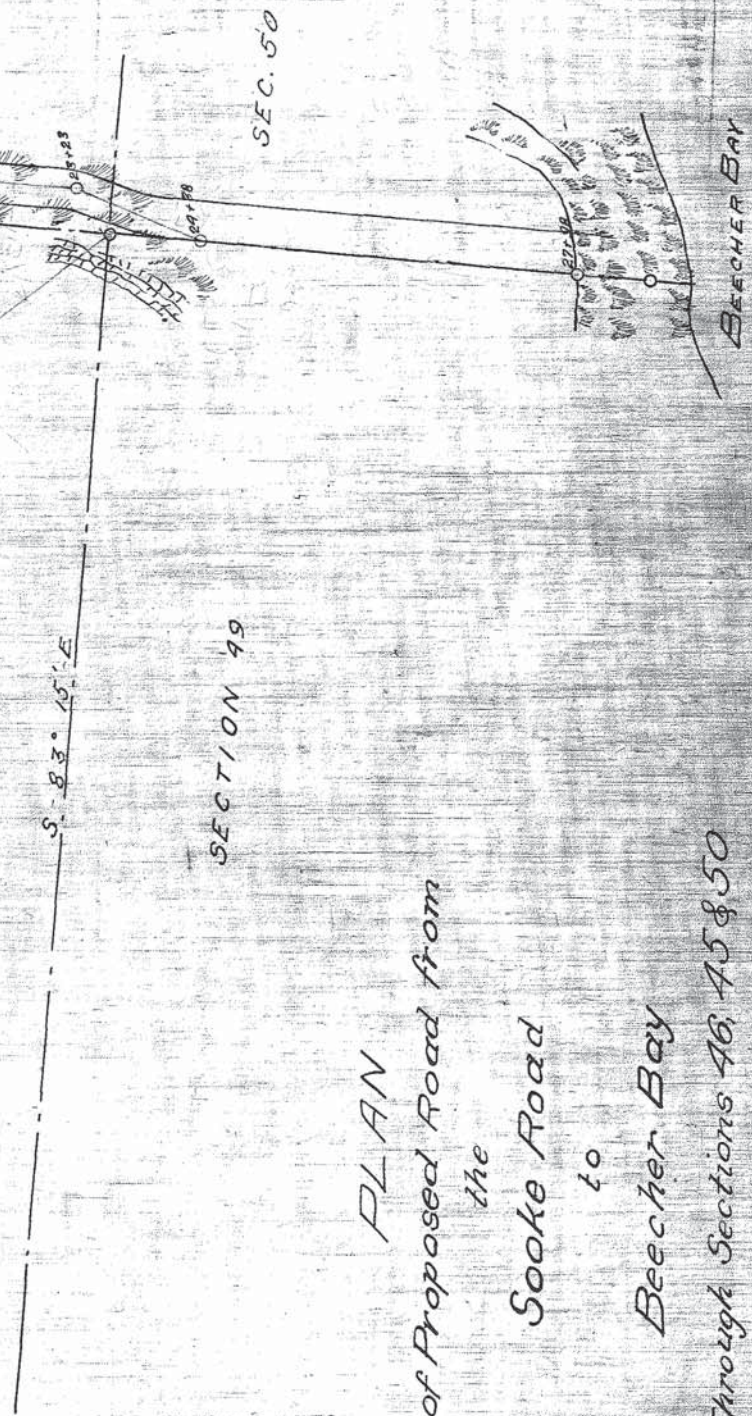

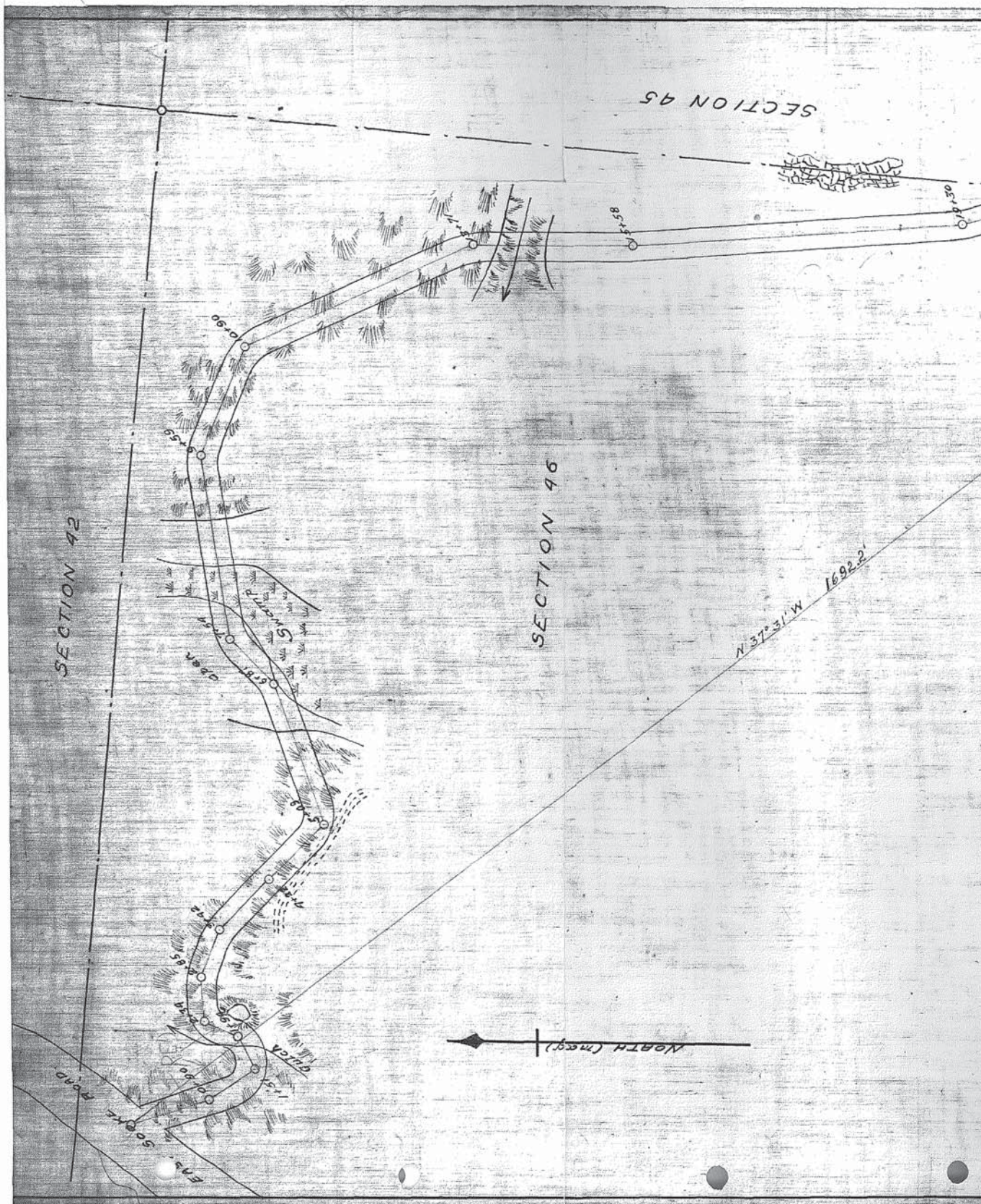

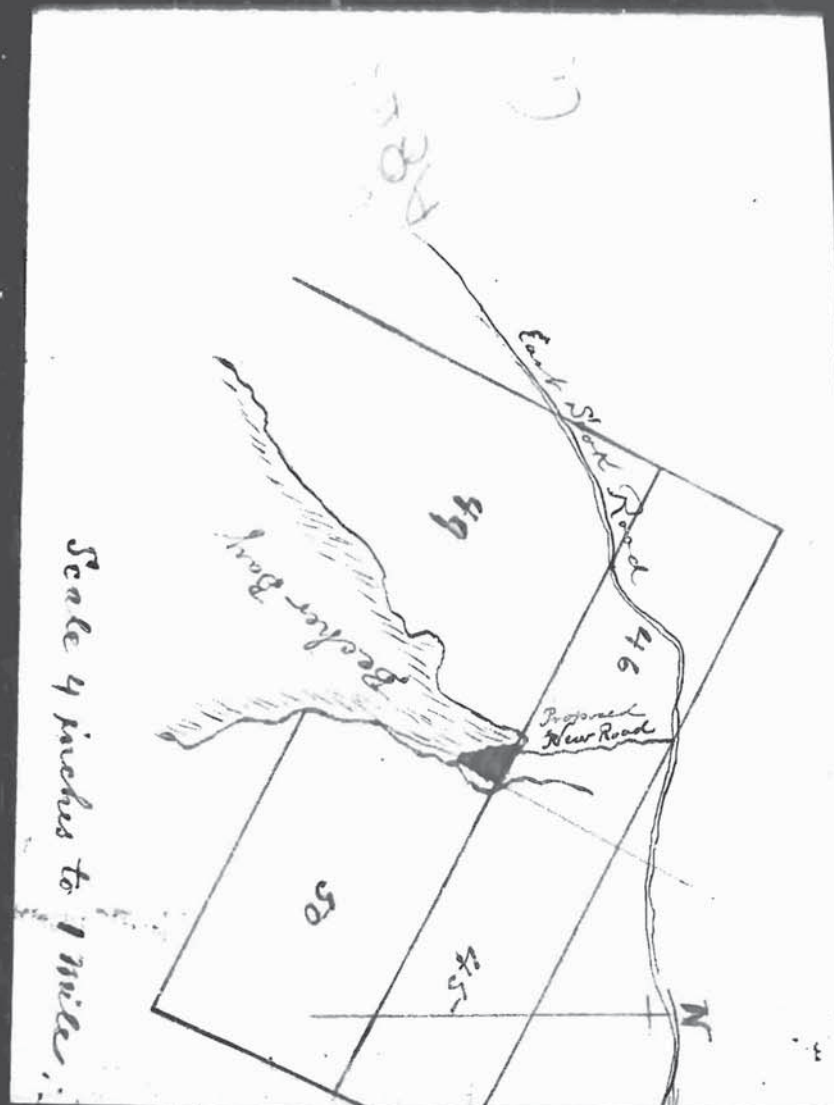

4
s.22

s.22

April 9th, 1912.

Hon. Thomas Taylor,
Chief Commissioner of Lands & Works, British Columbia,
Parliament Buildings, Victoria, B.C.

Sir,

R. S. & B.

DEPARTMENT DIST.

s.22

s.22

The

road required is only about a quarter of a mile across the Indian Reserve, and I have consulted the Indians, and they are desirous of having a road opened to Becher Bay.

s.22

s.22 at the head of Becher Bay, but it is impossible to get into this part except by water.

Your Road Superintendent, Mr Campbell, has been over the ground with me, and he maintains the road can be easily built.

I trust you will give this your early and favourable consideration. Mr Campbell will give you any further information you may desire, as he has been carefully over the ground.

Hoping to have a favourable reply,

PUBLIC WORK ENGINEER

I am,

Yours respectfully,

s.22

APR 16 1912
VICTORIA, B. C.

P.S. I enclose a small sketch, which will show you the point I refer to, and, on comparing same with a larger map, you will find it about correct. I have marked the proposed road in red ink.

s.22

350.

6
April 16, 1912.

Esquimaux District.

Sir:-

Referring to your letter of the 9th instant, respecting the construction of a road from the East Hooke road to the head of Pedder Bay, I may inform you that the Road Superintendent has been requested to see you and report as to your requirements.

Yours obediently,

Public Works Engineer

s.22

AM/AP.

Department File No.....
When replying refer to
District Office File No.....

7



FILE No. 350

ROAD SUPERINTENDENT'S OFFICE,

Box 28 Thoburn, P.O.

Esquimalt District

Victoria B.C.

R. S. & B. April 22 1912

ESQUIMALT DIST.

Sir

In reply to your letter of April 11th I went over the ground in company with s.22 and saw where he wants the proposed road. At one time there was a pack trail leading from the East Sooke road to an s.22 which has grown over with under growth. The distance is about one half mile and would cost about \$800.00 dollars to make a decent wagon road to his place. Please note that this road runs through Indian reserve and probably permission would have to be got although the Indians in the vicinity are greatly in favour of the projected road.

I have the honour to be

Sir

Your obedient servant

MEMO ATTACHED.

MEMO ATTACHED.

R. J. Campbell
Road Superintendent

W. W. Foster Esq.

Deputy Minister of Public Works

Victoria B.C.

REFER TO FILE NO. 350



8
PUBLIC WORKS DEPARTMENT
(OFFICE OF THE DEPUTY MINISTER).

VICTORIA, 2nd May, 12.



Ksquamalt District.

Memo. for the Public Works Engineer.

Kindly note the attached letter, and advise if the road asked for by s.22 is not practically identical with another application before verbally discussed.

Deputy Minister of Public Works.

Indian Office

9

At Duncane Station, B. C.

May 7th, 1912.

19.

MEMO.

s.22

s.22

s.22



ATTACH TO FILE 350

In reply to yours of the 6th, instant in reference to a proposed public road through Section 46 a part of the Beecher Bay Indian Reserve. I beg to say I have not the authority to give the consent necessary to construct this road. In order to obtain it, you will have to make an application and plan, in duplicate, the plan must be drawn to scale and show the exact location of the road that is the distance from the nearest corner post to the center of the proposed road where it enters and leaves the reserve, the width of the road and the total area required. I will refer you to Section 46 of the Indian Act as amended 1911. The plans must be made on tracing cloth.

There is nothing to show in this office that there ever was a road there, as stated by you.

On receipt of your application and plan I will send the same to the Department for approval.

Yours obediently

H. R. Robinson
Indian Agent.

10
350.

May 9th, 1912.

Esquimaux District
Road to Beechar Bay.

Memo for The Deputy Minister of Public Works.

The road asked for by s.22 is entirely for his own purposes. I was over this so called trail the other day with the Road Superintendent; it will cost over \$800 to put in a rough road.

Public Works Engineer.

J.B.G./M.B.

REFER TO
FILE No. 350



11
FILE No. 350
PUBLIC WORKS DEPARTMENT
(OFFICE OF THE DEPUTY MINISTER).

VICTORIA, 16th May, 1912.



Esquimalt District.

R. S. & B.
ESQUIMALT DIST.

Memo. for the Public Works Engineer.

As the road asked for by s.22 is for his own purpose only, and no money was provided in the estimates, it cannot be constructed this year.

Deputy Minister of Public Works.

12

350.

May 28, 1912.

Esquimalt District.

Sir:-

Supplementary to my letter of the 16th ultimo, I have now to say that as no provision was made in the estimate for this road, and as it is merely for your own use, the work cannot be undertaken this year.

Yours obediently,

Public Works Engineer.

s.22

/s/

REFER TO
FILE NO. 388



THE GOVERNMENT OF
THE PROVINCE OF BRITISH COLUMBIA

13 FILE NO. 388
PUBLIC WORKS DEPARTMENT
(OFFICE OF THE DEPUTY MINISTER)

VICTORIA, 14th June, 1912

Esquimalt District.

R. S. & B.

ESQUIMALT DIST.

Memo. for the Public Works Engineer.

In connection with your letter of the 30th, I noted when on the ground, the desirability of changing the grade in question, and quite agree with you that the work should be done as soon as possible.

Be good enough to obtain the necessary authority from the Indian Department and then if funds will permit, the work can be undertaken this year.

W. A. Foster

Deputy Minister of Public Works.

Note re s.22 road what the Indians offered to do. file 350

REFER TO
FILE NO. 350



14
PUBLIC WORKS DEPARTMENT
(OFFICE OF THE DEPUTY MINISTER)

350
14th June, 1912
VICTORIA.

Esquimalt District.

Memo. for the Public Works Engineer.

R. S. & B.
ESQUIMALT DIST.

In connection with s.22 road, I understand that the Indians in the vicinity are very anxious to have this constructed, and are willing to provide the right-of-way required for the diversion of the main road without trouble, providing this request is acceded to.

If you find this to be the case, it might be well to confer with them along these lines, and then possibly s.22 would pay half the cost of the road, as he is the party chiefly benefited.

H. W. Foster
Deputy Minister of Public Works.

3035

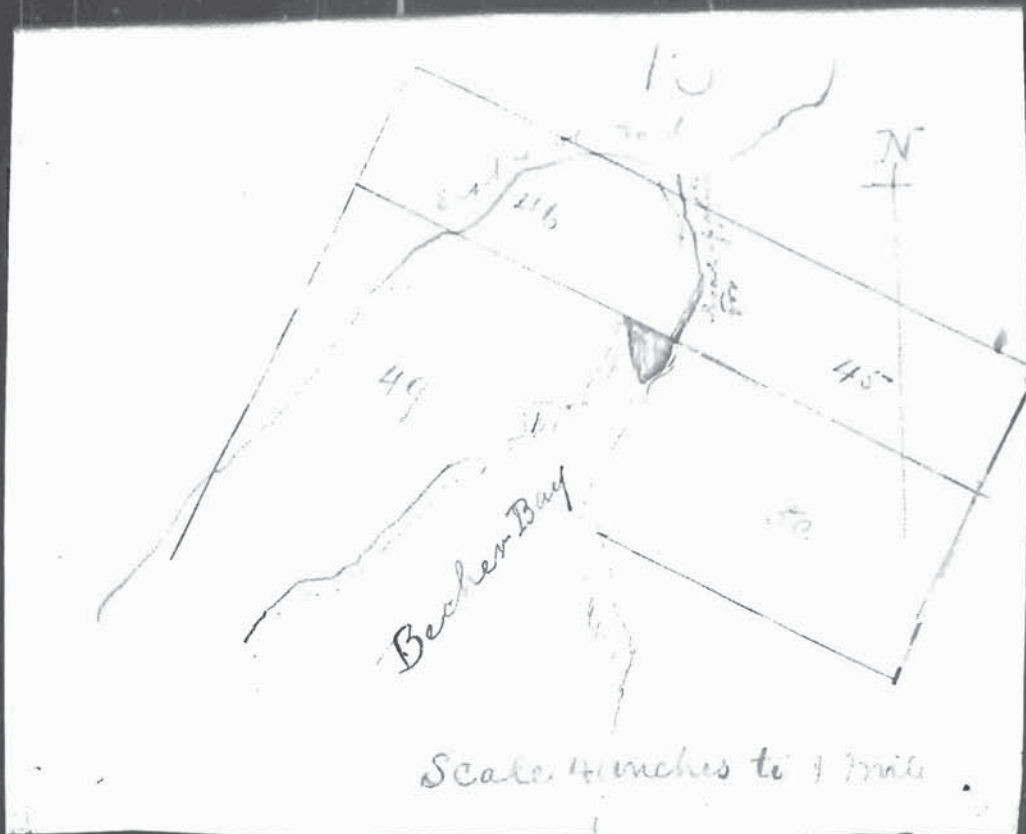

Booley, Luxton & Booley
Barristers at Law

SOLICITORS, NOTARIES,

C.E. Booley, M.C. A.P. Luxton, M.C.

CHANCERY CHAMBERS

LANGLEY STREET

FILE No. - 3035

Reevey, Luxton & Reevey
Barristers at Law
SOLICITORS, NOTARIES.

C. E. Reevey, B.C. A. P. Luxton, B.C.
R. H. Reevey
CABLE ADDRESS: LEGALISTS

16
CHANCERY CHAMBERS,
LANGLEY ST.

FILE No. 350

Victoria, B.C. June 20th, 1912. 191

R. S. & B.
ESQUIMALT DIST.

Deputy Minister of Works,
Government Buildings,
Victoria, B.C.

Dear Mr Foster:-

I enclose a sketch of a road, which

s.22

s.22

It appears that

this property was an old mineral claim, and there was formerly a road built into it. This is now grown up, and he requests that this road be opened. May I ask that the Road Superintendent be requested to report.

Yours truly,

R. H. Reevey

RHP/CMS

17
550.

June 28th, 1912.

Maginist District.
Road to Beecher Bay.

Sir:-

With further reference to the road which you made request to have built, the approximate cost of the same will be about \$800. Kindly let me know whether you are prepared to pay half the cost.

Yours obediently,

Public Works Engineer.

s.22

J.V.C./M.E.

350.

18

June 28th, 1912.

Bequimalt District.
Road to Beecher Bay.

Sir:-

Referring to your communication of the 20th instant, I think the road is the same as the one which
s.22 is applying to have built - as it passes an old mineral claim. The estimate of cost of the road is about \$800 and I have written s.22 to ask if he could pay half the cost.

Yours obediently,

Public Works Engineer.

R. H. Pooley, Esq., M.P.P.,
Chancery Chambers,
Victoria, B. C.

J.E.G. M.E.

19
W. A. MORRISON
CITY CLERK

FILE No. 3-70 R. B. DIER, MAYOR

CORPORATION OF THE CITY OF LADYSMITH

CITY CLERK'S OFFICE

LADYSMITH, B. C., June 25th 1912.

The Hon. Thomas Taylor,
Minister of Public Works,

R. S. & B.
ESQUIMAULT DIST.

VICTORIA B. C.

Sir:-

With reference to my conversation, with you this even date
beg to state, that s.22 is interested in a property with s.22
on Beecher Bay, on which they have erected a Summer-home.

At the present time there is no road leading to the property from
the Sooke Road.

s.22 at the present writing and is desirous of res-
iding there during the Summer months, I earnestly request that you will
use your best endeavours to have a road run into the property at an ea-
rly date.

May add that some years ago a roadway connected the property with the
Sooke Road, but is now overgrown.

An ordinary bush - road would answer all purposes. I have sent a
Plan of the desired road to Mr. Pooley M. P. P., and also wish to state
that the Road Superintendent of the District is conversant with this ma-
tter.

Hoping that you will give this request your immediate attention, and
thanking you in advance for same, I remain

Yours truly,

s.22

588.

20

July 2nd, 1918.

Requimalt District.

East Sooke Road.

Sir:-

Referring to your communication of the 17th May regarding the change of road through the Indian Reservation, estimated cost \$2000.00, will you kindly see the Indians and also the Indian Agent to see whether they are willing for us to make this change. I would like to have this matter attended to as soon as possible.

Yours obediently,

Public Works Engineer.

P. J. Campbell, Esq.,

Road Superintendent,

P. O. Box 23,

Thoburn, B. C.

J.P.G./N.P.

21
FILE No. 350

s.22

s.22

4th July, 1912.

J. H. Griffiths, Esq.,
Public Works Engineer,
Parliament Buildings,
Victoria, B.C.

R. S. & B.
ESQUIMALT DIST.

Dear Sir,

In reply to your letter of the 29th ultimo in reference to a road to be constructed to the head of Teesby Bay from the East Sooke Road, which is estimated to cost approximately \$300.00, I agree to pay half of the cost of same, as suggested by you.

Yours truly,

s.22

REFER TO
FILE NO. 350.



FILE No. 350

PUBLIC WORKS DEPARTMENT
(OFFICE OF THE MINISTER)

VICTORIA, 18th July/12.

22

R. S. & B.

~~QUIDMALT DIST.~~



Memo for Public Works Engineer.

Please refer to Indian Agent Robertson's letter attached, addressed to s.22 , under date of May 7th, and have him comply with instructions contained therein. When the consent of the Indian Department is received, then work can proceed, the Government paying one-half the cost and s.22 the same.

Minister of Public Works.

F. A. Devereux, C. E.

British Columbia Land
Surveyor

P. O. Box 308



J. E. Gifford
Eng of Public Works
City.

Copy

23
FILE No. 350

PHONE 1370
RES. PHONE 529

LAW CHAMBERS

Victoria, B.C.

July 22 1912

R. S. & B.
ESQUIMALT DIST

Sir.

I beg to enclose herewith a plan, profile & the estimated cost of constructing a branch road from the East-Cooke road to Beecher Bay T. I. through sections 45, 46 & 50 Huxthorn Dist.

No part of the existing old road can be utilized as the grades are excessive.

The estimated cost of constructing a road 10 feet in width is \$1500 exclusive of surfacing.

Yours truly,

James Gifford
F. A. Devereux.

350.

24

July 26, 1912.

Esquimalt District.

Road to Beecher Bay.

Sir:-

Kindly arrange to make a survey from the Cooke
Road to s.22 place at Beecher Bay through the end
of Reservation, and furnish me with three plans, (two on
tracing cloth). If you will kindly see Road Superinten-
dent Campbell, he will be able to give you full particulars.

Yours obediently,

Public Works Engineer.

F. A. Devoreux, Esq., B.T.L.S.,
Langley Street,
Victoria, B. C.

J.R.G./M.B.

25

350.

July 31st, 1912.

Esquimalt District.
Road to Beecher Bay.

Sir:-

With reference to your communication of the
7th May to s.22 I am sending you under separate
cover, plans in duplicate of the location of the road.

For your information I may say that both the
Government and s.22 will defray half the expenses
of construction.

For further information please see table
attached to plan and profile.

Yours obediently,

Public Works Engineer.

W. R. Robertson, Esq.,

Indian Agent.

Duncan, B. C.

J.E.G./M.T.

x

26
SEC.

1st August, 1912.

Esquimaux District.

Proposed Road from East Spoke Road to Beecher Bay.

Memo. for The Public Works Engineer.

From Traverse Table: "The Road is 2844 feet in length and is 33 feet in width extending 16½ feet on either side of location line, except along the Section line between Sections 49 and 50 where the road extends 33 feet to the east of said Section line."

Area of road 2.15 acres.)

Signed G. M. Dunsen

G.M.D./M.P.

Indian Office

FILE No. 350

At Duncan Station, B. C.

Aug. 5, 1912.

19

MEMO.

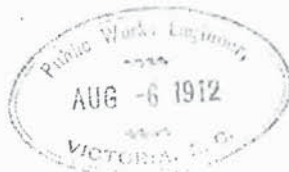

R. S. & B.
ESQUIMALT DIST.

Sir:-

Yours of the 31st, ultime enclosing plan of proposed road through Sections 46 and 45 Metohosin District, being part of Beecher Bay Indian Reserve, to hand. In reply I beg to say I am forwarding the same for the approval of the Department.

I do not quite understand your remark that the Government and s.22 will defray half the expenses of construction. Do you expect the Indians to pay the other half?

Yours obediently

H. R. Robinson

Indian Agent.

J. E. Griffith, Esq.,

Public Works Engineer,

Victoria, B. C.

PUBLIC WORKS ENGINEER

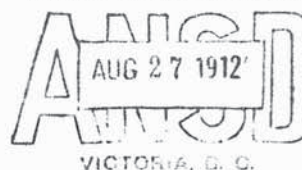

350.

28

January 30, 1913.

Esquimalt District.

Sir:-

In reference to the road to Beecher Bay, towards
which ^{s.22} was to pay half the cost, I understood
you to say that the work was completed. Kindly confirm
this by letter stating the cost which was estimated at
\$800.00.

Yours obediently,

Public Works Engineer.

P.J. Campbell, Esq.,

Road Superintendent,

Box 28, Thoburn, B.C.

AH/AP.

When replying refer to
District Office File No.

Department File No.



THE GOVERNMENT OF
THE PROVINCE OF BRITISH COLUMBIA

29 FILE No. 350
ROAD SUPERINTENDENT'S OFFICE,

Jan 31. 1913. 191

Thoburn.

R. S. W.

ESQUIMALT DIST.

Sir,

Replying to your letter of 30 inst, \$350 re s.22
road to Beecher Bay, I beg to submit the total cost of road
and bridge erected thereon

Cost of road	\$ 614.35
" " Bridge	151.00
Total	<u>965.35</u>

I have the honour to be

Sir,

Your obedient servant

R. S. W.
Road Supt.

J. E. Griffith Esq.

Public Works Engineer

Victoria.

350.

30

February 6, 1913.

Esquimalt District.

Sir:-

Having reference to your letter of the 4th July last, the cost of constructing the road from the East Sooke Road to Beecher Bay is \$968.36, and I would ask you that you favour me with your cheque for half this amount.

Yours obediently,

Public Works Engineer.

s.22

AH/AP.

31

FILE No. 350



s.22

s.22

Feb. 19th, 1913.

R. S. & B.
ESQUIMALT DIST.

J. E. Griffiths, Esq.,
Public Works Department,
City.

Dear Sir,

In reply to yours of the 4th instant having reference to the construction of a road from the East Fork Road to Beaches Bay, costing \$968-35, I herewith enclose cheque for \$484.13, being half the cost of said road, in accordance with my promise last summer.

In order to make the road passable, a few more loads of gravel would be required, and I trust your Inspector will be authorized to lay down this when the season is favorable.

Yours truly,

s.22

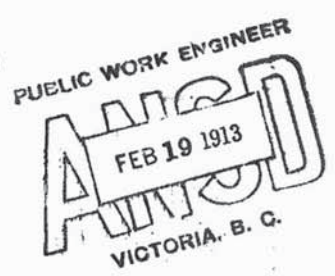

3.50

32

Mr Rolston

20th Feby 1913

Credit Note 120 Esquimaux Dist
with "484" 18

Refund for work done on
Becher Bay Road

A.H.

s.22

33

33

350.

February 20, 1913.

Esquimalt District.
for Road West Sooke-Becher Bay.

Sir:-

I beg to acknowledge receipt of your letter of the 17th instant, with cheque. I am writing the Road Superintendent to have the road made passable.

Yours obediently,

Public Works Engineer.

s.22

AN/AP.

34

350.

February 20, 1913.

Taguimaht District.
Road East Cooke-Beecher Bay.

Sir:-

s.22 in remitting his cheque for the Beecher Bay
roadwork requests that a few more loads of gravel be put
on to make the road passable. Kindly have this done.

Yours obediently,

Public Works Engineer.

P.J. Campbell, Esq.,
Road Superintendent,
Box 23, Choburn, N.S.

AH/AB.

When replying refer to
District Office File No.

Department File No.



THE GOVERNMENT OF
THE PROVINCE OF BRITISH COLUMBIA

35 FILE No. 350

ROAD SUPERINTENDENT'S OFFICE.

Feb 21. 1913. 191

Thoburn.

R. S. W.
ESQUIMALT DIST.

R. S. & B.
ESQUIMALT DIST.

Sir,

Replying to your letter of Feb 20, #350 re s.22 Road
The gravelling referred to shall be done at once

Yours obediently

P. I. Campbell
Road Supt.

J. E. Griffith Esq.

Public Works Engineer

Victoria.

FILE No. _____



VICTORIA, May 29th 1916
BRITISH COLUMBIA

Hon Thomas Taylor
Minister of Works

R. S. & B.

Dear Sir

Re Becher Bay Road **ESQUIMALT DIST.**

As to our conversation this morning concerning
some repairs on the Becher Bay Road from s.22 corner
East Sooke Road to s.22 The brush have grown up close
to the wheel tracks and it is most impossible to get through with
a car without scratching it up with the brush And some of the sha
rpecurves could be taken out without very much extra expense

Remain Yours

s.22

37

May 30, 1916.

Esquimalt District.

Dear Sir:-

I beg to acknowledge receipt of your favour of the 29th inst., in regard to certain repairs to the Becher Bay Road, and have to say in reply that the matter is receiving the attention of the Department.

I have the honour to be,

Sir,

Your obedient servant,

Minister of Public Works.

s.22

REFER TO
FILE NO.



PUBLIC WORKS DEPARTMENT
(OFFICE OF THE MINISTER)

VICTORIA, May 30, 1916.

Esquimalt District.

R. S. & B.
ESQUIMALT DIST.

Memo. for the Deputy Minister & Public Works Engineer.

Be good enough to have Mr. Trowse look into
the matter of the attached letter from s.22
as soon as he takes over the work in the Esquimalt
District.

[Signature]
Minister of Public Works.

Enc.

ASSISTANT PUBLIC WORKS ENGINEER

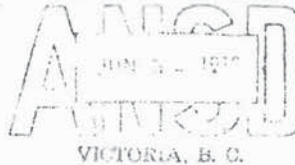

*Produced in order
for Mr. Trowse
and on his work
June 2*

12
[Handwritten marks]

FILE No. 340

Reference No.30

Cowichan Agency

Indian Office

Duncans Station, B. C. June 26, 1917.

663 -J-2

ESQUIMALT DIST.

Sir:-

Having reference to the construction of a road through portions of Sections 45 & 46, Metchosin District, being a part of the Beecher Bay Indian Reserve, by the Provincial Government, during ~~September~~ of 1912.

According to the plan submitted calling for road 33 feet wide, it shows that the area taken is A.2.074 which is valued at s.17 per A. s.17
The improvements on this area are owned by an Indian s.22 and consists of cleared land A.0151 s.17 per Acre s.17

The road referred to is the one going to s.22

s.22 I can assure you that the amount asked for is quite reasonable and just, and the amount should have been paid before the construction of the road, however I trust that you will favor me with a cheque for the above amount so that the matter can be settled with the Indians.

Your obedient servant

Indian Agent.

J. E. Griffith, Esq.,

Public Works Engineer.

Victoria, B. C.

40
588 & 350

June 28th, 1917.

Esquimalt District.

Re: ~~Diversification of East Sooke Road:~~

Beecher Bay Road

Sir:-

I wish to acknowledge receipt of your letters of the 26th instant, in further reference to the claim of the Indians of the Beecher Bay Reserve for compensation on account of land taken in constructing the above diversion, and also for that taken for the right-of-way of the Beecher Bay Road, including improvements, etc., and beg to say that I am very much surprised that this matter has not been brought to the attention of the Department before.

I can find nothing on our files to indicate that any claim has been presented to the Department before in this connection, and I am sure you must realize that it would be impossible for me to authorize the payments of the amounts asked for without going further into the matter.

There is no intention on my part to question the accuracy of your statement as to the various amounts set forth in your letter, but I am quite sure that the Auditor-General would require further details and a state-

W.R. Robertson, Esq.,
Indian Agent,
Duncan, B.C.

WXG:AP.

41
- 2 -

ment from this Department, which we have not to hand,
before passing this account, even if it was authorized
by me.

Yours obediently,

Public Works Engineer.

350.

42

May 30th, 1918.

Esquimalt District.

Beecher Bay Road, through Beecher
Bay Indian Reserve.
.....

Sir:-

With reference to yours of the 13th and 18th ultimo, I now beg to forward you, under separate cover, the requested tracing and blue print. Description, in duplicate, of the road referred to is enclosed herewith.

The discrepancies mentioned in yours of the 13th ultimo, appear to be due to the fact that in your calculations you included a portion of the road which was not within the Indian Reserve.

As it was found while making a further survey on the ground, that the blue print sent you on the 10th ultimo contained several errors, this plan is not being returned to you, as requested.

Yours obediently,

Public Works Engineer.

W.R. Robertson, Esq.,

Encl.

Indian Agent,

Duncan, B.C.

M/JMT.

588.

43

May 30th, 1918.

Re diversion East Sooke Road and
Beecher Bay Road, through Indian Reserve.

Sir:-

Adverting to yours of January 9th last, under separate cover I am forwarding tracing and blue print of the above road. Enclosed herewith, in duplicate is description of this road.

Yours obediently,

Public Works Engineer.

Encls.

W. E. Robertson, Esq.,
Indian Agent,
DUNCAN, B.C.

M/JMT.

File 350.

44

ESQUIMALT DISTRICT.

.....

Description of the Beecher Bay Road through Beecher Bay
Indian Reserve No. 1, and a portion of Section 50.

Commencing at a point on the East Sooke Road, which point
is South 88° 07' West, and 1194 feet more or less, from a
post on the Northern boundary of Beecher Bay Indian Reserve
No. 1, at the North East corner of Section 46, thence as
per attached plan for a distance of 2413.6 feet more or less.

Area of Right of Way in Indian Reserve.

2205 feet 33 feet wide	1.67 acres
plus one half of 176 feet, 33 feet wide	.07 "

Total	1.74 "
-------	--------

ESQUIMALT DISTRICT.

..... 45

mine

Description of the ~~Beecher Bay~~ road through Beecher Bay
Indian Reserve No. 1, and a portion of Section 50.

Commencing at a point on the East Sooke Road, which point
is South $88^{\circ} 07'$ West, and 1194 feet more or less, from a
post on the Northern boundary of Beecher Bay Indian Reserve
No. 1, at the North East corner of Section 46, thence as
per attached plan for a distance of 2413.6 feet more or less.

Area of Right of Way in Indian Reserve.

2205 feet 33 feet wide	1.07 acres
plus one half of 175 feet, 33 feet wide	.07 "

Total 1.74 "

222 1/2

One blue print and
one tracing, for-
warded under separ-
ate cover.

20/8/18.

46
Indian Office

At Duncan Station, B. C.

June 3, 1918

19.

MEMO.

File No. 350

Becher Bay Road, through Indian Reserve.

P. S. A. P.

Dear Sir:-

ESQUIMALT DIST.

Having reference to yours of the 30th, ultimo, you state that you are sending, under separate cover tracing and blue print, of the road above referred to.

As they have not come to hand, I will thank you to make enquiries and if they were posted then ask the post office to trace them.

And oblige.

Yours obediently

G. G. G. G.
Indian Agent.

A. B. Foreman, Esq.,

Public Works Engineer,

Victoria, B. C.

47
350.

June 5, 1916.

Esquimalt District.

Sir:-

I beg to hand you herewith copy of letter
from s.22 which explains itself. Kindly
look into this matter when you are in the vicinity.

Yours obediently,

Deputy Minister & Public Works Engineer.

A.R. Trowse, Esq.,
Road Foreman,
Sidney, B.C.

WKG/AP.

Encl.

350.

48

June 5, 1916.

Esquimaux District.

Memo. for the Hon. the Minister of Public Works:

I beg to acknowledge receipt of your memorandum of the 30th ultimo, together with enclosed correspondence from s.22 and have requested Mr. Trowse to look into this matter when he is next in the vicinity.

Deputy Minister & Public Works Engineer.

WKG/AF.

350;

49

June 1th, 1918.

Beecher Bay Road, through
Indian Reserve.

Sir:

In reply to yours of the 2rd instant, enquiries were
only made at the Post Office, but subsequently the plans were
found in this Department, where they had been mislaid.
Regretting the delay, I am,

Yours obediently,

Assistant Public Works Engineer.

H. B. Robertson, Esq.,
Indian Agent,
DUNCAN, B.C.

FLM/JMT.

When replying refer to District Office File No. 350



THE GOVERNMENT OF
THE PROVINCE OF BRITISH COLUMBIA

50 FILE No. 350
ROAD SUPERINTENDENT'S OFFICE.

June 19. 1916. 191



Esquimalt District.

Re Beecher Bay Road.

R. S. & B.
ESQUIMALT DIST.

Sir:-

Referring to your letter of June 5th. I beg to say that the repairs necessary on Beecher Bay Road are being attended to

Yours obediently

A. H. Leatic
Road Supt.

J. E. Griffith Esq.

Deputy Minister & Public Works Engineer
Victoria.

350 & 588

51

Nov. 20 1917

Re' Diversion of West Sooke Road & Beecher Bay
Road through Beecher Bay Indian Reserve.

Sir:-

You are authorized to issue a cheque in favour of the Department of Indian Affairs, and forward it to Mr. Robertson, Indian Agent at Duncan, for the sum of s.17, s.22 in payment of land and improvements taken for the diversion of the West Sooke Road and also the Beecher Bay Road through the Indian Reserve at that point. This will be charged to the District Vote.

I attach, for your information, a copy of my letter of even date to Mr. Robertson.

Yours obediently,

Public Works Engineer.

J. L. Bowden, Esq.,

Thoburn P.O.

WEG/AP.

When replying refer to
District Office File No.

Dep't File No. 350-588

RECEIVED



PUBLIC WORKS DEPARTMENT
(DISTRICT ENGINEER'S OFFICE)

FILE No.

November 27, 1917. 191...

Return file

Re diversion of East Sooke Road
and Beecher Bay Road through Indian Reserve.
Esquimalt Agency.

R. S. G. 17
ESQUIMALT DIST.

Sir:-

Replying to your letter of the 20th, inst, authorizing me to
forward a cheque to Mr W.P. Robertson, Indian Agent at Duncan, for the
sum of s.17, s.22, in payment for land acquired from the Indians for road
purposes. I beg to say the cheque has been forwarded and charged to
our district vote.

I remain

Sir,

Yours obediently

W. K. Gwyer

W. K. Gwyer Esq.

Assistant Engineer, Public Works Dept.

Victoria.

Public Works Esquimalt District

75491

122 55
207 40
329 95
RECEIVED
NOV 28 1917
VICTORIA, B. C.

11-20-0

53

November 19th/20

Esquimalt District.
Road to Beecher Bay, Sooke.

Sir,-

In reply to your memo. of the 17th inst. re the above road.

I beg to inform you that I traversed this road recently accompanied by the local foreman and gave him instructions to have the holes and ruts filled in as soon as possible.

A Chinese logging outfit is at present hauling logs by wagon from s.22 on the Rocky Point Road, and dumping them in the bay on the other side of s.22

I verbally notified that logging over the public highways must cease during the winter months.

Yours obediently
"P.J. CAMPBELL"

To Colonel Hodgins.

General Road Foreman

REFER TO 11-20-30
FILE NO.

IN REPLYING, WRITE ONLY ON ONE SIDE OF THE PAPER.
REFER TO ONLY ONE SUBJECT OR TO ONE WORK IN A LETTER.



THE GOVERNMENT OF
THE PROVINCE OF BRITISH COLUMBIA

54
588
DEPARTMENT OF PUBLIC WORKS
(DISTRICT ENGINEER'S OFFICE)

Nov. 20th, 20

VICTORIA



Esquimalt District.

East Sooke Road to Beecher Bay.

Memo. for the Deputy Minister of Public Works. Your file 588

In reference to your verbal
instructions about the road to Beecher Bay, I enclose
Major Campbell's report, dated Nov. 19th.

ARM/TB Encl.

A.E. Hodgins

District Engineer.

115001

Dist. Minister

55

Mr Hood

Jan 6th 1951

Confirming my conversation with Mr. Wilson
of Sooke yesterday
It will be in order

to permit

s.22

2 days with team
to plow red Road
Surface through
Bill's property

P

350

56

Jan. 10th, 1923.

Esquimalt District.

Memo: to Colonel Hodgins:

An arrangement has been made with
s.22 of Sooke, to permit him two days'
work with team to plough old road surface
through his property. Charge to District
Vote.

Public Works Engineer.

AH/AF.



CANADA

DEPARTMENT OF HEALTH

IN REPLY REFER TO
FILE NO.



Victoria, B.C., Jan. 15th, 1923.

Hon. Dr. Sutherland,
Minister of Public Works,
Victoria, B.C.



Dear Sir:-

There are some repairs wanted at
Metchosin on the s.22 near Beecher Bay:
a few timbers wanted on bridge and repairs to
culvert and some repairs to the road which would
not take long to do.

I should be glad if you would
give instructions to have this done as the road
is impassable without immediate attention.

I am,

Yours respectfully,

s.22

149116

58

Jan. 17, 1923.

Esquimalt District
re Repairs to s.22
near Beecher Bay

Sir:

I am instructed to acknowledge receipt of your letter of the 15th instant, addressed to the Honourable, the Minister of Public Works, and have to advise that I have referred a copy of your communication to the District Engineer for investigation and report. I shall advise you further upon hearing from him.

Yours obediently,

Public Works Engineer.

s.22

GPH:s

356

59

Jan. 17, 1923.

Esquimaux District
re Repairs to s.22
near Beecher Bay

MEMO. - Col. A. E. Hodgins:

Kindly let me have a report in
connection with the enclosed copy of let-
ter from s.22 dated the 15th
instant, re the above.

Public Works Engineer.

GPH:E

Encl.

REFER TO
FILE NO. 11-20-67

IN REPLYING, WRITE ONLY ON ONE SIDE OF THE PAPER.
REFER TO ONLY ONE SUBJECT OR TO ONE WORK IN A LETTER.



60
202
DEPARTMENT OF PUBLIC WORKS
(DISTRICT ENGINEER'S OFFICE)

VICTORIA

Feb. 22/23

Esquimalt District.

s.22

Memo. for the Public Works Engineer. Your file 350

In reply to your memo. of the 17th January re
the above road.

The General Road Foreman reports that on going
over the road, he found it in excellent shape, with the
exception of a small hole in the bridge. This, the local foreman
has been instructed to repair as soon as possible. The traffic
on this road is practically nil.

AHH/TB

A.E. Hodgins

District Engineer.

150585
150586
150587
150588
150589
150590
150591
150592
150593
150594
150595
150596
150597
150598
150599
150600

61

Feb. 27, 1923.

Esquimalt District
s.22

Sir:

Adverting to my letter to you of the 17th of January last, I have to advise I am now in receipt of a report from the District Engineer, from which it appears that on recent examination this road was found in good shape, having regard to the traffic upon it, and the money we have available.

I understand there is one small hole in the bridge, which will be repaired as soon as possible.

Yours obediently,

Public Works Engineer.

s.22

GPN:E

350

62
March 2, 1923.

Esquimalt District
Repairs to Milne Road.

Sir:

In connection with your report to Colonel Hodgins stating that you found the above road in excellent shape with the exception of a small hole in the bridge, I beg to advise that s.22 informs us that there is a small culvert about 200 yards from the Sooke Road which has not been repaired; kindly give this your attention.

Yours obediently,

Deputy Minister of Public Works.

C.A. Helgesen, Esq.,
General Foreman,
Thoburn P.O.,
Vancouver Island.

JEG:MF



63 380

Victoria, B.C.,
February 28th, 1924.

Hon. Dr. Sutherland,
Minister of Public Works,
Parliament Buildings,
Victoria, B.C.



*See 46449
Metchosin Dist*

Dear Sir:

I wish to draw your attention
to some repairs needed on the s.22
Metchosin. The heavy rains recently have
washed away a portion of the road in some
places. There is also a culvert bridge over
a small ravine about twenty feet wide which
requires some new timbers to make it safe for
travel. I shall be pleased if you will
have these repairs made as soon as possible.

Yours very truly,

s.22

167382

A.P.B.

350

64

March 4, 1924.

Esquimalt District
Re Repairs to s.22

Sir:

With reference to your letter of the 28th ultimo, addressed to the Honourable, the Minister of Public Works, I have to advise that the contents of same have been drawn to the attention of the General Foreman.

Yours obediently,

Public Works Engineer.

s.22

GPN:E

65

March 4, 1924.

Esquimalt District
Re Repairs to s.22

Sir:

Kindly submit a report
dealing with the enclosed copy of
letter from s.22 address-
sed to the Honourable, the Minister,
under date of the 28th ultimo.

Yours obediently,

Public Works Engineer.

C. A. Helgesen, Esq.,
General Foreman,
Thoburn P.O.,
Esquimalt, B. C.

GPH:E
Encl.

Refer to
File No 11-20-67
Dept File No 350.



THE GOVERNMENT OF
THE PROVINCE OF BRITISH COLUMBIA

66 250
DEPARTMENT OF PUBLIC WORKS
(DISTRICT ENGINEER'S OFFICE)

March 7th, 1924

Esquimalt District

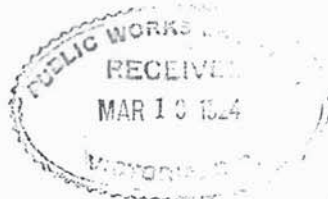

s.22

P.Philip.Esq.
Public Works Engineer.
Victoria.B.C.

Sir:-

With reference to your letter of the
4th inst, re repairs to the above road.

I beg to report that after seeing the
trifling damage done, I have instructed the
local patrolman to attend to it.

The bridge referred to is, No 11-81
and is in no danger at present. It will have
to be renewed this summer.

Yours obediently,

C. A. Helgecamp,
General Foreman.

CAH.

162710

TELEPHONES

VICTORIA, B. C.

1925

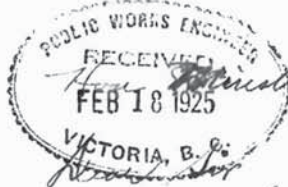

Ministry of Public Works. 67

I beg to inform you that the bridge
on the ^{s.22} in Metchoin District
is in a bad condition so much so that
it is not safe to travel by car or
other conveyance.

The timbers of the bridge in
some places are decaying and the
planks are now giving way.

Your immediate attention
will greatly oblige me as we
require to go over the road at once.

Remain Yours Respectfully

s.22

DWE

350

68

Feb. 20, 1925.

Maquimalt District

s.22

Sir:

Kindly immediately investigate
the matter referred to in the enclosed
copy of letter from s.22 dated
the 17th instant, and thereafter let me
have your report.

Yours obediently,

Deputy Minister and
Public Works Engineer.

C. A. Helgeson, esq.,
General Foreman,
Langford I.O., V. I.

CAT:1
Encl.

Refer to
File No. 13-40-81
Dept File No. 350.



THE GOVERNMENT OF
THE PROVINCE OF BRITISH COLUMBIA

69 210
DEPARTMENT OF PUBLIC WORKS
(DISTRICT ENGINEER'S OFFICE)

25th February, 1925. 192

Esquimalt District



s.22

Bridge 13-81.

PUBLIC WORKS ENGINEER
RECEIVED
MAR 2 1925
VICTORIA, B. C.

P. Philip, Esq.
Public Works Engineer.
Victoria, B. C.

Sir:-

With reference to your letter of the
20th inst, re the above.

I beg to report that I have inspected
this bridge, and find that a new bridge, or a
culvert and fill to replace same, is required.
Temporary repairs are being made.

Length of bridge, over all. 31 feet.
Cost of new bridge, including cribs. \$350.00
Cost of 3 x 4 culvert and fill to grade. 300.00

I recommend that a culvert and fill be
put in, as water flow under bridge is slight, and
fill material handy.

Yours obediently,

60a Helgerson J. G.
General Foreman.

CAB/GC.

350

70

March 2nd, 1925.

Esquimalt District
s.22 #13-81

Sir:

With reference to your letter of the 25th ult. file 13-40-81, you have authority for the expenditure of \$300.00 from Vote 251 - Bridges, to replace the above bridge by a culvert and fill.

Yours obediently,

Deputy Minister & Public Works Engineer.

C. A. Helgesen, Esq.,
General Foreman,
Langford P. O.

HWR:AF

FORM 11B

FOR DEPARTMENTAL AND INTERDEPARTMENTAL CORRESPONDENCE ONLY

50N-037-0031

71 350/

PROVINCE OF BRITISH COLUMBIA
DEPARTMENT OF PUBLIC WORKS

FROM Asst. Dist. Engineer Burnside	TO District Engineer Victoria, B. C.	DATE Dec. 17th, 1937. ELECTORAL DISTRICT Esquimalt OUR FILE 17-21-5 YOUR FILE
SUBJECT Gate erected by Drem at end of Beecher Bay Road.		REFERENCE YOUR LETTER

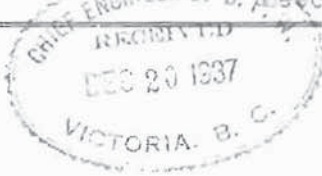

As far as can be ascertained, no Government money has been spent on Beecher Bay Road beyond the gate across the road at the boundary of s.22. This property is rented from s.22, and the gate mentioned is the gate broken of by s.22 as s.22.

I have instructed Mr. Helgesen to examine the trail the s.22 use to reach their dwelling, with a view to any possible improvement by the use of Relief Labour.

W. W. Bell

W. W. BELL,
Asst. Dist. Engineer.



403228

W. W. Bell
1937

D.E.

DEC 1
DEPARTMENT OF
PUBLIC WORKS
VICTORIA B.C.

100M-280-7519

493228

W. H. H.

D.E.

100M-280-7519

MEMORANDUM.

FROM: MINISTER OF PUBLIC WORKS.

VICTORIA, B.C.

TO Mr. A. L. Carruthers,
Deputy Minister of Public Works,
Parliament Buildings.

OFFICE OF MINISTER OF PUBLIC WORKS.

MAR 1 - 1947

VICTORIA. February 26, 1947

APPROVED: _____

NOTED: _____

DATE: _____

I was approached by one of the owners of property at Beacher Bay with regard to maintenance on the Beacher Bay road leading from the east School roadway.

Apparently there is a culvert near the top of the hill on this road which they say has been blocked for some time and this leads to a lot of trouble on the hill during the period of run off.

Will you please have this matter checked?

E. C. Carson

706422

Minister.

FORM P.W. 118

FOR DEPARTMENTAL AND INTERDEPARTMENTAL CORRESPONDENCE ONLY

10M-114G-S108 (2)

PROVINCE OF BRITISH COLUMBIA

DEPARTMENT OF PUBLIC WORKS

FROM "CHIEF ENGINEER"	TO Mr. E. Smith, District Engineer, Buildings.	DATE Feb. 28th, 1947.
Deputy Minister		ELECTORAL DISTRICT
		OUR FILE
		YOUR FILE
SUBJECT Re: Beecher Bay Road		REFERENCE YOUR LETTER

Herewith find memorandum from
the Minister.

I wish you would look into this
matter and do what you consider neces-
sary.

McCauley
Deputy Minister

ALC/MB
Encl.

706423

74

March 4th, 1947.

District
Engineer
Victoria

O. G. Gallaher, Esq.,
Asst. Dist. Engineer,
Barnside Road.

Esquimalt

350

Beecher Bay Road . .

The Minister of Public Works has written
to the Deputy Minister as follows:-

"I was approached by one of the owners of
property at Beecher Bay with regard to
maintenance on the Beecher Bay Road leading
from the east school roadway.

"Apparently there is a culvert near the top of
the hill on this road which they say has been
blocked for some time and this leads to a lot
of trouble on the hill during the period of
run off.

"Will you please have this matter checked?"

Please give this matter your attention and
do what you consider necessary.

E. SMITH,
District Engineer.

TFB:CE

75 350

PROVINCE OF BRITISH COLUMBIA
DEPARTMENT OF PUBLIC WORKS

FROM Asst. Dist. Engineer, 280 Burnside Rd. W., Victoria, B. C.	TO Mr. E. Smith, District Engineer, Victoria, B. C.	DATE March 10/47 ELECTORAL DISTRICT Esquimalt OUR FILE 12-20-0 YOUR FILE 350
SUBJECT Beecher Bay Road		REFERENCE YOUR LETTER March 4

RECEIVED
PROV. DEPT. OF PUBLIC WORKS
VICTORIA, B.C.
MAR 14 1947
DISTRICT ENGINEER
VICTORIA, B.C.

Reference to the Honorable the Minister's report regarding the condition of Beecher Bay Road.

Two weeks ago the road crew inspected Beecher Bay Road and made minor maintenance repairs. At that time the foreman reported that this culvert was in difficulties, that is, was plugged up and the water was flowing over the road. However, no serious damage was being done.

When I inspected it on Friday, March 7th, I found that the road crew were then installing a new culvert.

O. G. Callahan
O. G. CALLAHAN
Asst. Dist. Engr.

OGG:JW

707437

76
340
District
Engineer
Victoria

O. G. Gallaher, Esq.,
Asst. Dist. Engineer,
Burnside Road.

March 21, 1947

Esquimalt

350

Culvert - Milne Road

s.22 who lives
at the end of the Milne Road, Secs. 47 and 50,
Metchosin District, called at this office today
and complained that a culvert on this road is
partially washed out.

Kindly look into this matter and
carry out such repairs as are necessary.

s.22 requested that you
call on him when in this vicinity.

E. SMITH,
District Engineer.

CE

OFFICE OF THE
INDIAN AGENT



CANADA
DEPARTMENT
OF
MINES AND RESOURCES
INDIAN AFFAIRS BRANCH

77
350
PLEASE QUOTE
FILE

RECEIVED
PROV. PUBLIC WORKS DEPT.
VICTORIA, B.C.

Duncan, B. C.,
April 23, 1947.

Mr. E. Smith,
Dist. Engineer,
Parliament Buildings,
VICTORIA, B. C.

Sir:

Please advise if you have the Milne Road
listed as a Gazetted Road through the Beecher Bay No. 1 I.R?
If so, what is the width and other particulars as we do not
appear to have any record of this road as being a Public Right-
of-Way.

Yours truly,

R. H. MOORE
Indian Agent.

RHM:EL

D.E.

711980

Copy sent O. G. Gallaher, Burnside Road.

78

File 350

Victoria, B.C.,
April 25th, 1947.

Re: Milne Road, Beecher Bay Indian Reserve
No. 1

Sir:

In reply to your letter of April 23rd, I beg to advise you that a cheque for s.17, s.22 in payment for land acquired from the Indians for this road, was sent to Mr. W. P. Robertson, Indian Agent at Duncan, November, 1917, for 2,205 feet by 33 ft. wide, plus one-half of 175 ft. by 33 ft. wide, or a total of 1.74 acres, as shown on plan mailed to Mr. Robertson.

Yours very truly,

E. SMITH,
District Engineer

Mr. R. M. Moore,
Indian Agent,
Duncan, B. C.

TFB:CE

79 350
s.22

November 3, 1947.

RECEIVED
PROV. PUBLIC WORKS DEPT.
VICTORIA, B. C.

NOV 5 - 1947

Deputy Minister, ~~ANSWERED~~
Dept. of Public Works,
Victoria, B. C.

and 10-41

Dear Sir:

Enclosed herewith is a petition signed by fifteen residents of Speyside on Milne Road at Becher Bay, who respectfully request that immediate steps be taken to repair and widen Milne Road.

This property is being built into an all year round resort, for which it is ideally situated, and your consideration is requested in improving the road so that tourists will be attracted, and not discouraged as they are now by the present road.

It will be observed that five families are represented in the petition. Three of these families have small children ranging in age from two months to seven years, whose names are not, of course, included. There is also one paralysed man, and one man who has just arrived tonight.

It is understood the government is doing everything in its power to attract tourists. Surely it will be good business to widen and repair this road.

Yours truly,

s.22

733268

D.E.

80

THE purpose of this petition is to request that immediate attention be given to MILNE ROAD. This provincial road connects the EAST SOOKE HIGHWAY with the Northern tip of BECHER BAY and is in urgent need of widening, gravel, and repairs. THE following bona fide residents of SPEYSIDE at the end of MILNE ROAD on BECHER BAY do hereby petition the Dept of PUBLIC WORKS to provide the necessary attention to MILNE ROAD.

J. F. Stocken
Sda. J. Stocken

J. R. Davidson
Pm Davidson

G. Shea
J. V. Shea

E. Shea

H. Shea

J. Smith

B. Giles

D. C. McLaren

C. H. Shea

L. E. Shea

W. A. Bacon

81
District
Engineer
Victoria

O. G. Callaher, Esq.,
Asst. Dist. Engineer,
Burnside Road.

Nov. 12th, 1947

Esquimalt

350

Milne Road

A petition has been received by the Deputy Minister signed by 15 residents of Speyside on Milne Road at Becher Bay, requesting that immediate steps be taken to repair and widen Milne Road.

Please let me have your report.

E. SMITH,
District Engineer

ES:CE

82

File 350

Victoria, B.C.,
Nov. 12th, 1947

Re: Milne Road

Sir:

Your letter and petition dated November 3rd, addressed to the Deputy Minister, has been referred to me and I am procuring all necessary information in the matter and will advise you in due course what can be done.

Yours very truly,

E. SMITH,
District Engineer

s.22

ES:CE

83

350

PROVINCE OF BRITISH COLUMBIA
DEPARTMENT OF PUBLIC WORKS

FROM Asst. Dist. Engineer, 280 Burnside Rd. N., Victoria, B. C.	TO Mr. E. Smith, District Engineer, Parliament Buildings, Victoria, B. C.	DATE November 12th, 1947 ELECTORAL DISTRICT 350 OUR FILE 12-20-0 YOUR FILE 350
SUBJECT Milne Road		REFERENCE Nov. 12/47 YOUR LETTER

RECEIVED
 PROV. PUBLIC WORKS DEPT.
 VICTORIA, B. C.

NOV 20 1947

ANSWERED
 NOTED
 DATE

With reference to the petition, of 15 residents for widening and repairs to Milne Road. I have examined this road and, at the present time, the Local Foreman is graveling those sections that need it.

Milne Road is essentially a one way road and I do not think that there is any urgent necessity that it be widened, although presently, at the present time,

s.22 at the end of this road and it is practically impossible for the Department to maintain such roads during the winter when subjected to heavy logging traffic. I recommend that nothing further than maintenance be done on this road until we have reason to believe that there is a permanent settlement at the end of it.

O. G. Gailair

O. G. GAILAIR
 Asst. Dist. Engr.

OGG:PH

734798

D.E.

84

District
Engineer
Victoria

O. G. Gallaher, Esq.,
Asst. Dist. Engineer,
Burnside Road.

Nov. 22nd, 1947

Esquimalt

350

12-20-0

Milne Road

Nov. 18th

In connection with your report on the petition it is noted that you state that Milne Road is essentially a one-man road: at the same time, s.22 letter states that five families are represented in the petition, apparently all living on this comparatively short road.

Will you be good enough to inform me precisely how many permanent residents there are on this road.

E. SMITH,
District Engineer

ES:CE

FORM P.W. 118A

80V
310

PROVINCE OF BRITISH COLUMBIA
DEPARTMENT OF PUBLIC WORKS

FROM Asst. Dist. Engineer, 280 Burnside St. W., Victoria, B. C.	To Mr. E. Smith, District Engineer, Parliament Buildings, Victoria, B. C.	DATE November 26th, 1917 ELECTORAL DISTRICT Esquimalt OUR FILE 17-20-0 YOUR FILE 150
SUBJECT Milne Road		REFERENCE Nov. 22/17 YOUR LETTER

RECEIVED
PROV. PUBLIC WORKS DEPT.
VICTORIA, B. C.

NOV 28 1917

ANSWERED.....
NOTED.....
DATE.....
Dec 1-17

I do not know how many permanent residents there are on this road but I do know that the road is built through the Indian Reserve and has no resident along its entire length and that the only property on which persons can live is at the end of the road belonging to s.22 At that point, he lives and is operating a Tie-Mill and has several employees living around the Mill.

Major Davidson called on me two days ago and thanked me for the removal of his road.

E. G. Smith
E. G. SMITH,
Asst. Dist. Engr.

000:ET

735689

D.E.



DEPARTMENT OF PUBLIC WORKS
DISTRICT ENGINEER'S OFFICE

File 350

Victoria, B.C.,
April 25th, 1947.

Re: Milne Road, Beecher Bay Indian Reserve
No. 1

Sir:

In reply to your letter of April 23rd, I beg to advise you that a cheque for s.22, s.17 in payment for land acquired from the Indians for this road, was sent to Mr. W. P. Robertson, Indian Agent at Duncan, November, 1917, for 2,205 feet by 33 ft. wide, plus one-half of 175 ft. by 33 ft. wide, or a total of 1.74 acres, as shown on plan mailed to Mr. Robertson.

Yours very truly,

E. SMITH,
District Engineer

Mr. R. H. Moore,
Indian Agent,
Duncan, B. C.

TFB:CE