



Ministry of Energy, Mines and
Petroleum Resources

1610437
Sand and Gravel/Quarry Operation
Notice of Work and
Reclamation Program

The information on this form and any supporting documents are subject to the *Freedom of Information and Protection of Privacy Act*. The information requested on this form is collected and used for the purpose of administering the *Mines Act* of British Columbia and the *Health, Safety and Reclamation Code for Mines in British Columbia*. The *Mines Act* authorizes the collection of the requested information on this form. The completed form is routinely available to the public. Questions about how the *Freedom of Information and Protection of Privacy Act* applies to the information collected on this form can be directed to the Office of the Information and Privacy Commissioner—
phone: (250) 387-5629; fax: (250) 387-1696; mailing address: PO Box 9038 Stn. Prov. Govt. Victoria, British Columbia, V8W 2X1

Application is for: ☒ Sand and Gravel Mine ☐ Rock Quarry
This application is for (check one):
☒ Development ☐ Amendment to existing permit Permit # _____
Application is being made by:
☒ Owner (Private property)
☐ Operator/Agent (Person or company making application on Crown land or on private property not owned by applicant)

Name Sooke Lake Road Holdings Inc. E-mail Address: tom@islandnet.com
Company (if applicable) Tom Wikstom
Address 635 Roseridge
City Victoria Bus. Phone (250) 418.8888
Province BC Postal Code V8Z 2Z1 Fax (250) 479.7343

LOCATION INFORMATION - Maps are mandatory under Schedule A

Name of Mine (What will the operation be called when in production?): Sooke Lake Quarry

Legal Description of Property: Remainder North 80 Acres, Lot 89, Malahat District

Street Address of Property, if applicable: _____

1875 Sooke Lake Road, Shawnigan Lake BC, VoR 2W3

Access route from nearest town to property: From Shawnigan Lake Village - South on West Shawnigan Lake Road, South on Sooke Lake Road.

B.C. Geographic System Map Sheet Number(s) [i.e. TRIM 093L.006] _____

Northing: _____ Easting: _____ UTM Zone: _____

or NTS Map Sheet Number(s) [i.e. NTS 093L/14E]: 92B12

Latitude: N48° 35' 6.4" Longitude: W123° 37' 54.0"

OWNERSHIP (Complete a, b or c if the land is not privately held by applicant)

a) Proposed mine is on private land:

Name of property owner _____

Address _____

City Victoria Phone (250) 418.8888

Province BC Postal Code _____ Fax (250) 479.7343

Signature of owner agreeing to the mining operation proposed in this application (or attach letter of authorization signed by owner):

Name: _____ Date: _____

b) Proposed mine is on Crown land:

Assets and Lands Corporation (BCAL) file reference number: N/A

License of Occupation/Lease number: N/A Expiry date of License/Lease (y/m/d): N/A

c) Proposed mine is a mineral quarry (as defined under the Mineral Tenure Act):

What mineral is proposed to be mined? N/A

Mineral Claim/Lease Tenure Number(s): N/A

MANAGEMENT

Correspondence regarding this application should be sent to: ☐ Owner or ☐ Operator/Agent

The mine manager (*Mines Act* Sections 21 and 22) responsible for management and operation of the mine will be:

Name: Tom Wikstom Bus. Phone: (250) 418.8888

LAND USE

1) Cultural Heritage Resources *(A cultural heritage resource is defined as "an object, a site or the location of a traditional societal practice that is of historical, cultural or archaeological significance to British Columbia, a community or an aboriginal people". B.C. law requires the conservation of these resources. It is the responsibility of the applicant to identify these resources.)*

Are you aware of any cultural heritage resources present on the property?

- ☐ Yes - please attach a plan for the conservation of cultural heritage resources on the property
☒ No - if cultural heritage resources are discovered while mining, you are required to report them to the Mining Division.

2) Soil Conservation

Average depth of overburden (material, including topsoil, overlying sand, gravel and/or rock): 90 cm, or _____ m

Average depth of topsoil (Surface to maximum rooting depth of plants, plus 15 cm.): 20 cm, or _____ m

Measures to stabilize soil/overburden stockpiles and control noxious weeds: _____

Stockpiles will be located such that natural drainage channels are not blocked, banks will be seeded with native wild flower mix.

Topsoil must be conserved for reclamation of the mine site.

Removal of topsoil from the site requires written approval of the Inspector

3) End Land Use

Is the site within the Agricultural Land Reserve?

- ☒ No ☐ Yes - authorization for soil removal from the Land Reserve Commission and Regional District must be obtained. Provide permit application number if available: _____

Is the site within the Forest Land Reserve?

- ☒ No ☐ Yes - authorization from the Land Reserve Commission must be obtained

Is the site within a Tree Farm License?

- ☒ No ☐ Yes - state the TFL number: _____

Name of TFL holder: _____

Does the local government have a Soil Removal Bylaw?

- ☒ No ☐ Yes - please be aware that a Soil Removal Permit may be required by the local government

Official Community Plan designation for the site is: Forestry

Current land use zoning for the site is: F-1 Primary Forestry

Proposed end land use is: Acerage Residential

4) Reclamation of Site *(If space provided below is insufficient, please attach separate sheet describing proposed reclamation)*

Reclamation measures and schedule proposed to achieve end land use objectives as per part 10.7.4 and 10.7.5 of the Health Safety and Reclamation Code for Mines in British Columbia (hereafter referred to as the Code): _____

As the quarry is excavated, return haul materials (free of contaminants) will be placed and compacted in lifts as recommended by the project geotechnical consultant (Levelton Engineering). At the completion of quarry operations, the site will be developed with as an acreage subdivision, with geotechnically approved building sites being created.

If backfilling of pits or pit slopes is proposed in the final configuration for reclamation, provide details of materials to be used and placement procedure: Pit will be back filled with return haul materials. The materials will generally consist of granular and clay and organic soil materials. Backfill material will be clear of stumps and debris.

MINE DEVELOPMENT PLAN (Maps are mandatory - please refer to Schedule A)

Unless otherwise required by the Inspector, complete the following mine development plan and prepare development maps and cross sections based on a period of 5 years or less. Mines operating for longer than 5 years, may be required to file updated Notices of Work every 5 years over the life of the mine at the discretion of the District Inspector.

Proposed start date (y/m/d): 2008/ 10/ 01 Proposed finish date (y/m/d): 2052/ 09/ 01

The mining operation will generally be (check one) ☒ Continuous (operates throughout the year)
☐ Seasonal, usually operates from _____ to _____
☐ Intermittent (occasionally operates with extended periods of inactivity)

Estimate total mineable reserves over the life of the mine: _____ tonnes, or 4,490,000 m³

Estimated annual extraction from site: _____ tonnes/yr, or 100,000 m³/yr

Application must be made to the Environmental Assessment Office if estimated extraction for sand/gravel production is 500,000 tonnes/yr. or 1,000,000 tonnes over 4 years; or if estimated extraction is 250,000 tonnes/yr. for quarried product. Mineral quarries producing more than 1000 tonnes per year per claim require a mining lease.

Description of Work (Check appropriate boxes):

☒ Excavation of Pit Run ☐ Washing - please complete Schedule B
☐ Crushing ☒ Blasting - please complete Schedule C
☐ Mechanical Screening ☒ Timber Clearing * - estimate volume of timber: 4500 m³

* Timber Clearing on Crown Land requires a Free Use Permit or License to Cut from the Ministry of Forests

Provide a brief description of operation, including proposed work schedule (i.e. hours, days of usual operation): Operation will normally run from 7 AM to 4 PM, Monday to Friday with blasting, excavating, loading & transporting rock off site to be processed. Overburden will be stockpiled onsite for backfill purposes.

Equipment List: (Please attach separate list if space provided below is insufficient)

Type of Machine	Make/Model	Size/Capacity	# on Site
Excavator	2004 Komatsu/ EX200	7/8 yd3	1
Dozer	1999 CAT	D6	1
Dump Truck	Kenworth	Tandem	1
Power Screen	Chieftain	600	1
Wheel Loader	CAT	988	1
Hydraulic Rock Drill	Ingersoll Rand	D7	1
Jaw Crusher	3042		1

Surface Disturbance - Information provided must be documented in development maps submitted under Schedule A

(Note that 10,000 m² = 1 hectare)

Existing Disturbance (Work areas, unreclaimed areas, access roads, etc.) _____ m², or 15 hectares

Proposed Mining Disturbance (New work areas, settling ponds, access roads, buildings, etc. to be developed within the time frame of this Notice of Work) _____ m², or 14 hectares

Total Disturbed Area (Existing + Proposed Disturbance) _____ m², or 29 hectares

Will any portion of this disturbance be reclaimed within the time frame of this Notice of Work?

☐ No ☒ Yes - state size of area to be reclaimed: _____ m², or 29 hectares

Estimated Cost of Reclamation: Applicant \$ _____
Mining Division \$ _____

Are settling ponds or other structures proposed to control sedimentation in surface run off?

☐ No ☒ Yes - please complete Schedule B

What is the average depth to the high groundwater table at the proposed excavation? _____ m

Elevation of the groundwater table was determined from (check applicable boxes):

☐ Existing area wells ☐ Test wells drilled for this purpose
☐ Test pits ☐ Other (describe) _____

Describe measures proposed to protect groundwater quantity and quality from potential impacts of the proposed mining activity (i.e. fuel management program, buffer above water table, etc.): _____

Note that excavations below the groundwater table may require special approval from the Inspector

Will fuel/lubricants be stored on site? ☐ No ☒ Yes

If yes, handling, transportation and storage must adhere to B.C. Environment standards as detailed in "Summary of Environmental Standards and Guidelines for Fuel Handling, Transportation and Storage, 2nd edition"

Shortest distance between proposed excavation to nearest residence: 167 m, or _____ km

Shortest distance between proposed excavation to nearest residential water source: 100 m, or _____ km

Describe measures proposed to prevent inadvertent access of unauthorized persons on the mine site (i.e. fencing, vegetative barriers, berms, etc.): Gate and signage at vehicle entrance. Perimeter security fencing along property boundaries, onsite security

Are measures proposed to minimize noise impacts of the operation? (i.e. equipment selection, restrictions on hours of operation, noise barriers, etc.) ☐ No ☒ Yes - Please describe: Hours of operation restricted to 7 AM to 4 PM, Monday to Friday. No blasting or crushing on weekends. Excavation face will be at south and west side of site and will several meters below existing grade, providing further sound attenuation.

Are measures proposed to minimize dust impacts of the proposed operation? (i.e. apply dust suppressants, water sprays, wind breaks, vegetation, etc.) ☐ No ☒ Yes - Please describe: Dust suppressants and water sprays will be utilized in active areas. Other areas will be revegetated with natural wildflowers to stabilize the soil and reduce dust. Access Road will be graveled and overlain with recycled asphalt product.

Are measures proposed to minimize visual impacts of the proposed operation? (i.e. vegetative barriers, berms, green belts, etc.) ☐ No ☒ Yes - Please describe: 5m wide vegetated buffer surrounding site. Slopes will be seeded with wildflowers and native plants.

OCCUPATIONAL FIRST AID

First Aid Supplies and communication at the mine site are required as per Parts 3.6.1 to 3.6.3 of the Code.

Describe the means of communication from the mine site: Telephone

Location of nearest hospital: Victoria General Hospital

Travel time to hospital: 20 Minutes Estimated number of employees on site (includes contractors): 5

Describe First Aid Level and supplies Level 1 First Aid

I, Tom Wikstrom, hereby make application to undertake the mining activities described in this Notice, and in accordance with the Mines Act and the Health, Safety and Reclamation Code for Mines in British Columbia.

Applicant Signature: 

Date: 003/08

Applications will be returned if not accompanied by legible and suitable maps

Schedule A1 (compulsory): Location map (1:50,000 scale)

Indicate the location of the property with respect to local communities

Schedule A2 (compulsory): Local Features map (1:20,000 scale - TRIM map)

Map should show topography, water courses, existing access and/or proposed new or upgraded access, the location of proposed mining area, and location (if known) of historical/cultural resources. If applicable, locate the boundaries of Forest Land Reserves and Agricultural Land Reserves on the map.

Schedule A3 (compulsory): Land Title map

The subject parcel and adjacent properties must be clearly identified and the following items detailed:

- location of all structures and wells within 300 metres of proposed mining area
- identify current land uses on adjoining properties (i.e. forested, chicken farm, etc.)

Schedule A4: Mineral Tenure map (at scale maintained by Mineral Titles Branch for subject area)

Mineral Tenure map(s) are required if quarrying a mineral (*as defined under the Mineral Tenure Act*)

Schedule A5: Terrain/geology and Terrain Stability Map (1:20,000 scale)

Terrain map(s) are required:

- for excavations on slopes greater than 50%, and/or
- for excavations in areas with a stability rating of Class IV or V; or
- if requested by the Inspector

The Inspector may require a "Detailed Terrain Stability Assessment" and/or a "Soil Erosion Hazard Assessment".

Schedule A6 (compulsory): Mine Development Plan at 1:5,000 or more detailed scale

The District Inspector may require a mine plan to be prepared by a suitable qualified P.Eng/Geol based on a topographical site survey, terrain stability and erosion hazard assessments.

All plans and sections must indicate the scale and orientation of the drawing (please refer to attached sample)

1) Plan View of Proposed Development

Must illustrate the location of:

- Property boundaries and set back of excavation from property boundary
- Watercourses and drainages (wet, dry or intermittent) on the property and within 150 metres of its boundaries
- All previous surface workings, the final boundaries of proposed excavation, and boundaries of excavation at the end of development described in Notice of Work (please specify on drawing)
- Access roads, including development roads within the pit and access to public road(s)
- All proposed and existing stockpiles (i.e. topsoil, overburden, product, etc.)

Where applicable, show location of:

- All settling ponds (for both surface run off and process water) and source of process water
- Buildings and other facilities (i.e. fuel/lubricant storage, sanitary facilities, weigh scale, etc.)
- sediment control structures and the location of any point discharges from the property
- Fencing, berms, and/or vegetative buffers

1) Cross Sections of Proposed Development

At least two cross sections, orientated perpendicular to each other, must be provided

The location of cross sections must be shown on the plan view map(s). Cross sections must illustrate:

- The original land surface and, if applicable, the groundwater table elevation
- Typical configuration during mining, indicating angle of slope and, where applicable, bench locations
- Proposed configuration on completion of reclamation

Schedule B
Washing of Aggregate on Site/Sediment Control Structures

Mark the location(s) of all proposed settling ponds and/or sediment control structures on the appropriate map(s) under Schedule A.

Describe the source of water supply: Wells

Estimate volume of water to be used: _____ (cu. ft./sec), or _____ (liters/sec)

Complete the following table for existing and proposed settling ponds:

Pond #	Water Source (i.e. surface run off, wash plant, etc.)	Width (m)	Length (m)	Depth (m)	Construction Method (excavated, dyked, etc.)

Water from ponds will (check one): ☒ be recycled ☐ exfiltrate to ground ☐ discharge to environment

If discharged to the environment, a Waste Management Act permit is required.

Where there is a discharge to the environment:

- provide a cross section illustrating the sediment control structure(s), decant structure(s), and point of discharge to environment
- describe the type of sediment control structure(s): _____

- describe the type and construction of the decant structure: _____

- describe area into which water is discharged: _____

For all settling ponds describe:

- Spillway design: _____

- Clean out method: _____

- Disposal of fines from clean out (i.e. use as a subsoil material): _____

Describe proposed reclamation activities and timing of reclamation work: _____

Applicant Signature

Oct 3/08
Date

Schedule C
Blasting

Mark the location of all proposed blast sites on the appropriate map(s) under Schedule A. If any structure, water well(s), or roadways are located within 300 m of proposed blast sites, these items must be located on the map(s).

Shortest distance between blasting operations to nearest residence/structure 125 m, or _____ km

Shortest distance between blasting operations to nearest water well 125 m, or _____ km

Are any public use areas (i.e. picnic/camping areas, hiking trails etc.) located within 1 km of the blasting area?

☐ No ☒ Yes - distance from recreation area to blasting operations is: 30 m

Will blasting be contracted out? ☐ No ☒ Yes

Name of Blaster/Company: Western Grater Contracting - Attn: Tony Miller

Blaster's Certificate # _____

Blaster must hold a valid BC Blasting Certificate as per Part 8.2.1 of the Code

Will explosives be stored on site? ☒ No ☐ Yes

If yes, has a B.C. Explosives Storage and Use Permit for Mining Purpose been issued?

- ☐ No - Complete a permit application from the Mining Operations Regional Office and attach it to this schedule.
☐ Yes - Provide current permit # _____ Date of expiry (y/m/d): _____

Provide details of (attach separate page(s) if space is insufficient):

- size and type of explosive(s) to be used: Dyno Nobel Amonia Nitrate - Anfo & Anfo WR; Primer = 2x16 Unimax Dynamite
- detonation method: Non-EI EZ-Det; Non-EL EZ-TL #17 - 42 ms; EB Cap for EZ-TL
- type of explosives magazine: No Storage onsite - Delivery by Dyno-Nobel
- blasting procedure (public notification, on-site safeguards, timing, etc.): _____

Letter of Notification to Neighbourhood

Guards posted at all points of entry to site, c/w radio communication.

Guards posted on Trans Canada trail - will monitor, hold and/ or escort trail users past site during blasting periods.

Airhorn signals.

Operators onsite with radio communication

If blasting is proposed within 1 km of any residence, structure, well or public use area, the Inspector may request further information regarding fly rock control and/or seismic impacts.

The Inspector may request that a Workers' Compensation Board Blaster's Log be kept

Applicant Signature

Date

SAMPLE MAP - Plan View and Cross-Section

Please provide separate maps for plan view and cross-sections, on paper no smaller than 8 1/2" x 11."
At least 2 cross sections orientated perpendicular to each other, are required.

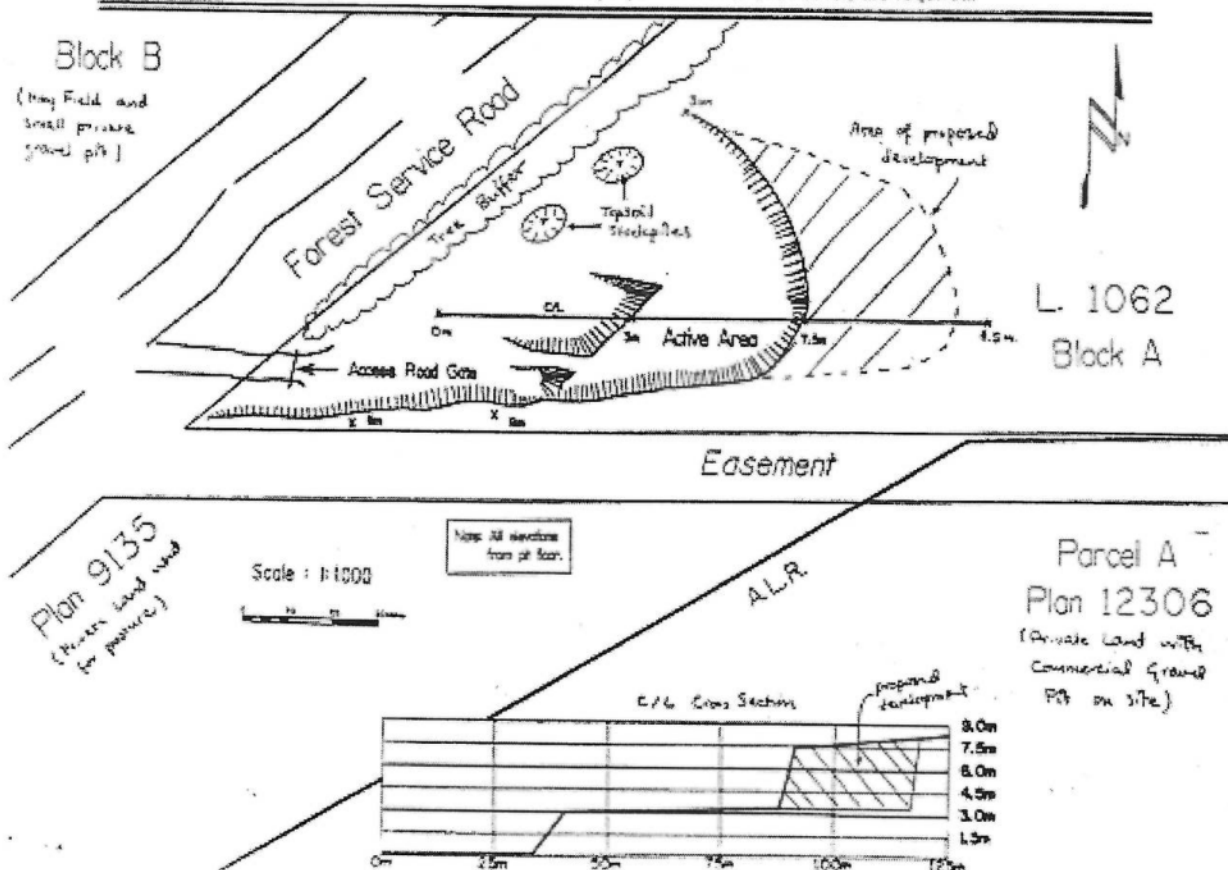

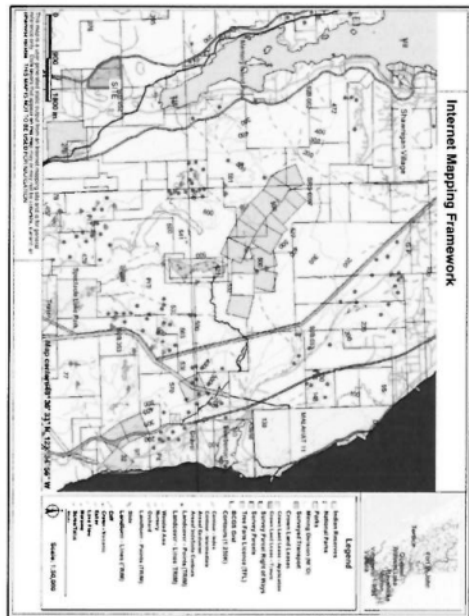

**Location Plan
Schedule A1**



**Land Title Map
Schedule A3**

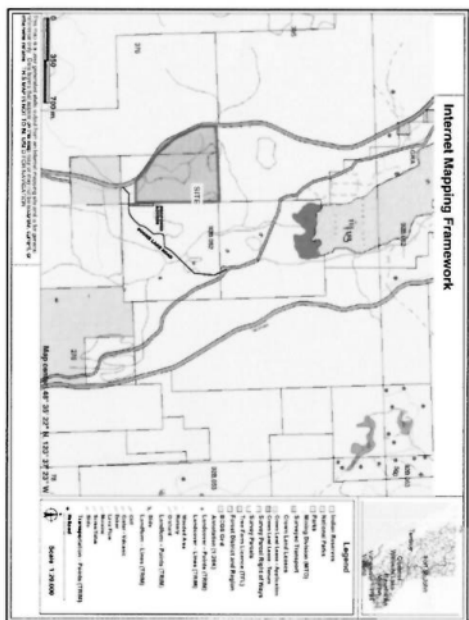

**Local Features Map
Schedule A2**

**Lot 154 and the remainder north 80 acres
of Lot 89, Malahat District Plan VIP 65844
and VIP 44129**

Sooke Lake Road Quarry

-  **Site**
-  **Tree Farm**

**WESTBROOK
Consulting Ltd.**
4022-77th Goldstream Ave., Victoria, BC V9A 2G3
Telephone: 250-391-6022 Fax: 250-391-6093

Sooke Lake Road Quarry

WESTBROOK
Consulting Ltd.
4022 - 71st Avenue, Victoria, BC V8B 2A3
Tel: 250.363.8888 Fax: 250.363.8889

Approx. Cut Volume = 4,494,655 cu m's

EASEMENTS
ACCESS EASEMENT 128144G

PARCEL D
OF LOT 89
(DD 174323-1)

REMAINDER 1
PLAN VIP51874

PLAN VIP61301

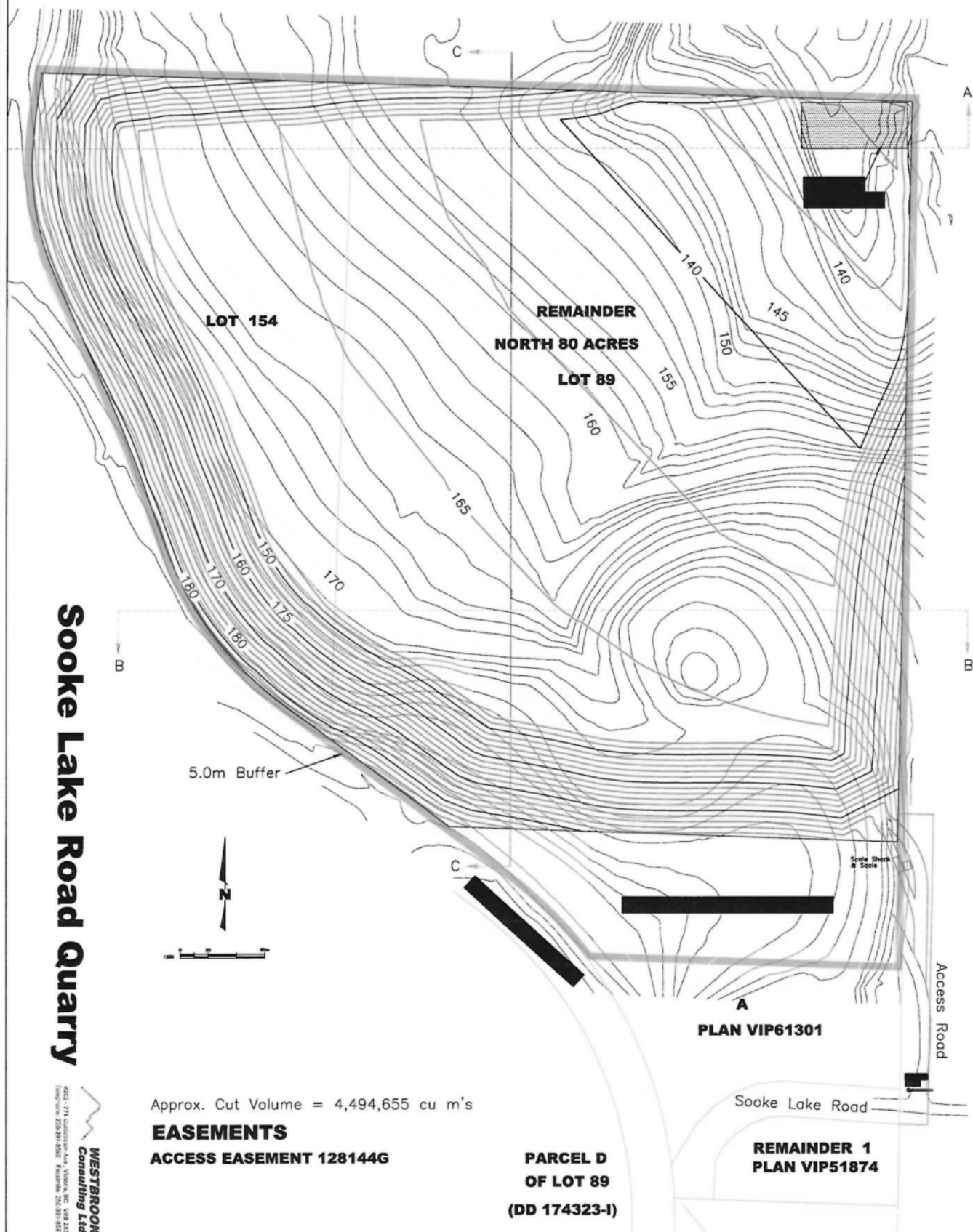

Sedimentation Pond Detail

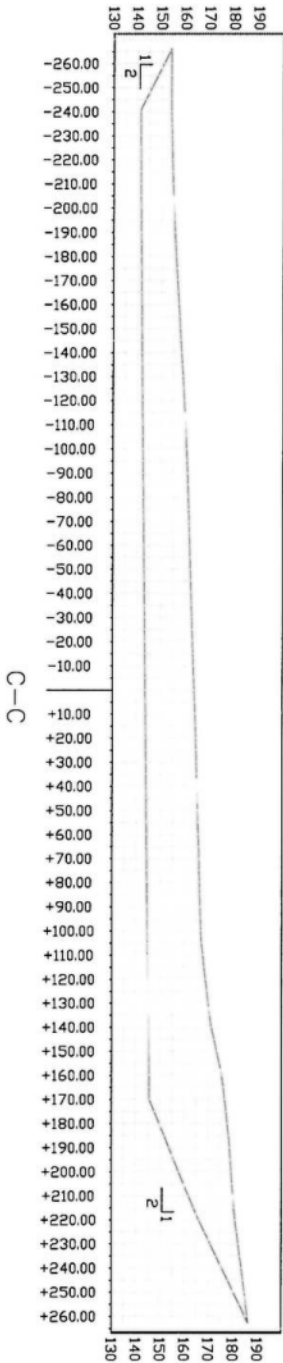
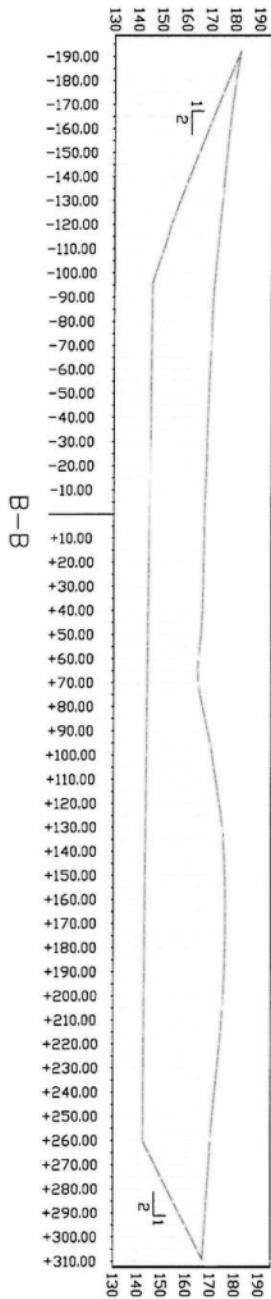
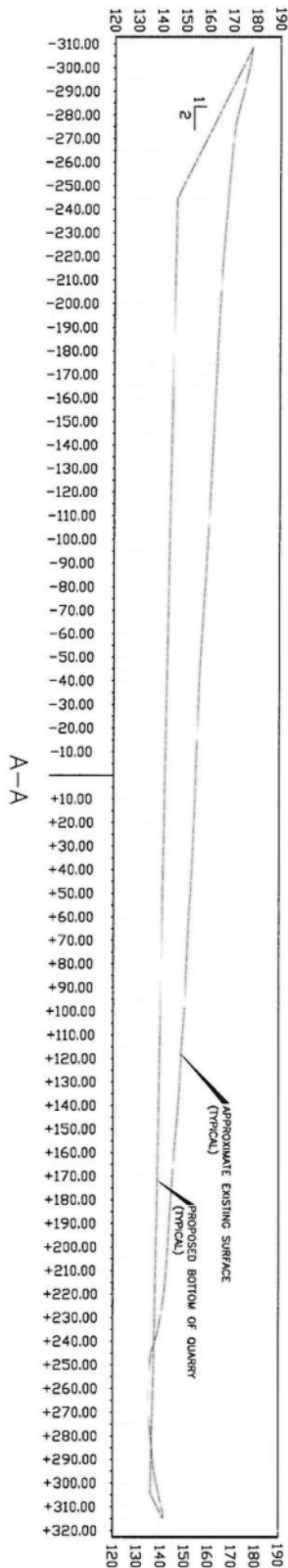
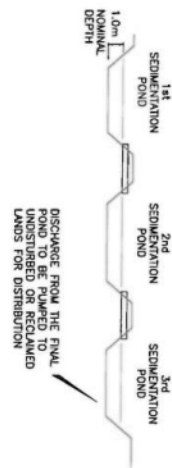

Sooke Lake Road Quarry

WESTBROOK
Consulting Ltd.

4221 - 714 GORDON AVE. VICTORIA, BC V8G 2X3
Telephone 250-381-8552 Fax 250-381-8553

Sooke Lake Road Quarry

WESTBROOK
Consulting Ltd.
R202-774, Gouletville Ave, Victoria, BC V8B 2X3
Telephone: 250-381-6522 Fax: 250-381-6523

Approx. Cut Volume = 4,494,655 cu m's

EASEMENTS
ACCESS EASEMENT 128144G

PARCEL D
OF LOT 89
(DD 174323-I)

PLAN VIP61301

Sooke Lake Road

REMAINDER 1
PLAN VIP51874

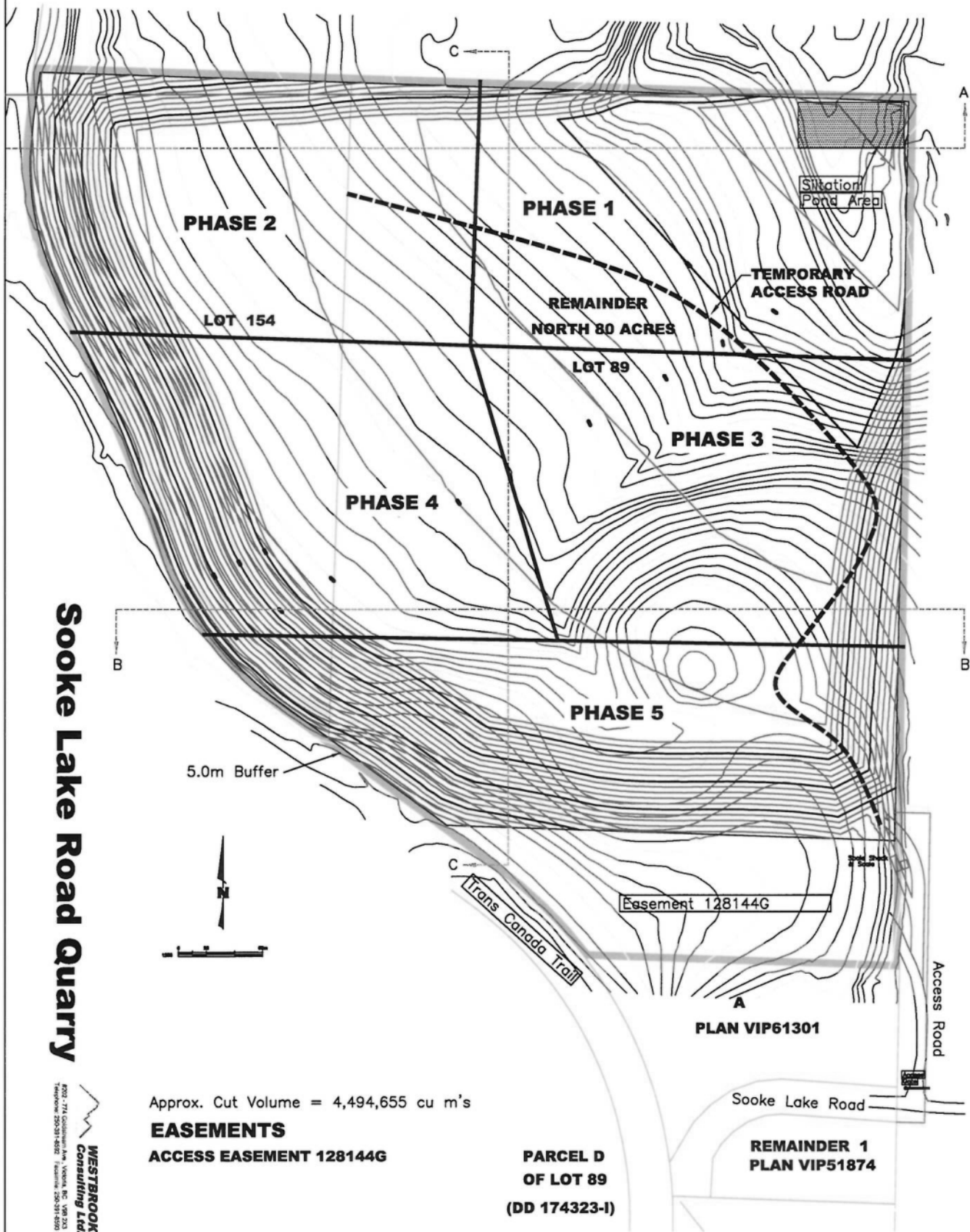

Sedimentation Pond Detail

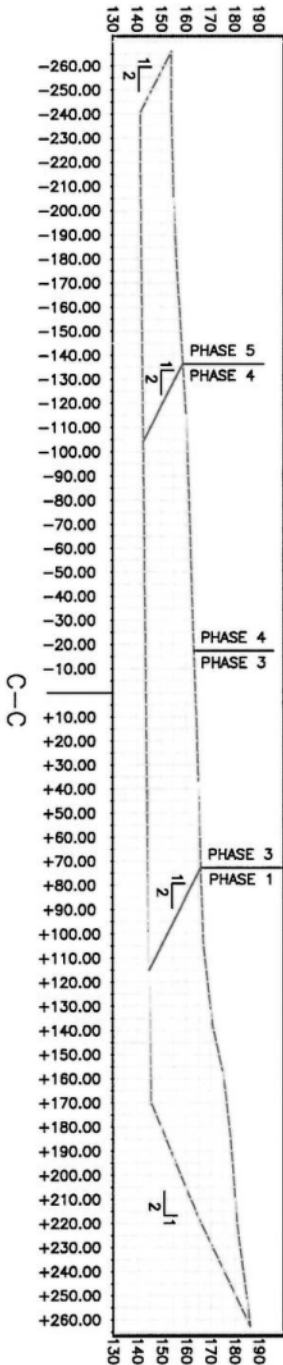
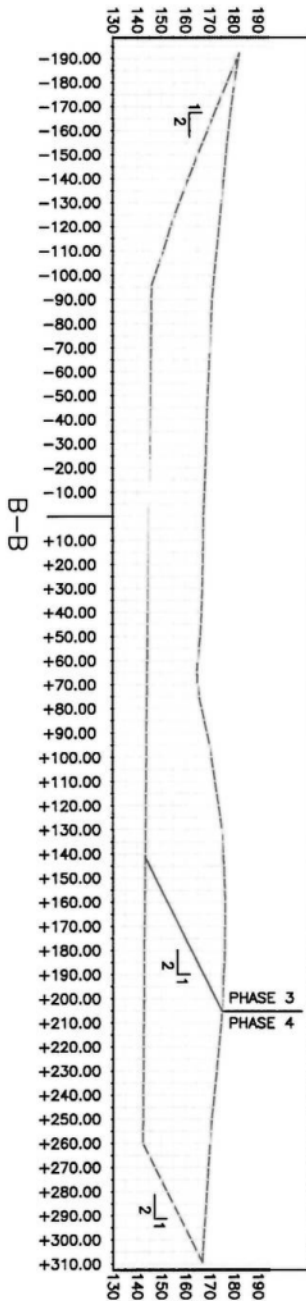
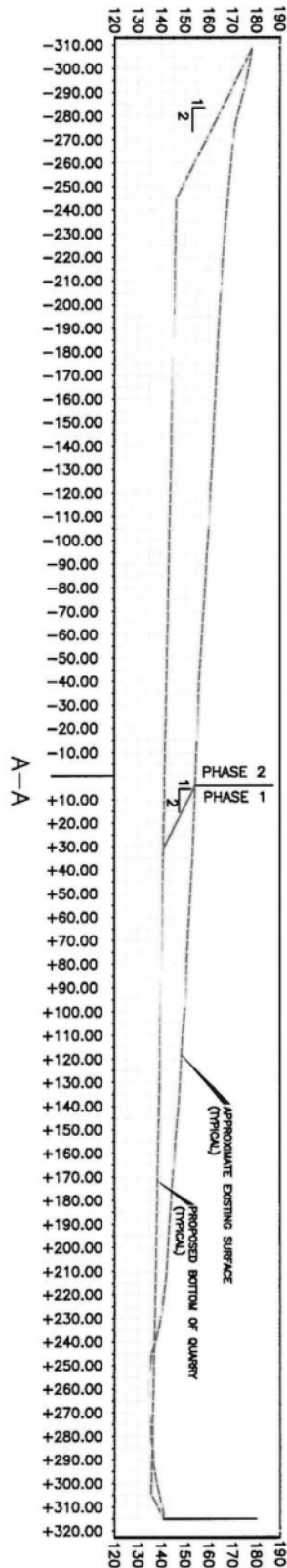
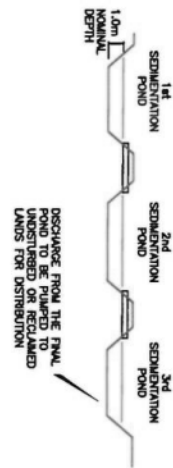

Sooke Lake Road Quarry

WESTBROOK
Consulting Ltd.
8222-774 Goldstream Ave. Victoria, BC V8B 2A3
Telephone: 250-381-8522 Fax: 250-381-8593

PROVINCE OF BRITISH COLUMBIA
MINISTRY OF ENERGY, MINES AND PETROLEUM RESOURCES

SAND AND GRAVEL PERMIT
APPROVING WORK SYSTEM AND RECLAMATION PROGRAM
(Issued pursuant to Section 10 of the **Mines Act** R.S.B.C. 1996, C.293)

Permit: **G-8-339**

Mine No.: **1610437**

Issued to: **Sooke Lake Road Holdings Inc.**
635 Roseridge
Victoria BC V8Z 2Z1

for work located at the following property:

Sooke Lake Quarry

This approval and permit is subject to the appended conditions.

Issued this 12th day of February in the year 2010.



Ed Taje
Senior Inspector of Mines, for
Al Hoffman, P.Eng
Chief Inspector of Mines

PREAMBLE

Notice of intention to commence work on a sand and gravel pit, including a plan of the proposed work system and a program for the protection and reclamation of the surface of the land and watercourses affected by the Notice of Work dated Tuesday, October 21, 2008 was filed with the Inspector of Mines on Tuesday, October 21, 2008. Notice of such filing was published in the Times Colonist on July 23, 2009 and in the Gazette on July 23, 2009.

This permit contains the requirements of the Ministry of Energy, Mines and Petroleum Resources for reclamation. It is also compatible, to the extent possible, with the requirements of other provincial ministries for reclamation issues. The amount of security required by this permit, and the manner in which this security may be applied, will also reflect the requirements of those ministries. Nothing in this permit, however, limits the authority of other provincial ministries to set other conditions, or to act independently, under their respective permits and legislation.

Decisions made by staff of the Ministry of Energy, Mines and Petroleum Resources will be made in consultation with other ministries.

CONDITIONS

The Chief Inspector of Mines (Chief Inspector) hereby approves the work plan and the program for protection and reclamation of the land surface and watercourses subject to compliance with the following conditions:

1. Reclamation Security

- (a) The owner, agent or manager (herein called the Permittee) shall maintain with the Minister of Finance securities in the amount of Twenty Two Thousand Seven Hundred Fifty Dollars (\$22,750.00). The security will be held by the Minister of Finance for the proper performance of the approved program and all the conditions of this permit in a manner satisfactory to the Chief Inspector.
- (b) The Permittee shall conform to all forest tenure requirements of the Ministry of Forests. Should the Permittee not conform to these requirements then all or part of the security may be used to cover the costs of these requirements.

- (c) The Permittee shall conform to all Ministry of Environment approval, license and permit conditions, as well as requirements under the **Wildlife Act**. Should the Permittee not conform to these conditions, then all or part of the security may be used to fulfill these requirements.

2. Land Use

The surface of the land and watercourses shall be reclaimed to the following land use: Acreage residential.

3. Productivity

The level of land productivity to be achieved on reclaimed areas shall not be less than existed prior to mining on an average property basis unless the Permittee can provide evidence which demonstrates, to the satisfaction of the Chief Inspector, the impracticality of doing so.

4. Revegetation

Land shall be re-vegetated to a self-sustaining state using appropriate plant species.

5. Use of Suitable Growth Medium

- (a) On all lands to be re-vegetated, the growth medium shall satisfy land use, productivity, and water quality objectives. Topsoil and overburden (to rooting depth) shall be removed from operational areas prior to any disturbance of the land and stockpiled separately on the property for use in reclamation programs, unless the Permittee can provide evidence which demonstrates, to the satisfaction of the Chief Inspector, that reclamation objectives can otherwise be achieved.
- (b) No topsoil shall be removed from the property without the specific written permission of the Inspector of Mines.

6. Buffer Zones and Berms

Buffer zones and/or berms shall be established between the mine and the property boundary unless exempted in writing by the Inspector of Mines.

7. Treatment of Structures and Equipment

Prior to abandonment, and unless the Chief Inspector has made a ruling otherwise, such as heritage project consideration or industrial use,

- (a) all machinery, equipment and building superstructures shall be removed,
- (b) concrete foundations shall be covered and revegetated unless, because of demonstrated impracticality, they have been exempted by the Inspector, and
- (c) all scrap material shall be disposed of in a manner acceptable to the Inspector.

8. Watercourses

- (a) Watercourses shall be reclaimed to a condition that ensures
 - (1) long-term water quality is maintained to a standard acceptable to the Chief Inspector,
 - (2) drainage is restored either to original watercourses or to new watercourses which will sustain themselves without maintenance, and
 - (3) use and productivity objectives are achieved and the level of productivity shall not be less than existed prior to mining unless the Permittee can provide evidence which demonstrates, to the satisfaction of the Chief Inspector, the impracticality of doing so.
- (b) Water which flows from disturbed areas shall be collected and diverted into settling ponds.

9. Roads

- (a) All roads shall be reclaimed in accordance with land use objectives unless permanent access is required to be maintained.

(b) Individual roads will be exempted from the requirement for total reclamation under condition 9(a) if either:

- (1) the Permittee can demonstrate that an agency of the Crown has explicitly accepted responsibility for the operation, maintenance and ultimate deactivation and abandonment of the road, or
- (2) the Permittee can demonstrate that another private party has explicitly agreed to accept responsibility for the operation, maintenance and ultimate deactivation and abandonment of the road and has, in this regard, agreed to comply with all the terms and conditions, including bonding provisions, of this reclamation permit, and to comply with all other relevant provincial government (and federal government) regulatory requirements.

10. Disposal of Fuels and Toxic Chemicals

Fuels, chemicals or reagents which cannot be returned to the manufacturer/supplier are to be disposed of as directed by the Chief Inspector in compliance with municipal, regional, provincial and federal statutes.

11. Temporary Shutdown

If this sand and gravel pit ceases operation for a period longer than one year the Permittee shall either continue to carry out the conditions of the permit or apply for an amendment setting out a revised program for approval by the Chief Inspector.

12. Safety Provisions

All safety and other provisions of the **Mines Act** shall be complied with to the satisfaction of the Chief Inspector.

13. Monitoring

The Permittee shall undertake monitoring programs, as required by the Inspector of Mines, to demonstrate that reclamation objectives are being achieved.

14. Alterations to the Program

Substantial changes to the program must be submitted to the Inspector of Mines for approval.

15. Notice of Closure

Pursuant to Part 10.6.1 of the Health, Safety and Reclamation Code for Mines in British Columbia, a Notice of Completion of Work shall be filed with the Inspector of Mines not less than seven days prior to cessation of work.

16. Annual Report

Annual reports shall be submitted in a form and containing the information as and if required by the Inspector of Mines.

17. Site Stability

- a) The inspector shall be advised in writing at the earliest opportunity of any unforeseen conditions that could adversely affect the extraction of materials, site stability, erosion control or the reclamation of the site.
- b) The stability of the slopes shall be maintained at all times and erosion shall be controlled at all times.
- c) The discovery of any significant subsurface flows of water, seeps, substantial amounts of fine textured, soils, silts and clays, shall be reported to the inspector as soon as possible and work shall cease until the inspector advises otherwise.

SITE SPECIFIC CONDITIONS:

- 1. Suitable methods of dust control, including water sprays, shall be utilized to mitigate dust created from mining/processing operations including haulage on and from site. In addition a log book shall be kept to record the date, time, and person(s) applying the dust control. If multiple methods and/or applications are required, each instance shall be logged.
- 2. Topsoil and overburden shall be stockpiled, protected from erosion, and used to rehabilitate the site upon completion of mining. The area shall be replaced with native species ecologically suited for the site.

3. The Permittee shall ensure that;
 - a) The property boundary shall be marked and maintained for the life of the mine.
 - b) The mine footprint boundary shall be marked and maintained for the life of the mine.
 - c) All persons working on the site are instructed as to the meaning of the markings.
4. This permit does not authorize the importing of any fill material.
5. The Permittee shall ensure a minimum of 25m buffer from the mine boundary and the TransCanada Trail be maintained throughout the life of the operation.
6. Operating hours shall be from 7:00 AM to 4:00 PM Monday to Friday and there shall be no work on Saturday, Sunday or Statutory Holidays.
7. Notwithstanding the hours of work provisions of Permit G-8-339, the permittee is authorized to conduct work outside of this provision should:
 - a) An agency having jurisdiction declare an emergency and the product from this site is required to mitigate an emergency.
 - b) A safety concern on site is such that a failure, to complete necessary work can result in harm or risk to workers, or members of the public.
 - c) If an environmental incident on site has occurred and a failure to address or mitigate the incident can result in harm to the receiving environment.
8. Sediment laden water resulting from mining activities, including surface drainage, shall not be allowed free access to creeks or water courses but shall be suitably contained and /or treated to produce final effluent not exceeding 25 mg/l total suspended solids prior to discharge.
9. Appropriate measures shall be taken to protect against inadvertent access to the settling pond(s) and wells, if applicable.
10. Screening, crushing, and blasting of material on site, as described in the Notice of Work, is authorized under this permit.
11. Construction of suitable high & thick berms shall be provided around the crushing and screening equipment to mitigate fugitive noise and, to prevent inadvertent access by wheeled equipment.
12. Machinery operating near a watercourse and/or settling pond shall be in good repair and free of oil leaks and free of surface oil and grease.
13. The operator shall ensure that the proposed mining activities do not affect nesting birds, in accordance with Section 34 of the *Wildlife Act*. Typical species of interest would be Heron, Eagle, Peregrine Falcon, Spotted Owl and primary cavity nesters.

14. All work shall be suspended during any forest closures relating to extreme fire hazard conditions as determined by the Ministry of Forests and Range. Firefighting equipment shall be maintained on the site in accordance with the Forest Fire Prevention and Suppression Regulation.
15. In the event that an archeological site is encountered during the course of the approved mining activities, the program shall be suspended or modified in such a manner so as to ensure that the site is not damaged, desecrated, or otherwise altered, and the occurrence shall be reported immediately to the Archeological Branch of the Ministry of Sustainable Resources Management and the Ministry of Energy and Mines. Work shall not be resumed until authorized by the joint Ministries.
16. The Permittee shall initiate progressive reclamation where possible to control erosion around the mine area.
17. The Permittee shall immediately contain and implement remedial measures for any spill of hydrocarbon or other deleterious substance at the mine site. Any such occurrence shall be reported to the Inspector of Mines, and to the Provincial Emergency Program in accordance with the Spill Reporting Regulation of the Environmental Management Act. Contaminated materials shall be disposed of in a manner acceptable to the Regional Waste Manager. Any spill of hydrocarbons requiring reporting under the Transportation of Dangerous Goods regulations shall be considered a Dangerous Occurrence.
18. The Permittee shall develop a well monitoring program at one or more of the properties located to the north of the mine.
 - a) This condition may be waived if the inspector is advised in writing of the refusal by the property owner to participate in the monitoring program.
 - b) All records of the monitoring program shall be filed at the mine office and made available to an inspector upon request.
19. Offsite trucking shall be scheduled such that trucks do not arrive or depart the mine site at 1875 Sooke Lake Rd. during periods when schools bus pickups and drop offs are scheduled for Elementary schools.
20. Machinery shall not be operated in a water course or riparian area.
21. Absorbent pads and spill kits of adequate size shall be maintained on site during the course of operations. These shall be located in all areas where work is being conducted.
22. Open trenches and pits/ponds shall be fenced or otherwise protected against inadvertent access by people or equipment.

23. The Permittee shall ensure that a buffer is maintained between any watercourse or riparian area and the area of excavation. (Refer to the Health, Safety and Reclamation Code for Mines in British Columbia, Part 9, Table 9.1, Riparian Setback Distances.)
24. All waste and refuse shall be removed from the site weekly.
25. The Permittee shall prepare and maintain a refueling procedure prior to the start of operations, and include it as part of the Fuel Management and Spill Contingency Plan. The procedure shall be available to all supervisors and workers and personnel directly involved with refueling shall be properly instructed.
26. Stationary engines shall be provided with drip pans that shall be cleaned on a regular basis.
27. All site access shall be secured with a locking gates and signage provided indicating the operators name and emergency contact number, as well as all necessary safety advisories.
28. The site shall not be used for any other purpose than that described in the Notice of Work dated, dated October 21, 2008 . Disused or damaged equipment shall not be stored on site and the site shall not be used for the disposal of items including but not restricted to, garbage, wood waste, toxic materials, and petroleum waste.
29. Access roads created or utilized under this permit shall be provided with adequate drainage, appropriately ditched, and/or water barred.
30. The Permittee shall undertake monitoring programs, as directed by an Inspector of Mines, to demonstrate and ensure all environmental and reclamation objectives are achieved.
31. The Permittee shall contact the Inspector of Mines and the office of Terasen Gas once site development occurs on the west side of the property, as indicated in phase 2, phase 4, and phase 5, of your mine development plan.
32. The Permittee shall ensure that every blast initiated on the site is electronically monitored and all records are stored onsite for review by an inspector upon request.

33. The Permittee shall ensure that during any blast:
 - a) Peak Particle Velocity (PPV) shall not exceed 50mm/sec or 2 inches/sec.
 - b) Air Blast (overpressure) shall not exceed 120 Db on the "L" scale.
 - c) Loading of blast holes when using ANFO shall be controlled to prevent spillage and, any spillage shall be cleared and not allowed to accumulate on the pit floor.
34. The manager shall report without delay, any blast which exceeds the limits as stated above.
35. Where there is potential for fly rock beyond the property boundary, such as the TransCanada Trail, the manager shall ensure that blast mats or other suitable coverings are used.
36. The Permittee shall develop and implement a written safe work procedure for the guarding of Sooke Lake Road, and the TransCanada Trail prior to any blast.
37. In advance of any blast the manager shall:
 - a) Provide 24 hr. notice to all residence within 1 km of the blast site.
 - b) Post a sign at the entrance to the Quarry indicating that a blast is scheduled, the date and time of the blast and contact information.