



For Ministry Use Only:

FILE #: 15700-20/C4 Ranching
STOCK RANGE: West

AGREEMENT #: RAN077136
RANGE UNIT AND #: Kenny-Corkscrew 4070

BETWEEN: HER MAJESTY THE QUEEN IN RIGHT
OF THE PROVINCE OF BRITISH COLUMBIA
c/o: THE DISTRICT MANAGER

of: VANDERHOOF DISTRICT
1560 HIGHWAY 16 EAST, PO BOX 190
VANDERHOOF, BRITISH COLUMBIA
V0J 3A0

("the Province")

AND: C4 RANCHING
A DIVISION OF CORSA CONTRACTING LTD
P.O. BOX 735
VANDERHOOF, BRITISH COLUMBIA
V0J 3A0

("the Agreement Holder")

This Agreement is dated for reference this 1st day of January, 2014.

The Province hereby grants rights to the Agreement Holder over Crown range in accordance with the *Range Act* on the following terms and conditions:

1. TERM

The Term of this Agreement will be as follows:

	Year	Month	Day
Start:	2014	January	01
Expiry:	2018	December	31

("the Term")

2. AGREEMENT AREA

The area over which the rights are granted is the Crown range within the area outlined in bold black on the attached Exhibit A map, less any of the following:

- a) exclusions noted on the Exhibit A
- b) exclusions arising from Exhibit B conditions
- c) exclusions arising from the Range Use Plan or Range Stewardship Plan associated with this agreement.

("the Agreement Area")

3. AMOUNT OF FORAGE

Authorized Yearly Use is 387 animal unit months ("AUMs") on the Agreement Area.

4. ITS

The Agreement Holder will have the right to graze livestock on the Agreement Area under the terms and conditions of this Agreement and its associated Range Use Plan or Range Stewardship Plan.

5. ASSOCIATED PRIVATE LAND

The Agreement Holder's associated private lands are listed in Exhibit C of this Agreement.

6. RANGE USE PLAN or RANGE STEWARDSHIP PLAN

The Agreement Holder will prepare and maintain a Range Use Plan or Range Stewardship Plan as required in the *Range Act* and the *Forest and Range Practices Act*.

7. FINANCIAL

- (a) The Agreement Holder will pay ground rent, grazing fees, fines and any other financial assessments as required under the *Range Act*.
- (b) The Agreement Holder will pay the interest on overdue accounts and any other financial assessments provided for by law and arising from the use of Crown range.
- (c) Fees and all other financial assessments must be paid as specified on the Province's invoices or statements. The District Manager may require payment of fees in advance of livestock turnout.

8. COMPLIANCE WITH LAWS

The Agreement Holder will comply with all provisions of the following Acts and their regulations: the *Range Act*, the *Forest and Range Practices Act*, the *Livestock Act*, the *Livestock Identification Act* and the *Animal Disease Control Act*. Any breach of these Acts or their regulations will be considered to be a breach of this Agreement.

9. TEMPORARY REDUCTION IN GRAZING USE FOR ENVIRONMENTAL REASONS

- (a) The District Manager or Forest Officer may, by issuing a written order, require a temporary reduction or adjustment in grazing use because of the adverse effects of weather, fire, flood or other environmental factors.
- (b) If the District Manager or Forest Officer issues an order pursuant to (a) and the order results in a reduction of 10% or more of Net Authorized Yearly Use, the amount of fees will be reduced proportionately.

10. LIVESTOCK OWNERSHIP AND CONTROL

The Agreement Holder will graze on the Agreement Area only livestock, which the Agreement Holder owns or controls by lease. The District Manager must approve any livestock lease agreements. The District Manager may grant an exemption to the provisions of this paragraph.

11. INFECTIOUS OR CONTAGIOUS DISEASES

The Agreement Holder will not graze livestock, which has any infectious or contagious disease or other condition that is a material risk to other livestock, wildlife or humans, on the Agreement Area or on any Private Land that is not separated from crown range by a fence or other barrier to livestock movement, or on any land subject to a Private Land Agreement.

12. COMPLIANCE WITH LIVESTOCK ASSOCIATION

Unless exempted by the District Manager, the Agreement Holder will comply with local Livestock Association's reasonable rules and fee assessments for the construction and maintenance of authorized range improvements on the Agreement Area, or for services on the Agreement Area.

13. (AIMS

- (a) The Agreement Holder will reimburse the Province for any loss caused to the Province as a result of the Agreement Holder's negligent or wilful default in the use of the Agreement Area.
- (b) The Province will not be responsible for the death, injury, or theft of livestock, or theft or damage to property belonging to the Agreement Holder.
- (c) The Province will not be responsible for any damage to range developments, except damage wilfully done by the Province or resulting from activities specifically authorized by the Province.
- (d) The Agreement Holder will have no claim against the Province for reimbursement for loss arising from deficiencies in the quality or quantity of forage on the Agreement Area.

14. NOTICES

Any notices will be served in the manner provided in the *Range Act*.

15. SPECIAL CONDITIONS

Conditions set out on any Exhibit B will form part of this Agreement. If there is any contradiction between any such conditions and any other terms of this Agreement, the Special Conditions will prevail.

Notice to Agreement Holder on Obligations, Compliance and Enforcement

The obligations of the Agreement Holder in the use of Crown range arise both from this Agreement and from relevant legislation such as the *Range Act* and the *Forest and Range Practices Act*. Lack of compliance could subject the Agreement Holder to a variety of remedies such as administrative penalties, tickets, suspension and cancellation of this Agreement or prosecution for offences. Among the topics requiring attention is the maintenance responsibility of the Agreement Holder for range developments.

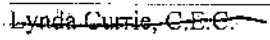

David Van Dolah, RFT
Designated



Lynda Currie, C.E.C.
District Manager
Vanderhoof/Fort St. James Districts

Signature of Witness

Name of Witness

C4 Ranching, a Division of
Corsa Contracting Ltd.*

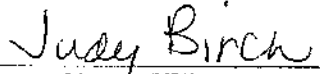
Signature of Witness

Name of Witness

* or Authorized Signatory if the Agreement Holder is a corporation

**ASSOCIATED LANDS
RANGE AGREEMENT RAN077136**

Page 4 of 11 FNR-2016-61965

Range use plan template for livestock grazing

Prepared by the Range Agreement Holder

This template outlines the elements of range use plans as required by the *Forest and Range Practices Act* and the Range Practices and Planning Regulation.

If a range use plan includes *unfenced grazing land* (unfenced private land grazed in common with Crown range), only the grazing schedule applies to that private land. The District Manager may approve a schedule for any time period provided that stock control is adequate to prevent trespass on Crown range.

RANGE USE PLAN

GRAZING PERMIT RAN077136

The District Manager, pursuant to section 37 of the *Forest and Range Practices Act*, has determined that this range use plan is consistent with the agreement under the Range Act that pertains to the plan, and conforms to the *Forest and Range Practices Act*, the regulations and the standards.

This range use plan is associated with the following range agreement(s).

NAME: C4 Ranching, A Division of
Corsa Contracting Ltd.

ADDRESS: P.O. Box 735
Vanderhoof, BC
V0J 3A0

TELEPHONE: (250)567-9724

RANGE AGREEMENT #: RAN077136

FILE #: 15700-20/C4 Ranching

STOCK RANGE: West

RANGE UNIT: Kenny- Corkscrew 4070

This plan was prepared by: Daniel Weaver

Agreement holder's signature* 

Date June 13, 2014

Date _____

Date _____

*Or authorized signatory if agreement holder is a corporation

This range use plan takes effect: 2014 01 01
yyyy mm dd

This range use plan expires on: 2018 12 31
yyyy mm dd

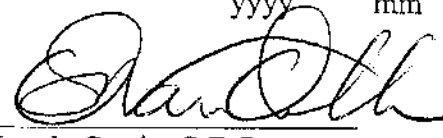
Approved by: 

Date: 2014/06/24

Lynda Currie, C.E.C. David Van Dolah, RFT yyyy mm dd
District Manager Designated
Vanderhoof/Fort St. James Districts

Range Use Plan for Livestock Grazing

Map:

Grazing schedule:

<i>Pasture</i>	<i>Class and No. of Livestock</i>	<i>Period of use</i>	<i>Range Readiness Criteria*</i>	<i>Average stubble height at end of period*</i>	<i>Max % of browse use</i>	<i>Plant community * and monitoring site</i>	<i>Private land deduction</i>
Range	Up to 250 cow/calf pairs and 14 bulls may be on range during the period of use. Not to exceed 387 AUMs	May 21 to Sept. 30	4 leaf stage for blue wildrye and soils are dry enough to withstand livestock use without becoming rutted or compacted	15 cm for blue wildrye	25%	Darryl's woodlot	140 aums
Wetlands and riparian areas			3 leaf stage for bluejoint and soils are dry enough to withstand livestock use without becoming rutted or compacted	12 cm for bluejoint	25%		

*if required by the minister

Actions to be carried out to address prescribed matters or issues.

(i) Actions to deal with issues identified by the Minister:

Issues	Actions
Portion of Woodlot Licence 620 (Kochel), 621 (Kells), 253 (Douglas), 631 (Weinhardt-Austin), 212 (Weaver) and 1416 (Darrell Weaver) are within the range tenure boundaries, manage for cow-seedling interaction	<ul style="list-style-type: none"> - Will review maps and logging plans sent to me and will respond if I have any comments or concerns - Weekly checks of cattle and seedlings in plantations, will move livestock out of area if they have damaged 10% of seedlings in a 1 ha area - Will meet with woodlot licensees if necessary to discuss logging and range planning
Corkscrew Creek is the main source of rainbow trout production for Nulki Lake and stream enhancement activities have been carried out along portions of the creek. Maintain properly functioning condition on Corkscrew Creek and its associated tributaries	<p>I will manage cattle in the following way to maintain properly functioning condition:</p> <ul style="list-style-type: none"> - Will follow grazing schedule and move cattle out of the riparian area if they have grazed or browsed below the levels in the grazing schedule - Will check cattle in riparian areas weekly - Will move salting sites as often as practicable
The Vanderhoof District will have an increase in harvesting to address the impacts of the mountain pine beetle. Natural range barriers may be removed, potentially affecting livestock movement	<ul style="list-style-type: none"> - Will review logging plans and maps sent from licensee and will respond if I have any comments or concerns - Will meet with woodlot licensees' if necessary to discuss logging and range planning
Many plantations within the agreement area are not yet free growing. Minimize the risk of trampling and browsing damage	<ul style="list-style-type: none"> - Weekly checks of cattle and plantations, will move cattle out of area if cattle damage more than 10% of seedlings in a 1 ha area
A portion of Corkscrew Creek has been designated a Fish and Wildlife Reserve by the Vanderhoof Crown Land Plan	<ul style="list-style-type: none"> - Will review that fence is up prior to turnout and notify MFR - Will remove cattle if they get inside the fenced reserve

(ii) Plant communities (if any):

Plant community	Actions to establish or maintain plant communities
Mature aspen canopy over rose, Saskatoon, snowberry, red osier dogwood and black twinberry. Herb layer is composed of bluejoint, blue wildrye, fringed brome, peavine and asters	<ul style="list-style-type: none">- Will monitor stubble heights and browse use on weekly checks and will move cattle if they graze or browse below the levels of use in grazing schedule- Will move salting sites as often as practicable
Sedges, bluejoint and reed canary with willow and aspen on the fringes	<ul style="list-style-type: none">- Will monitor stubble heights and browse use on weekly checks and will move cattle if they graze or browse below the levels of use in grazing schedule- Will move salting sites as often as practicable
Slender wheatgrass, reed canary, bluejoint, with fireweed, spirea. Shrubs include Saskatoon, rose and raspberry	<ul style="list-style-type: none">- Will monitor stubble heights and browse use on weekly checks and will move cattle if they graze or browse below the levels of use in grazing schedule- Will move salting sites as often as practicable

(iii) Measures to prevent the introduction and spread of invasive plant species:

- Will report invasive plants to Ministry of Forests, Lands and Natural Resource Operations
- Will grass seed disturbed soil with certified seed
- Will hand pull weeds where practicable



MAP OF : RAN077136 (shown in bold black)

FOREST REGION : RNI FOREST DISTRICT : DVA	TSA : PAG10 LAND DISTRICT : RANGE 4 COAST DISTRICT	PULPWOOD AGREEMENT : PAG10	MGT UNIT TYPE : TIMBER SUPPLY AREA MGT UNIT NO : 24
ESF SUBMISSION ID : 519338 BCGS MAPSHEET NO : 93F.089	SCALE : 1:100000 at B Size Area (Ha): 13362.8323	UTM : 10 NAD : NAD83	DRAWN BY : FTA DATE : Dec 11, 2008

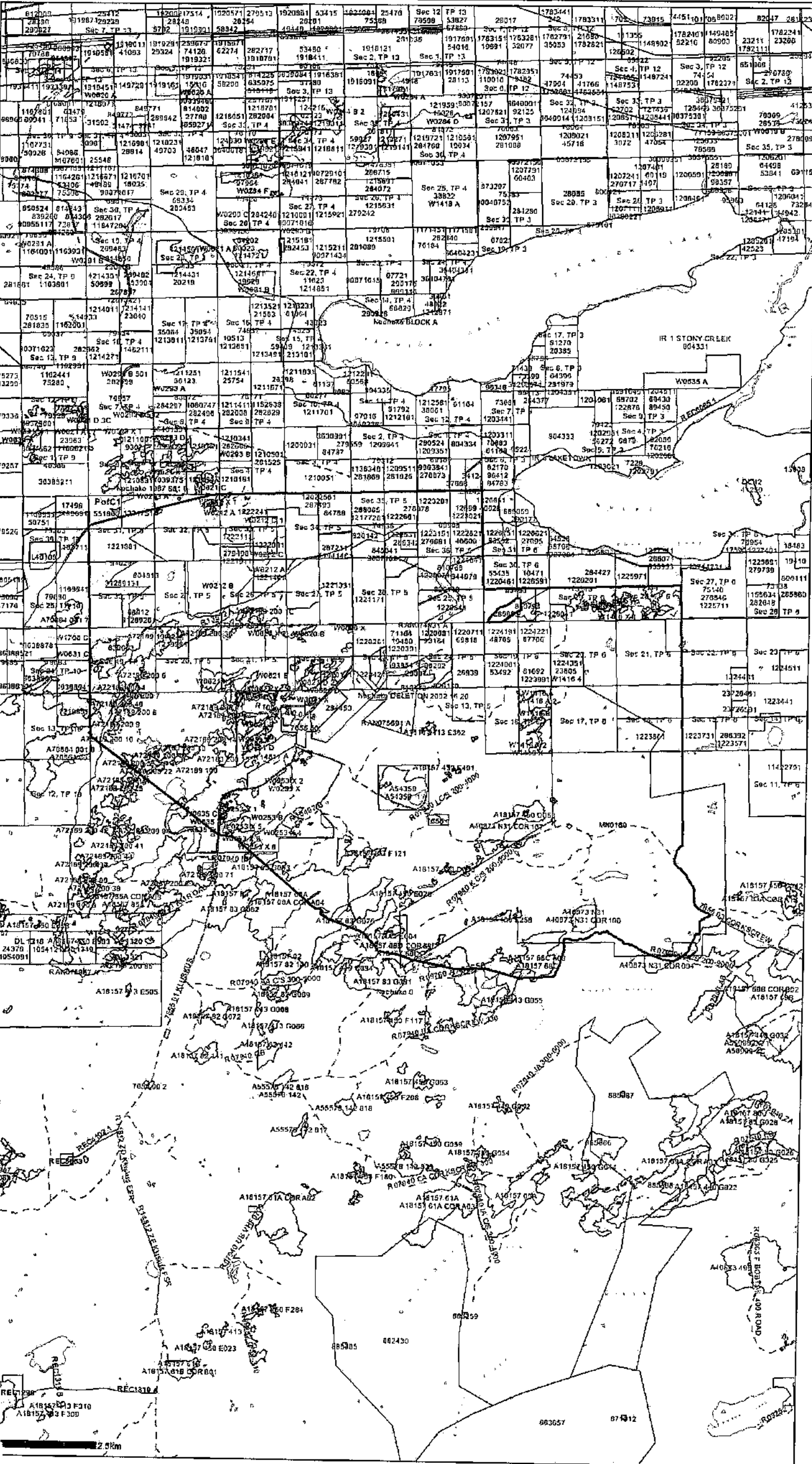
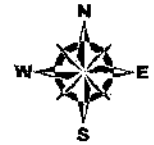

Legend

- Tenure Application
- Tenure Road Application
- Relined Tenure Road
- P of C
- P of T
- Tenure Feature
- Range
- TFL
- Provincial Forest
- Forest Service Road
- Highway
- Municipal Road
- Non Status Road
- Recreation Trails
- Road Permit
- SUP Road
- Right of Way
- Schedule B CP Road
- Mineral Tenure Points
- Cities
- Waterbodies
- River/Stream
- Coastline / Island

1 (13362.8323 Ha)
 PolC1 UTM10 411099, 5973968
 PolC2 UTM10 420790, 5971338



Range Use Plan

2013

C4 Ranching (corsa)

RAN077136

Map Scale: 1:40,000

Legend

-  CABIN
-  CATTLEGUARD
-  CORRAL
-  CROSSING
-  GATE
-  SALT
-  WATER DEVELOPMENT
-  FENCE
-  STOCK TRAIL
-  WATER DEVELOPMENT
-  Highways
-  FSR
-  Permitted Roads
-  Mapsheet Grid (1:20,000)
-  Active Range
-  Marsh
-  Swamp
-  River or Stream - Definite
-  Lake - Definite
-  Indian Reserves
-  UWR
-  Protected Areas
-  Wildlife Habitat Man Areas

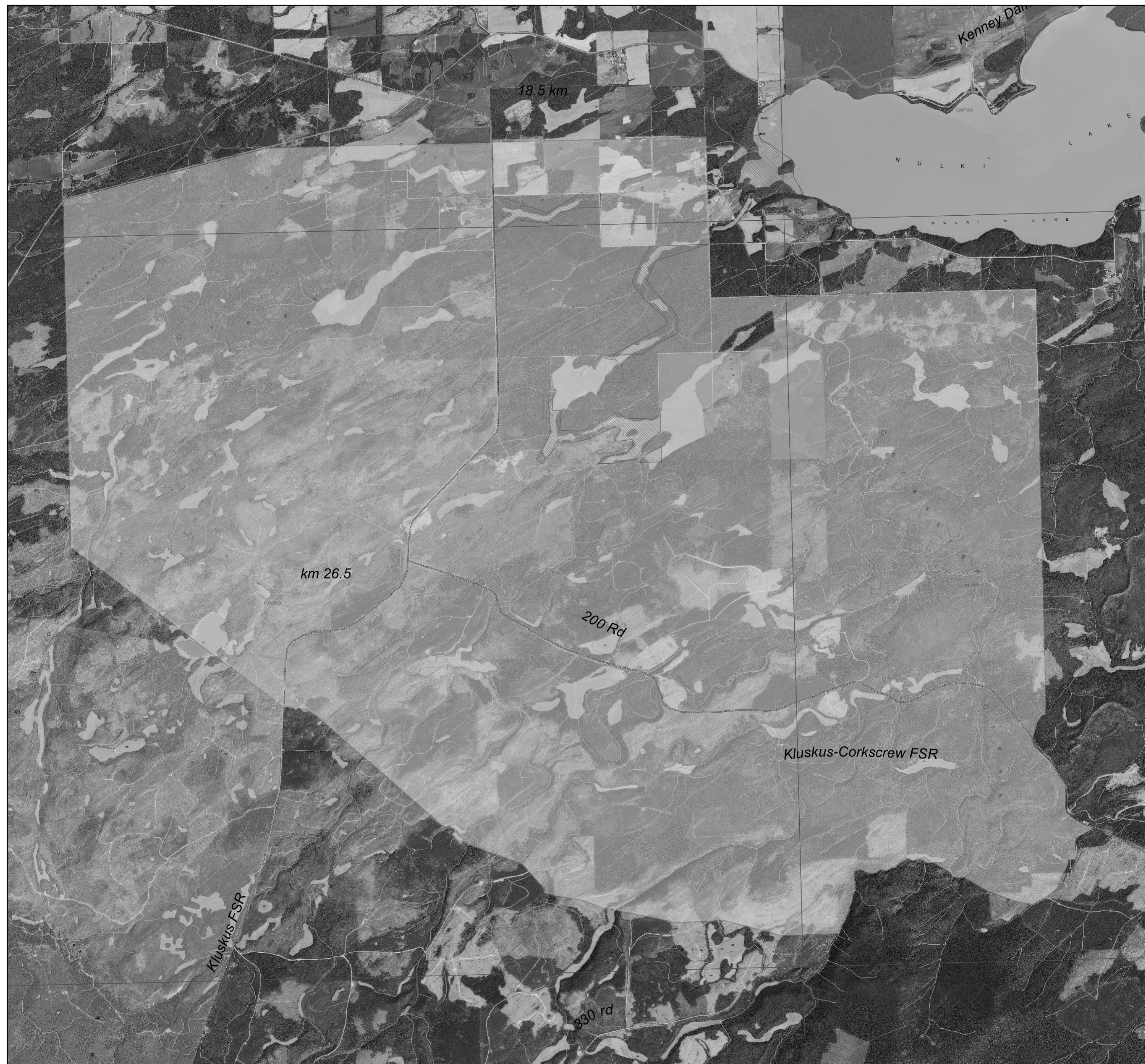

Photography date: 2012