



Province of
British Columbia

Ministry of
Environment
and Parks

Parks and Outdoor
Recreation Division
Southern Interior Region
101, 1050 West Columbia Street
Kamloops, B.C.
V2C 1L4
Phone: (604) 828-4501



OUR FILE 2-3-2-12

YOUR FILE

87.05.11

Mr. G. J. Sutherland, P. Eng.
Regional Director, Highways
Ministry of Transportation and Highways
310 Ward Street
Nelson, B.C.
V1L 5S4

Attn: B. W. Pearce, Regional Approving Officer

Dear Mr. Pearce:

RE: Promenade Fronting Lots 13-16, Plan 1514, and Lots 1-3
Plan 5247, Moyie Lake Provincial Park

Thank you for your response of April 30, 1987, to our letter
of 87.03.31 on this subject.

Your suggestion to issue B.C. Parks a permit to carry out
park related improvements on the promenade between the two components
of Moyie Lake Park would facilitate public use of the area. However,
this arrangement does not address our problem of controlling
undesirable activities such as drinking or loud parties on the
promenade under our own authority. We would technically have to rely
on police assistance to resolve even minor disturbances.

Would you be prepared to have us approach the upland
landowners about this situation and seek support for redesignation of
the promenade as Park? If they could be persuaded that our control of
the area would provide them with greater security, your agency
presumably would be agreeable to redesignation of the promenade. If
the owners preferred the status quo, we could fall back on your offer
to permit facility development and hope for the best in terms of
public conduct.

We appreciate your Ministry's continuing cooperation in
resolving the public use problems on this promenade.

Yours truly,

M. E. Goddard
Regional Director

PRW:jv
Attachment

cc: N. O. Blackburn

J. Peebles, Lands - Cranbrook



Province of
British Columbia

Ministry of
Transportation
and Highways

Telephone: 354-6420



Phil?



YOUR FILE 2-3-2-12

OUR FILE R3-20-0(b)

Office of Regional Director
Ministry of Transportation
and Highways
Provincial Government Building
310 Ward Street
NELSON, British Columbia
V1L 5S4

April 30, 1987

Ministry of Environment and Parks
101 - 1050 West Columbia Street
KAMLOOPS, British Columbia
V2C 1L4

Attention: M. E. Goddard
Regional Director

Dear Sir:

Re: Promenade Fronting Lots 13-16, Plan 1514 and Lots 1-3,
Plan 5247, Moyie Lake Provincial Park

Thank you for your letter of March 31, 1987. As previously noted the private ownership matter remains a problem. A title search indicated Lot 13-16, Plan 1514 and Lot 1-3, Plan 5247 are privately owned.

I would point out this Ministry has no real interest or desire to hold this road allowance, but on the other hand, we are not prepared to handle possible objections to the closure of promenade.

A suggestion would be for this Ministry to issue a permit to the Ministry of Environment and Parks for the use, construction, maintenance of a public walkway, and carrying out any improvements deemed necessary by Ministry of Environment and Parks.

Yours truly,

G. J. Sutherland, P.Eng.,
Regional Director, Highways

by:

B. W. Pearce
Regional Approving Officer

BWP/mm

cc District Highways Manager, Cranbrook



Province of
British Columbia

Ministry of
Environment
and Parks

Parks and Outdoor
Recreation Division
Southern Interior Region
101, 1050 West Columbia Street
Kamloops, B.C.
V2C 1L4
Phone: (604) 828-4501



OUR FILE 2-3-2-12

YOUR FILE

87.03.31

Mr. G.J. Sutherland
Regional Highways Director
Ministry of Transportation
and Highways
310 Ward Street
Nelson, BC
V1L 5S4

Dear Sir:

Re: Promenade Fronting Lots 13-16, Plan 1514 and Lots 1-3,
Plan 5247, Moyie Lake Provincial Park

In 1980 the Parks Division had proposed addition of this promenade to Moyie Lake Provincial Park. Highways Regional Property Negotiator in Nelson advised that as a statutory requirement the property owners along the promenade would have to be canvassed and advised that the right-of-way as dedicated on the Subdivision Plan would be cancelled and added to the Park. At that time, it appeared that there would be objections from the property owners and in light of the statutory requirement, the proposal was dropped with the understanding that future park development would likely force the issue.

Last year the Parks Division initiated construction of a major day use beach and picnic facility development on D.L. 2800. A quarter of a million dollars has been spent on the project to date and another \$125,000 has been allocated to complete the facilities this year. The day use facility is intended to serve both local residents and destination users staying in the Park campground. You will note on the attached map of the Park that the promenade right-of-way forms a natural throughway connection from the Park campground to the day use area.

With planned completion of the facilities this year, it is essential that we secure a public walk-way between the campground and the day use area. Preferably the walk-way should fall under Parks jurisdiction to allow for regulation of public use of the land. However, if Park addition poses unreasonable complications there are likely other

. . . 2/

Mr. G.J. Sutherland
Page 2

87.03.31

options that can be pursued to construct and maintain the walk-way and to control its use. We would appreciate your Ministry's position and recommendations for establishing a park walk-way through the promenade right-of-way.

Yours truly,

A handwritten signature in black ink, appearing to read 'M.E. Goddard', with a large, stylized loop at the end.

M.E. Goddard
Regional Director

MRH:sg

cc: N.O. Blackburn
J. Peebles, Lands, Cranbrook

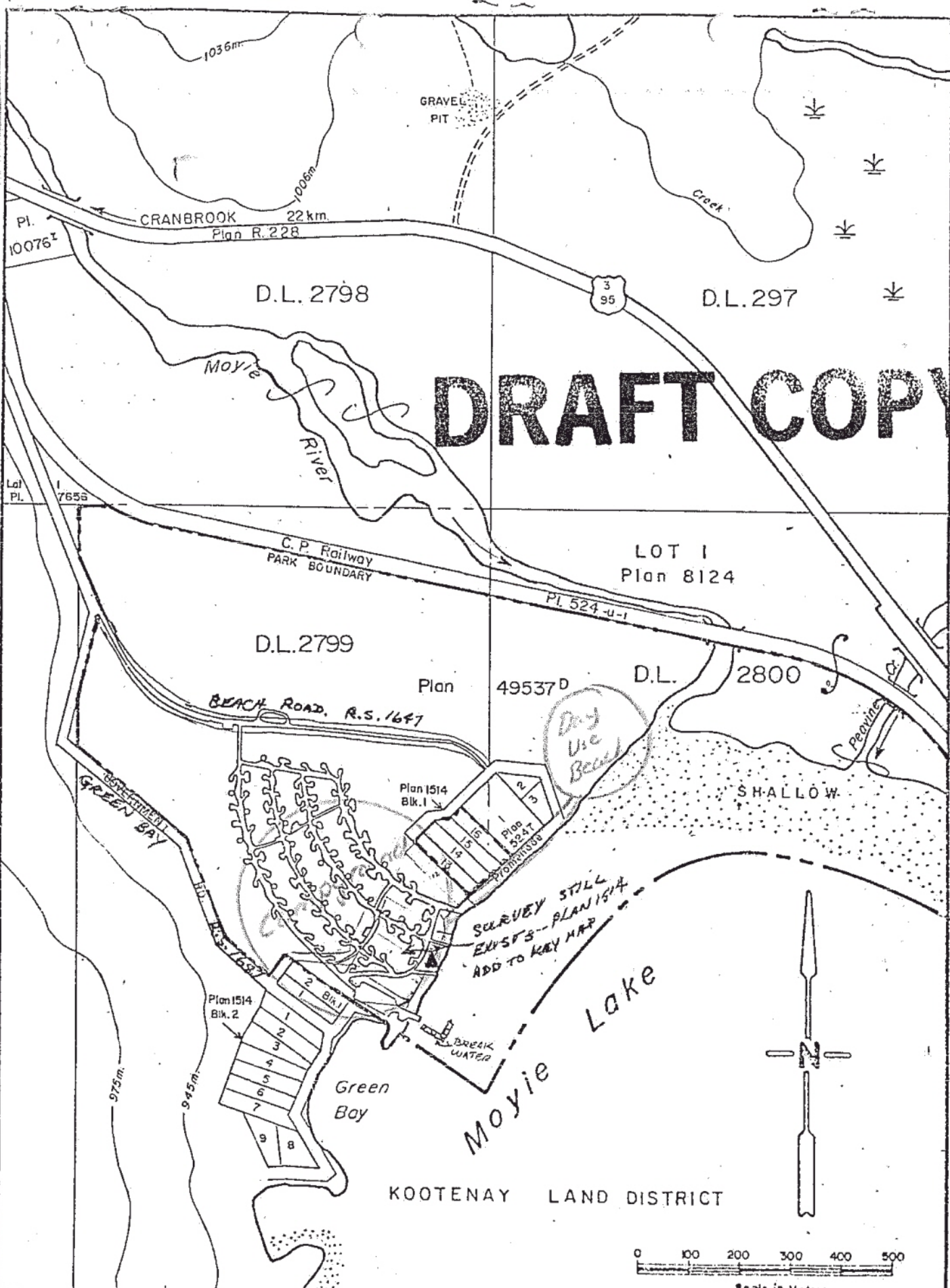

DRAFT COPY

Day Use Beach

SURVEY STILL EXISTS--PLAN 1514 ADD TO KEY MAP

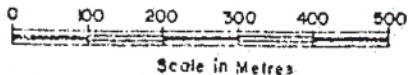
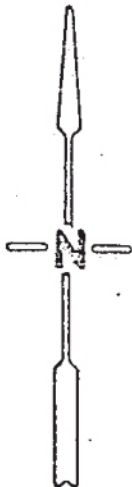

PROVINCE OF BRITISH COLUMBIA - MINISTRY OF LANDS, PARKS AND HOUSING - PARKS BRANCH - VICTORIA, B.C.

DATE	REVISED BY	CHECKED BY	REVISION

MOYIE LAKE PARK

FILE No: 2-3-2-12 DRAWN BY: J. H. G. DATE: March 28, 1967 3-2-12

PARK STATUS SHEET

PARK NAME:	<u>Moyie Lake</u>	FILE NUMBER:	<u>2-3-2-12-70</u>
CLASSIFICATION:	<u>A</u>	CATEGORY #:	<u></u>
SIZE:	<u>90 ha (69 ha upland 21 ha foreshore)</u>	N.T.S. MAP #:	<u>82 G/5</u>
ESTABLISHED:	<u>July 7, 1959</u>	STATUTE PARK:	<u>N/A</u>
PURCHASE:	<u>yes</u>	DONATION:	<u>N/A</u>
LOCATION:	<u>19 km south of Cranbrook</u>		

ADMINISTRATIVE DIVISION

PARK REGION:	<u>Kootenay</u>	PARK DIST:	<u>East Kootenay</u>
REGIONAL DIST.:	<u>East Kootenay</u>	ELECTORAL DIST.:	<u>Kootenay</u>
LAND DIST.:	<u>Kootenay</u>	ASSESSMENT DIST.:	<u>#22 Cranbrook</u>
ISLANDS TRUST:	<u>N/A</u>	SCHOOL DIST.:	<u>#2</u>
MINES DIST.:	<u>Fort Steele</u>	L.T.O.:	<u>Nelson</u>
F/W MGMT. UNIT:	<u>4-5</u>	DIST. FORESTER:	<u>Nelson</u>
HWY. REGION:	<u>Nelson</u>	HWY. DIST.:	<u>Cranbrook</u>

ORDERS-IN-COUNCILO.I.C. # - PURPOSE622/59 - Miscellaneous1574/59 - Establishment3937/73 - Miscellaneous159/83 - MiscellaneousO.I.C. # - PURPOSE

GREEN FILE REVISIONS

PARK NAME: Moyie Lake

FILE #:2-3-2-12-70

The following revisions have been made to the original Green File:-

[illegible]

SECTION 6 LANDS:
(Park Act)

N/A

MISCELLANEOUS:

N/A

RESOURCE CONSERVATION

A.L.R.:

All: _____ Partial: _____ None: X

ARCH. SITES:

DiPx-2

ECO. RES.:
(Established)

Name: N/A Site: _____ File: _____

Name: _____ Site: _____ File: _____

Name: _____ Site: _____ File: _____

ECO. RES.:
(Proposed)

Name: N/A Site: _____ File: _____

Name: _____ Site: _____ File: _____

Name: _____ Site: _____ File: _____

ENCUMBRANCES

P.U.P.(S): #, PURPOSE (only those P.U.P.s granting an interest in land)

#881 - Moyie Sail Club - maintenance of a signal mast

MINERAL CLAIMS:

WATER RIGHTS:

N/A

PERMITS/LEASES:

N/A

FORESHORE LEASES:

O.I.C. #159/83 - foreshore addition to park

AIR NAVIGATION ORDERS:

N/A

FOREST TENURE(S):

N/A

TRAPPING:

N/A

GUIDING/OUTFITTING:

N/A

RIGHTS-OF-WAY:

That Part of Promenade fronting lots 3 to 12 Blk 1, Plan 1514 -
in Park.

That Part of Road backing lots 3 to 12 Blk 1, Plan 1514 - in Park.

Green Bay Road #80 - R.S. 1647 Gaz. July 29/26 - not in Park.

Beach Road #228 - R.S. 1647 Gaz. July 29/26 - in Park.

INHOLDINGS:

Lots 13, 14, 15 & 16, Block 1, Plan 1514, D.L.'s 2799 and 2800 K.D.

MISCELLANEOUS:

No permit under the 'Navigable Water Act' for break-water.

GREEN FILE REVISIONS

PARK NAME: _____ FILE #: _____

The following revisions have been made to the original Green File:-

[illegible]

HISTORY OF THE ESTABLISHMENT OF MOYIE LAKE PARK

- March 25, 1959 - Acquisition of portions of Lots 2799 and 2800 south of the C.P.R. right-of-way from Mr. D.E. Shunter for \$20,000.
O.I.C. #622/59.
- July 7, 1959 - Portion of Lots 2799 and 2800 south of C.P.R. right-of-way and to limits on Green Bay Road right-of-way, save and except Lots 1,2,13,14,15,16,17,18,19&20 Block 1, Plan 1514.
O.I.C. 1574/59.
- Nov. 29, 1973 - Acquisition of that part of Lot 1 lying south of the C.P.R. right-of-way, District Lot 2800, Plan 8124 from Mr. & Mrs. D.E. Shunter for \$20,000.
O.I.C. #3937/73.
- Jan. 27, 1983 - Re-establishment of park by the cancellation of O.I.C. #1574/59 and re-describing the park with the addition of property dedicated as 'Promenade' and 'Road' on Plan 1514 and 21 hectares of foreshore.
O.I.C. #159/83.



Province of
British Columbia

Ministry of
Environment and Parks
PARKS AND OUTDOOR
RECREATION DIVISION
VICTORIA, B.C.

MEMORANDUM

To: Green File Holder
Southern Region
Interur

Date: 88-09-14

File: 2-3-2-12-70



RE: Revision to Green File for
MOYIE LAKE Park/Recreation Area

Enclosed are revisions to the Green File for
the above noted site(s).

Please Replace/Add:

 X the Park Status Sheet page(s)
 X with the enclosed;
 the Key Map with the enclosed map.

R.J. Ferguson
Land Administration
Resource Services Section

cc: East Kootenay District

Enclosure

RJF/ sd

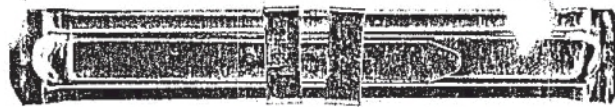

PARK STATUS SHEET

PARK NAME:	<u>Moyie Lake</u>	Zone	<u>BDA</u>
		FILE NUMBER:	<u>2-3-2-12-70</u>
CLASSIFICATION:	<u>A</u>	CATEGORY #:	<u></u>
SIZE:	<u>90 ha (69 ha upland 21 ha</u>	N.T.S. MAP #:	<u>82 G/5</u>
	<u>foreshore)</u>	STATUTE PARK:	<u>N/A</u>
ESTABLISHED:	<u>July 7, 1959</u>	DONATION:	<u>N/A</u>
PURCHASE:	<u>yes</u>		
LOCATION:	<u>19 km south of Cranbrook</u>		

ADMINISTRATIVE DIVISION

PARK REGION:	<u>Kootenay</u>	PARK DIST:	<u>East Kootenay</u>
REGIONAL DIST.:	<u>East Kootenay</u>	ELECTORAL DIST.:	<u>Kootenay</u>
LAND DIST.:	<u>Kootenay</u>	ASSESSMENT DIST.:	<u>#22 Cranbrook</u>
ISLANDS TRUST:	<u>N/A</u>	SCHOOL DIST.:	<u>#2</u>
MINES DIST.:	<u>Fort Steele</u>	L.T.O.:	<u>Nelson</u>
F/W MGMT. UNIT:	<u>4-5</u>	DIST. FORESTER:	<u>Nelson</u>
HWY. REGION:	<u>Nelson</u>	HWY. DIST.:	<u>Cranbrook</u>

ORDERS-IN-COUNCIL

O.I.C. # - PURPOSE

622/59 - Miscellaneous

1574/59 - Establishment

3937/73 - Miscellaneous

159/83 - Miscellaneous

1515/87 - Miscellaneous

O.I.C. # - PURPOSE

ENCUMBRANCES

P.U.P.(S): #, PURPOSE (only those P.U.P.s granting an interest in land)

#881 - Moyie Sail Club - maintenance of a signal mast

MINERAL CLAIMS:

O.I.C. 1515/87, area designated a mineral and placer mining reserve.

WATER RIGHTS:

N/A

PERMITS/LEASES:

N/A

FORESHORE LEASES:

O.I.C. #159/83 - foreshore addition to park

88 09 12

2-3-2-12

HISTORY OF THE ESTABLISHMENT OF MOYIE LAKE PARK

- March 25, 1959 - Acquisition of portions of Lots 2799 and 2800 south of the C.P.R right-of-way from Mr. D.E. Shunter for \$20,000.
O.I.C. #622/59
- July 7, 1959 - Portion of Lots 2799 and 2800 of C.P.R. right-of-way and to limits on Green Bay Road right-of-way, save and except Lots 1, 2, 13, 14, 15, 16, 17, 18, 19, & 20 Block 1, Plan 1514.
O.I.C. #1574/59
- Nov. 29, 1973 - Acquisition of that part of Lot 1 lying south of the C.P.R. right-of-way, District Lot 2800, Plan 8124 from Mr. and Mrs. D.E. Shunter for \$20,000.
O.I.C. #3937/73
- Jan. 27, 1983 - Re-establishment of park by the cancellation of O.I.C. #1574/59 and re-describing the park with the addition of property dedicated as 'Promenade' and 'Road' on Plan 1514 and 21 hectares of foreshore.
O.I.C. #159/83
- July 29, 1987 - Establishment of a mineral reserve and a placer mining reserve in D.L. 2800 and the south east portion of D.L. 2799.
O.I.C. #1515/87

BRITISH



COLUMBIA

1515

APPROVED AND ORDERED JUL 29 1987

Lieutenant Governor

EXECUTIVE COUNCIL CHAMBERS, VICTORIA JUL 29 1987

On the recommendation of the undersigned, the Lieutenant Governor, by and with the advice and consent of the Executive Council, orders that

1. The lands described in the Schedule are established as a mineral reserve and as a placer mining reserve.
2. No free miner shall stake or acquire a location or record or locate a mineral claim in the reserve created by Section 1.

Minister of Energy, Mines and Petroleum Resources.

MINISTRY OF ENERGY, MINES
AND PETROLEUM RESOURCES

AUG 24 1987

GENERAL FILES UNIT

Presiding Member of the Executive Council.

AREA	NUMBER	DATE	FILE
MINES	100		
	101		
CS.	102		
FILE			
VICT	103		
	104		

DEPOSITED

SCHEDULE

AREA 1

Slocan Mining Division, Kootenay Land District,
Okanagan North Electoral District:

All that parcel or tract of land together with all that foreshore or land covered by water situated in Kootenay Land District and more particularly shown outlined in red on the attached sketch.

AREA 2

Fort Steele Mining Division, Kootenay Land District,
Kootenay Electoral District:

All that parcel or tract of land together with all that foreshore or land covered by water situated in Kootenay Land District and more particularly shown outlined in red on the attached sketch.

AREA 3

Revelstoke Mining Division, Kootenay Land District,
Shuswap-Revelstoke Electoral District:

All that parcel or tract of land together with all that foreshore or land covered by water situated in Kootenay Land District and more particularly shown outlined in red on the attached sketch.

AREA 4

Alberni Mining Division, Clayoquot Land District,
Alberni Electoral District:

All that parcel or tract of land together with all that foreshore or land covered by water situated in Clayoquot Land District and more particularly shown outlined in red on the attached sketch.

AREA 5

New Westminster Mining Division, Yale Division of
Yale Land District, Yale-Lillooet Electoral District:



Province of British Columbia
Ministry of Energy, Mines and Petroleum Resources
MINERAL RESOURCES BRANCH-TITLES DIVISION

Area 2 Moyie River Recreational Panning Reserve

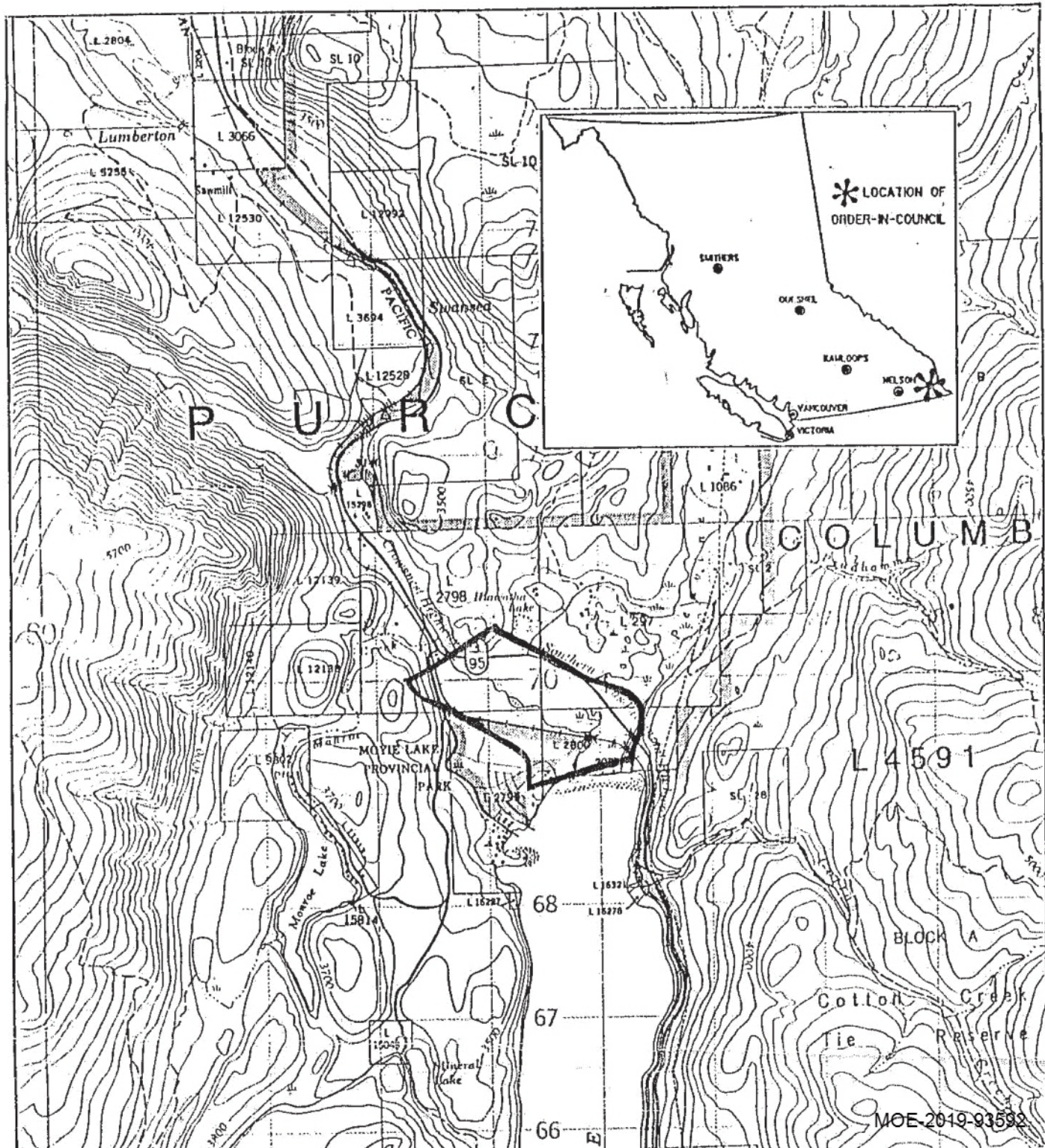

(2)

AREA 6

Lillooet Mining Division, Lillooet Land District,
Yale-Lillooet Electoral District:

Commencing at the point of intersection of the northerly boundary of District Lot 7576 with the present natural boundary of Fraser River on the right bank thereof; thence 100 metres westerly along the northerly boundary of said Lot 7576; thence in a southwesterly direction on a line parallel to and perpendicularly distant 100 metres from the said natural boundary of Fraser and Seton Rivers to the point of intersection with the southerly boundary of District Lot 7576; thence southeasterly along the southerly boundary of said Lot 7576 and its southeasterly prolongation to the point of intersection with the middle line of Seton River; thence northeasterly along the middle line of Seton River and its northeasterly prolongation thereof to the point of intersection with the middle line of Fraser River; thence northerly along the middle line of Fraser River to the point of intersection with the easterly prolongation of the northerly boundary of District Lot 7576; thence westerly along the easterly prolongation of said Lot 7576 to the point of intersection with the present natural boundary of Fraser River on the right bank thereof, being the point of commencement situated in the Lillooet Land District.

AREA 7

Atlin Mining Division, Cassiar Land District, Atlin Electoral District:

All that parcel or tract of land together with all that foreshore or land covered by water situated in Cassiar Land District and more particularly shown outlined in red on the attached sketch.

BRITISH



COLUMBIA

159

APPROVED AND ORDERED JAN 26. 1983

Lieutenant-Governor

EXECUTIVE COUNCIL CHAMBERS, VICTORIA JAN 27. 1983

On the recommendation of the undersigned, the Lieutenant-Governor, by and with the advice and consent of the Executive Council, orders that

Moyie Lake Park, established by Order-in-Council 1574 of 1959, is cancelled and the Crown land described in the schedule is re-established as a Class "A" Provincial Park and the name is declared to be Moyie Lake Park.

Minister of Lands, Parks and Housing

Copies to: B. Keal
BC Assessment Authority
R. Ferguson
E. Gray

FEB 3 1982

Presiding Member of the Executive Council

Schedule

All Crown land within Kootenay Land District described as:

- First: Those parts of District Lots 2799 and 2800 as shown on Reference Plan 49537D.
- Second: Lots 3 to 12 inclusive of Block 1 of DL 2799, Plan 1514.
- Third: Those parts of DL 2799 and 2800 dedicated as Promenade on Plan 1514, except that part described lying south of the southeasterly prolongation of the north boundary of Lot 2 of Blk 1, Plan 1514 and except that part lying north of the southeasterly prolongation of the south boundary of Lot 13 of Blk 1 of Plan 1514.
- Fourth: That part of DL 2799 dedicated as road on Plan 1514 and lying south of the northwesterly prolongation of the south boundary of Lot 13 of Blk 1, Plan 1514 and lying north of the northwesterly prolongation of the north boundary of Lot 2 of Blk 1, Plan 1514.
- Fifth: Those parts of Lot 1 of DL 2800, Plan 8124 lying south of C.P.R. right-of-way, Plan 524-U-1.
- Sixth: The unsurveyed land described as commencing at the point of intersection of the southeasterly prolongation of the south boundary of Lot 13 of DL 2799, Plan 1514 and the east boundary of the promenade shown on Plan 1514;
thence Southeast along the said prolongation to the natural boundary of Moyie Lake;
thence in a general North direction along the said natural boundary to the point of intersection with the southeasterly prolongation of the northeasterly boundary of Lot 3 of DL 2800, Plan 5247;
thence Northwest along the said Lot 3 boundary prolongation to the point of intersection with the east boundary of said promenade;
thence in a general South direction along the said promenade east boundary to the point of commencement.
- Seventh: Those parts of the beds of Moyie River and Peavine Creek adjacent to DL 2800 and lying south of the C.P.R. right-of-way, Plan 524-U-1.
- Eighth: Commencing at the point of intersection of the south boundary of DL 2800, said boundary also being the natural boundary of Moyie Lake, and the west boundary of C.P.R. right-of-way Plan 524-U-1;
thence due South 200 metres;
thence in a general westerly and Southwesterly direction along a line parallel to and perpendicularly distant 200 metres from the elevation of the natural boundary of Moyie Lake to the point of intersection with the southeasterly prolongation of the Northerly boundary of Lot 2 of Blk 1 of DL 2799, Plan 1514;
thence Northwest along the said prolongation to the said natural boundary;
thence in a general Northerly direction along said natural boundary to the point of commencement.

The whole containing 90 hectares, more or less (69 hectares, more or less, of upland and 21 hectares, more or less of foreshore).



159

APPROVED AND ORDERED JAN 26, 1983

Lieutenant-Governor

EXECUTIVE COUNCIL CHAMBERS, VICTORIA JAN 27, 1983

On the recommendation of the undersigned, the Lieutenant-Governor, by and with the advice and consent of the Executive Council, orders that

Moyie Lake Park, established by Order-in-Council 1574 of 1959, is cancelled and the Crown land described in the schedule is re-established as a Class "A" Provincial Park and the name is declared to be Moyie Lake Park.

Minister of Lands, Parks and Housing

Copies to: B. Keal
BC Assessment Authority
R. Ferguson
E. Gray

FEB 3 1982

Presiding Member of the Executive Council

File: 2-3-2-12 (This part is for administrative purposes and is not part of the Order.)

Authority under which Order is made:

Act and section Park Act, Section 7, 5(1)

Other (specify) OIC 1574/59

Statutory authority checked by

R. J. CHAMBERLAIN

(Signature and typed or printed name of Legal Officer)

2/1/82

Schedule

All Crown land within Kootenay Land District described as:

- First: Those parts of District Lots 2799 and 2800 as shown on Reference Plan 49537D.
- Second: Lots 3 to 12 inclusive of Block 1 of DL 2799, Plan 1514.
- Third: Those parts of DL 2799 and 2800 dedicated as Promenade on Plan 1514, except that part described lying south of the southeasterly prolongation of the north boundary of Lot 2 of Blk 1, Plan 1514 and except that part lying north of the southeasterly prolongation of the south boundary of Lot 13 of Blk 1 of Plan 1514.
- Fourth: That part of DL 2799 dedicated as road on Plan 1514 and lying south of the northwesterly prolongation of the south boundary of Lot 13 of Blk 1, Plan 1514 and lying north of the northwesterly prolongation of the north boundary of Lot 2 of Blk 1, Plan 1514.
- Fifth: Those parts of Lot 1 of DL 2800, Plan 8124 lying south of C.P.R. right-of-way, Plan 524-U-1.
- Sixth: The unsurveyed land described as commencing at the point of intersection of the southeasterly prolongation of the south boundary of Lot 13 of DL 2799, Plan 1514 and the east boundary of the promenade shown on Plan 1514;
thence Southeast along the said prolongation to the natural boundary of Moyie Lake;
thence in a general North direction along the said natural boundary to the point of intersection with the southeasterly prolongation of the northeasterly boundary of Lot 3 of DL 2800, Plan 5247;
thence Northwest along the said Lot 3 boundary prolongation to the point of intersection with the east boundary of said promenade;
thence in a general South direction along the said promenade east boundary to the point of commencement.
- Seventh: Those parts of the beds of Moyie River and Peavine Creek adjacent to DL 2800 and lying south of the C.P.R. right-of-way, Plan 524-U-1.
- Eighth: Commencing at the point of intersection of the south boundary of DL 2800, said boundary also being the natural boundary of Moyie Lake, and the west boundary of C.P.R. right-of-way Plan 524-U-1;
thence due South 200 metres;
thence in a general westerly and Southwesterly direction along a line parallel to and perpendicularly distant 200 metres from the elevation of the natural boundary of Moyie Lake to the point of intersection with the southeasterly prolongation of the Northerly boundary of Lot 2 of Blk 1 of DL 2799, Plan 1514;
thence Northwest along the said prolongation to the said natural boundary;
thence in a general Northerly direction along said natural boundary to the point of commencement.

The whole containing 90 hectares, more or less (69 hectares, more or less, of upland and 21 hectares, more or less of foreshore).



1515

APPROVED AND ORDERED JUL 29 1987

Lieutenant Governor

EXECUTIVE COUNCIL CHAMBERS, VICTORIA JUL 29.1987

On the recommendation of the undersigned, the Lieutenant Governor, by and with the advice and consent of the Executive Council, orders that

1. The lands described in the Schedule are established as a mineral reserve and as a placer mining reserve.
2. No free miner shall stake or acquire a location or record or locate a mineral claim in the reserve created by Section 1.

MINISTRY OF ENERGY, MINES
AND PETROLEUM RESOURCES

JUN 21 1997

2000-2001 1116, 17^e 12.11

Minister of Energy, Mines and Petroleum Resources.

Presiding Member of the Executive Council.

DEPOSITED
JUL 31 1987
RC REG. 265/87

MINERAL TITLES DRAUGHTING
VICTORIA, B.C.
PLOTTED ON MAP *Map of Victoria, B.C. 1910*
DATE *5-7-11* BY *A.E.*

AREA	DATE	TIME	BY
CS	10/1		
FILE			
VRT	1/11		
	1/11		
MD	1/11	1/11	
WAVE	1/11		
AE			

3280-003-639 (This part is for the records of the Office of Legislative Counsel, and is not part of the Order.)

Authority under which Order is made:

Act and section.....Mineral Act S.8, Mining (Placer) Act S.13.

Other (specify) _____

Examined by

MOE-2019-93592, 26 of 29

SCHEDULE

AREA 1

Slocan Mining Division, Kootenay Land District,
Okanagan North Electoral District:

All that parcel or tract of land together with all that foreshore or land covered by water situated in Kootenay Land District and more particularly shown outlined in red on the attached sketch.

AREA 2

Fort Steele Mining Division, Kootenay Land District,
Kootenay Electoral District:

All that parcel or tract of land together with all that foreshore or land covered by water situated in Kootenay Land District and more particularly shown outlined in red on the attached sketch.

AREA 3

Revelstoke Mining Division, Kootenay Land District,
Shuswap-Revelstoke Electoral District:

All that parcel or tract of land together with all that foreshore or land covered by water situated in Kootenay Land District and more particularly shown outlined in red on the attached sketch.

AREA 4

Alberni Mining Division, Clayoquot Land District,
Alberni Electoral District:

All that parcel or tract of land together with all that foreshore or land covered by water situated in Clayoquot Land District and more particularly shown outlined in red on the attached sketch.

AREA 5

New Westminster Mining Division, Yale Division of
Yale Land District, Yale-Lillooet Electoral District:

All that portion of Fraser River between the present natural boundary on the left bank thereof and the middle line of the said Fraser River from the point of intersection of the northwesterly prolongation of the middle line of Coquihalla River with the middle line of Fraser River southerly 2000 metres along the said middle line of Fraser River to a line perpendicular to the middle line of Fraser River.

(2)

AREA 6

Lillooet Mining Division, Lillooet Land District,
Yale-Lillooet Electoral District:

Commencing at the point of intersection of the northerly boundary of District Lot 7576 with the present natural boundary of Fraser River on the right bank thereof; thence 100 metres westerly along the northerly boundary of said Lot 7576; thence in a southwesterly direction on a line parallel to and perpendicularly distant 100 metres from the said natural boundary of Fraser and Seton Rivers to the point of intersection with the southerly boundary of District Lot 7576; thence southeasterly along the southerly boundary of said Lot 7576 and its southeasterly prolongation to the point of intersection with the middle line of Seton River; thence northeasterly along the middle line of Seton River and its northeasterly prolongation thereof to the point of intersection with the middle line of Fraser River; thence northerly along the middle line of Fraser River to the point of intersection with the easterly prolongation of the northerly boundary of District Lot 7576; thence westerly along the easterly prolongation of said Lot 7576 to the point of intersection with the present natural boundary of Fraser River on the right bank thereof, being the point of commencement situated in the Lillooet Land District.

AREA 7

Atlin Mining Division, Cassiar Land District, Atlin Electoral District:

All that parcel or tract of land together with all that foreshore or land covered by water situated in Cassiar Land District and more particularly shown outlined in red on the attached sketch.



Province of British Columbia
Ministry of Energy, Mines and Petroleum Resources
MINERAL RESOURCES BRANCH-TITLES DIVISION

Area 2 Moyie River Recreational Panning Reserve

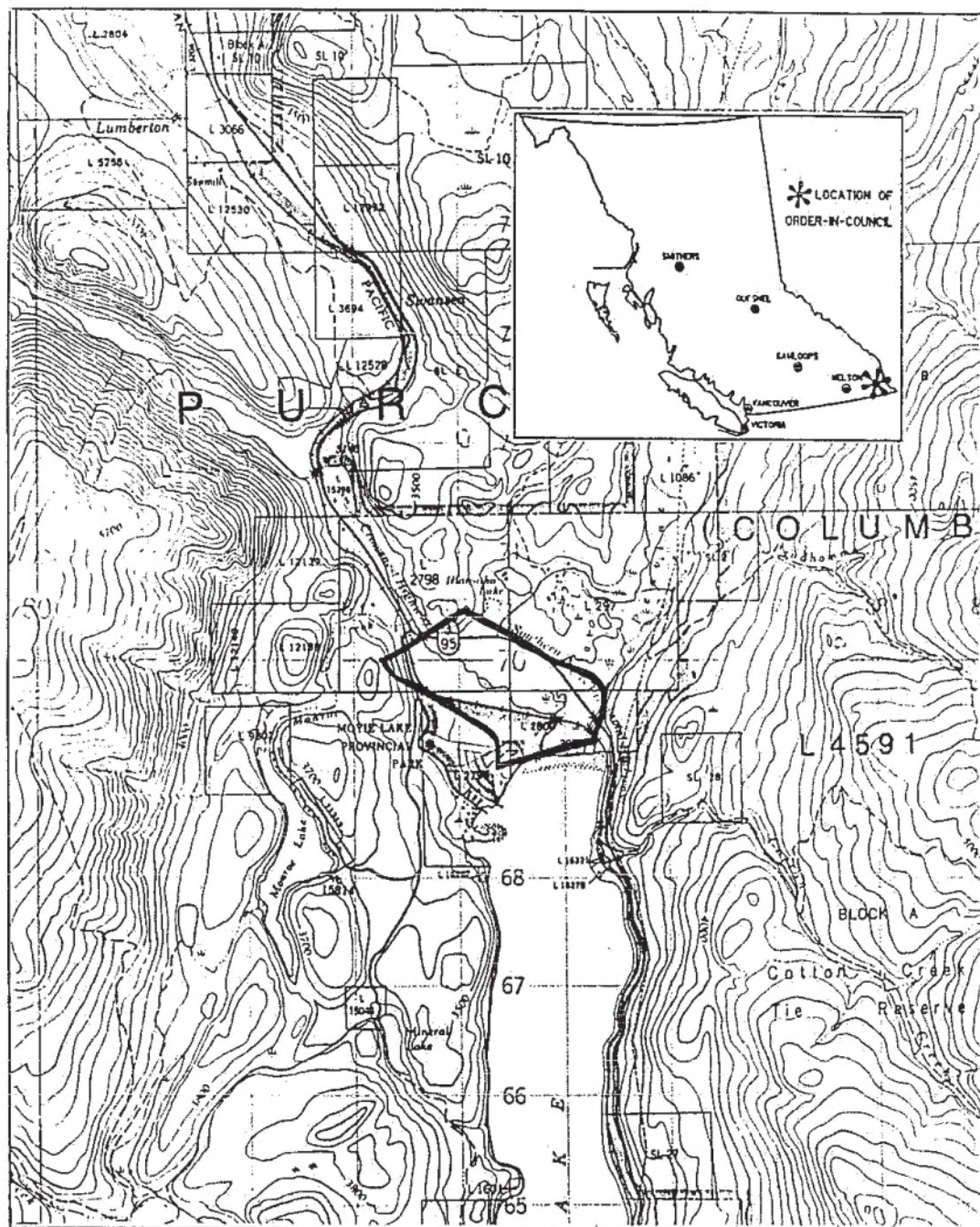

SCALE- 1:50 000

CONTOUR INTERVAL-100ft.

MINING DIVISION FORT STEELE	SKETCH PREPARED BY WR
LAND DISTRICT KOOTENAY	MINERAL TITLES DRAUGHTING, VICTORIA B.C.
MAP NO. 826/5W	DATE 86.05.20.